

danawano 11/11/2022 9:52:44 AM - c:\transystems\paw\local\transystems\paw\danawano\0675143-CDW-C01-204.dgn

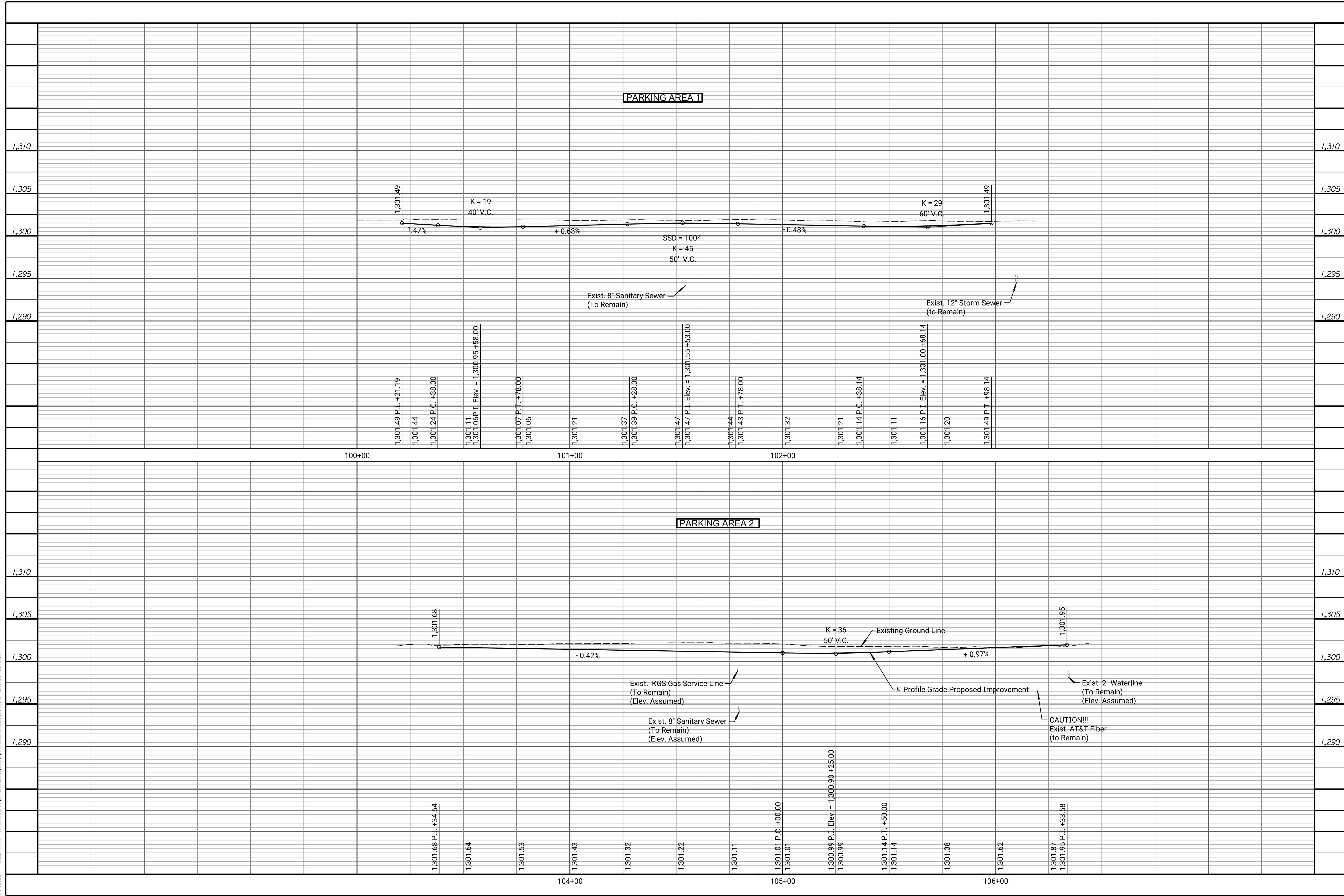

Tran Systems

245 NORTH WACO
SUITE 222
WICHITA, KANSAS 67202
PHONE: 316-303-3000
FAX: 316-462-5629

CONSULTANTS:

LK ARCHITECTURE, INC.
345 RIVERVIEW
SUITE 200
WICHITA, KANSAS 67208
PHONE: 316-268-0230

DELANO GREENWAY IMPROVEMENTS
FROM EXPOSITION TO OSAGE

WICHITA, KANSAS

CITY OF
WICHITA

| REVISIONS: | MARK | DATE | DESCRIPTION |
|------------|------|------|-------------|
| | | | |
| | | | |
| | | | |
| | | | |
| | | | |
| | | | |
| | | | |
| | | | |
| | | | |
| | | | |

PROJ NO: 472-85462

SCALE: 1"=20'

DATE: 11/11/2022

DESIGNED BY: MCG

DRAWN BY: DJB

CHECKED BY: MDB

SHEET TITLE:

**DELANO GREENWAY
PARKING AREA
PROFILES**

SHEET NO.

16

SHEET 16 OF 96

IF THIS DRAWING IS LESS THAN 22" X 36" IT IS A REDUCED SIZE DRAWING