

GENERAL

1. THE CONTRACTOR IS SPECIFICALLY CAUTIONED THAT THE LOCATIONS AND/OR ELEVATIONS OF EXISTING UTILITIES AS SHOWN ON THESE PLANS IS BASED ON RECORDS OF THE VARIOUS UTILITY COMPANIES AND, WHERE POSSIBLE, MEASUREMENTS TAKEN IN THE FIELD. THE INFORMATION IS NOT BE RELIED ON AS BEING EXACT OR COMPLETE. THE CONTRACTOR MUST CALL THE APPROPRIATE UTILITY COMPANY TO REQUEST EXACT FIELD LOCATION OF UTILITIES. IT SHALL BE THE RESPONSIBILITY OF THE CONTRACTOR TO RELOCATE ALL EXISTING UTILITIES WHICH CONFLICT WITH THE PROPOSED IMPROVEMENTS SHOWN ON THE PLANS.
2. LANDSCAPE CONTRACTOR SHALL PROVIDE LABOR, MATERIALS AND SERVICE NECESSARY TO FURNISH AND INSTALL MATERIALS AS SPECIFIED HEREIN AND AS SHOWN ON THE PLANS.
3. THE CONTRACTOR SHALL REFER TO CITY SPECIFICATIONS FOR ADDITIONAL REQUIREMENTS AND RELATED TO PLANTING AND LANDSCAPING. THE CONTRACTOR WILL BE EXPECTED TO FOLLOW ALL THE REQUIREMENTS CALLED FOR IN THE STANDARD CITY OF WICHITA SPECIFICATIONS. ANY DISCREPANCIES BETWEEN THE DRAWINGS AND SPECIFICATIONS SHALL BE BROUGHT TO THE ATTENTION OF THE LANDSCAPE ARCHITECT.
4. QUANTITIES OF MATERIALS SHOWN ON THE PLANTING PLAN TAKE PRECEDENCE OVER QUANTITIES SHOWN ON THE PLANT MATERIAL SCHEDULE. LANDSCAPE CONTRACTOR SHALL BE RESPONSIBLE FOR VERIFYING ALL QUANTITIES SHOWN ON THESE PLANS BEFORE PRICING THE WORK.
5. REPORT DISCREPANCIES IN THE PLANTING PLAN PRIOR TO PURCHASE OF MATERIALS OR STARTING CONSTRUCTION.
6. NO WRITTEN SUBSTITUTIONS SHALL BE MADE WITHOUT LANDSCAPE ARCHITECT'S WRITTEN APPROVAL. ALTERNATE MATERIALS OF SIMILAR SIZE AND CHARACTER MAY BE CONSIDERED IF SPECIFIED PLANT MATERIALS CANNOT BE OBTAINED. ARCHITECT RESERVES THE RIGHT TO REVISE PLANT LIST AS DEEMED NECESSARY.
7. PLANT SUBSTITUTIONS WILL ONLY BE ALLOWED UNDER THE FOLLOWING CONDITIONS: LANDSCAPE CONTRACTOR SHALL SUBMIT A WRITTEN SUBSTITUTION REQUEST TO THE ARCHITECT STATING WHAT PLANTS TO BE SUBSTITUTED AND THE REQUESTED SUBSTITUTION PLANT ALONG WITH EXPLANATION OF SUBSTITUTION REQUEST. NO SUBSTITUTION SHALL CONSTITUTE AN INCREASE IN COST FROM THE ORIGINAL CONTRACT AMOUNT. ANY PLANT SUBSTITUTIONS NOT APPROVED SHALL BE REPLACED BY THE LANDSCAPE CONTRACTOR AT THE TIME OF INSPECTION.
8. ALL MATERIALS ARE SUBJECT TO THE APPROVAL OF THE LANDSCAPE ARCHITECT BEFORE, DURING AND AFTER INSTALLATION.
9. PRIOR TO CONSTRUCTION, THE CONTRACTOR SHALL BE RESPONSIBLE FOR LOCATING ALL UNDERGROUND UTILITIES AND SHALL AVOID DAMAGE TO ALL UTILITIES DURING THE COURSE OF WORK. LOCATIONS OF EXISTING BURIED UTILITY LINES SHOWN ON THE PLANS ARE BASED UPON THE BEST AVAILABLE INFORMATION AND ARE TO BE CONSIDERED APPROXIMATE. IT SHALL BE THE RESPONSIBILITY OF THE CONTRACTOR 1) TO VERIFY THE LOCATIONS OF UTILITY LINES ADJACENT TO THE WORK AREA 2) TO PROTECT ALL UTILITY LINES DURING THE CONSTRUCTION PERIOD 3) TO REPAIR ANY AND ALL DAMAGE TO UTILITIES, STRUCTURES, SITE APPURTENANCES, ETC. WHICH OCCUR AS A RESULT OF CONSTRUCTION.

PLANTING PREPARATION

10. ALL TURF AREAS SHALL RECEIVE A MINIMUM OF 4" OF TOPSOIL. TOPSOIL SHALL BE A FRIABLE LOAM WITH GOOD STRUCTURE. SOLUBLE SALTS SHALL NOT EXCEED 500ppm AND ORGANIC MATTER SHALL BE NO LESS THAN 3%. The pH SHALL RANGE BETWEEN 5.5 AND 7.4.
11. THE LANDSCAPE CONTRACTOR SHALL HAVE TOPSOIL TESTED BY A CERTIFIED TESTING LABORATORY AND OBTAIN RECOMMENDATIONS FOR SOIL AMENDMENT TYPE(S) AND QUANTITIES. RECOMMENDATIONS SHALL BE SPECIFIC TO THE TOPSOIL OF THIS REPORT TO THE ARCHITECT FOR THEIR RECORDS. THE LANDSCAPE CONTRACTOR SHALL BE EXPECTED TO AMEND SOILS PER THE RECOMMENDATIONS AND SPECIFICATIONS.
15. BACKFILL: FOR PLANT EXCAVATIONS TO BE CLEAN NATURAL TOPSOIL MIXED WITH AMENDMENTS AT THE RATIOS SPECIFIED BY A CERTIFIED TOPSOIL ANALYSIS.

PLANTING MATERIALS

16. ALL PLANT MATERIAL SHALL BE WELL-FORMED AND DEVELOPED IN GOOD CONDITION, HEALTHY, VIGOROUS AND FREE OF PESTS AND DISEASE.
17. PLANTS SHALL COMPLY IN ALL APPLICABLE RESPECTS WITH ACCEPTABLE STANDARDS AS SET FORTH IN THE AMERICAN ASSOCIATION OF NURSESMAN'S "AMERICAN STANDARD OF NURSERY STOCK." THESE STANDARDS SHALL REPRESENT THE GUIDELINE SPECIFICATIONS ONLY AND SHALL CONSTITUTE THE MINIMUM QUALITY REQUIREMENTS FOR PLANT MATERIALS.
18. ALL TREES SHALL HAVE STRAIGHT TRUNKS (FOR SINGLE STEM SPECIES) AND FULL CROWN AND MEET ALL REQUIREMENTS SPECIFIED. ALL TREES MUST BE GUYED OR STAKED AS SHOWN IN THE DETAILS.
19. PLANT LOCATIONS AND QUANTITIES SHOWN ARE APPROXIMATE. ADJUST PLANT LOCATIONS AS NECESSARY TO AVOID CONFLICTS. CONTRACTOR SHALL BE RESPONSIBLE FOR COMPLETE COVERAGE OF ALL PLANTING BEDS AT SPACING INDICATED ON THE PLANS.
20. CONTRACTOR SHALL BE RESPONSIBLE FOR THE DELIVERY SCHEDULE AND PROTECTION BETWEEN DELIVERY AND PLANTING PER SPECIFICATIONS TO MAINTAIN HEALTHY PLANT CONDITIONS.
21. PLANT MATERIALS SHALL BE PROTECTED FROM THE DRYING ACTION OF THE SUN AND WIND AFTER BEING DUG, WHILE BEING TRANSPORTED, AND WHILE AWAITING PLANTING. BALLS OF PLANTS WHICH CANNOT BE PLANTED IMMEDIATELY SHALL BE PROTECTED FROM DRYING ACTION BY COVERING THEM WITH MOIST MULCH. PERIODICALLY, APPLY WATER TO MULCH COVERED BALLS TO KEEP MOIST. IF PLANTING SHOULD OCCUR DURING GROWING SEASON, APPLY ANTI-DESSICANT TO LEAVES BEFORE TRANSPORT TO REDUCE LIKELIHOOD OF WINDBURN. REAPPLY ANTI-DESSICANT AFTER PLANTING PLANTING TO REDUCE TRANSPIRATION.
22. ALL PLANT MATERIAL SHALL BE CONTAINER GROWN OR BALLED AND BURLAPPED AS INDICATED IN THE PLANT SCHEDULE. PLANTS DESIGNATED CONTAINER GROWN SHALL HAVE BEEN GROWN IN POTS, CANS OR BOXES FOR FOR A MINIMUM OF SIX MONTHS AND A MAXIMUM OF TWO YEARS. THESE PLANTS SHALL BE REMOVED FROM CONTAINERS BEFORE PLANTING. PLANTS THAT APPEAR ROOT-BOUND SHALL BE REJECTED.
23. ANY PLANT MATERIAL WHICH IS DISEASED, DISTRESSED, DEAD, OR REJECTED (PRIOR TO SUBSTANTIAL COMPLETION) SHALL BE PROMPTLY REMOVED FROM THE SITE AND REPLACED WITH MATERIAL OF THE SAME SPECIES, QUANTITY AND SIZE AND MEETING ALL PLANT LIST SPECIFICATIONS.

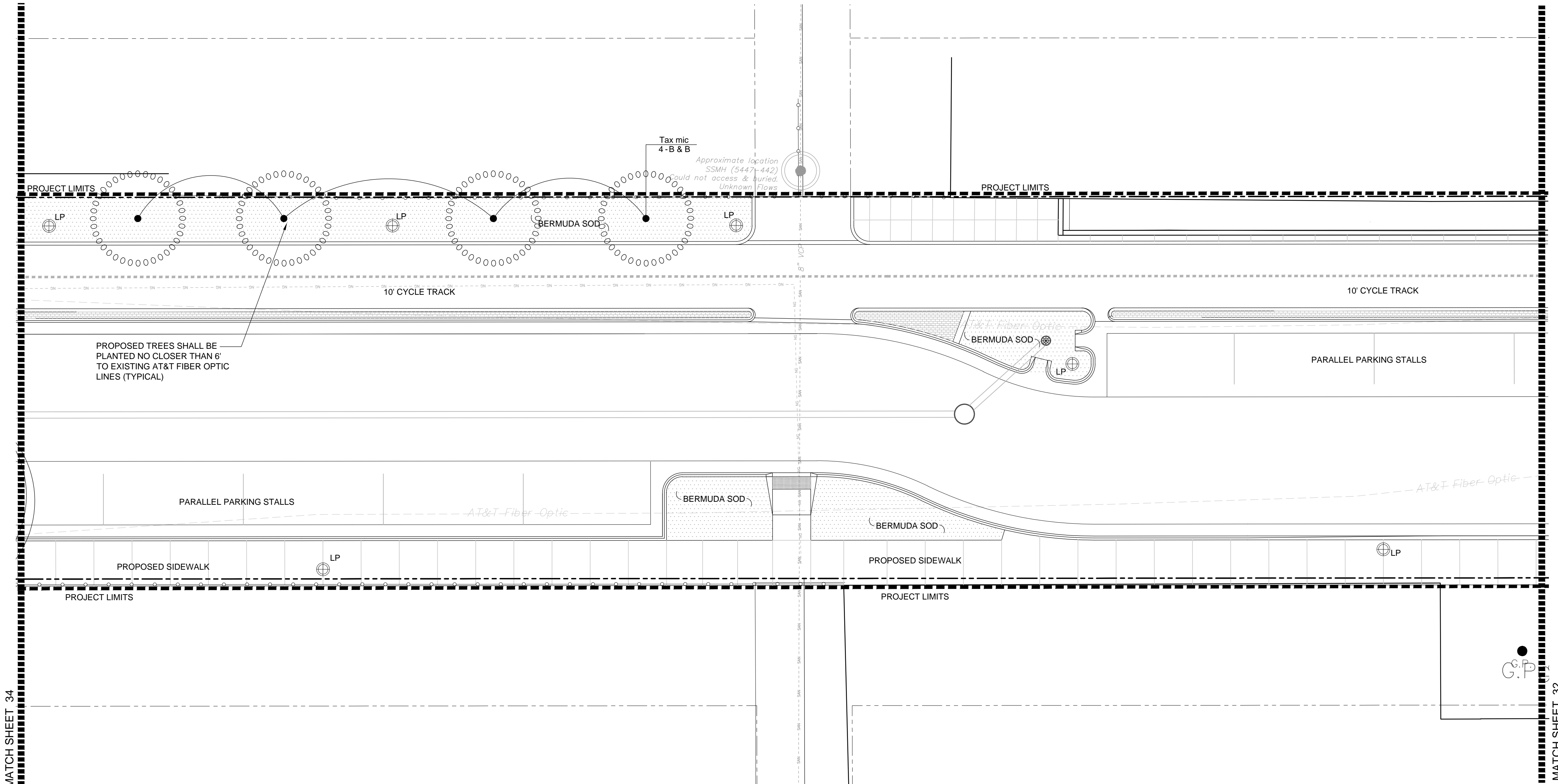

MATCH SHEET 34

MATCH SHEET 32

RELATED ITEMS

24. PLACE CYPRESS MULCH IN ALL TREE SAUCERS AS INDICATED IN THE TREE PLANTING DETAILS.
25. ALL TREES SHALL HAVE TREEGATOR IRRIGATION BAGS INSTALLED AS PART OF TREE INSTALLATION (OR APPROVED EQUIVALENT). THIS SHALL BE CONSIDERED SUBSIDIARY TO THE COST OF THE TREE.

INSPECTIONS/MAINTENANCE AND CLEAN-UP

26. THE CONTRACTOR SHALL BE RESPONSIBLE FOR FULLY MAINTAINING (INCLUDING BUT NOT LIMITED TO: WATERING, SPRAYING, MULCHING, FERTILIZING, ETC.) ALL OF THE PLANT MATERIALS AND LAWN UNTIL FINAL ACCEPTANCE.
27. THE CONTRACTOR SHALL COMPLETELY GUARANTEE ALL PLANT MATERIAL PER CITY OF WICHITA SPECIFICATIONS. THE CONTRACTOR SHALL PROMPTLY MAKE ALL REPLACEMENTS DURING THE NORMAL PLANTING SEASON.
28. REMOVE ALL RUBBISH, EQUIPMENT AND MATERIAL AND LEAVE THE AREA IN A NEAT, CLEAN CONDITION EACH DAY. MAINTAIN PAVED AREAS UTILIZED FOR HAULING EQUIPMENT AND MATERIALS BY OTHER TRADES IN A CLEAN AND UNOBSTRUCTED CONDITION AT ALL TIMES.
29. REMOVE SOIL OR DIRT THAT ACCUMULATED DURING OR AS A RESULT OF PLANTING OPERATIONS EACH DAY.
30. LIMIT AMOUNT OF PRUNING TO A MINIMUM NECESSARY TO REMOVE DEAD OR INJURED TWIGS AND BRANCHES. PRUNE IN SUCH A MANNER AS NOT TO CHANGE NATURAL HABIT OR SHAPE OF PLANT. MAKE CUTS FLUSH, LEAVING NO STUBS. CENTRAL LEADERS SHALL NOT BE REMOVED.
31. LANDSCAPE CONTRACTOR TO REMOVE TREE STAKES, GUYS, AND ALL DEAD WOOD ON TREES AND SHRUBS ONE YEAR AFTER PROVISIONAL ACCEPTANCE.

LANDSCAPE PLAN

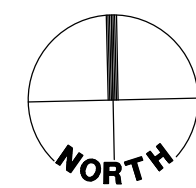

Tran Systems
 245 NORTH WACO
 SUITE 222
 WICHITA, KANSAS 67202
 PHONE: 316-303-3000
 FAX: 316-462-5629

CONSULTANTS:

 LK ARCHITECTURE, INC.
 345 RIVERVIEW
 SUITE 200
 WICHITA, KANSAS 67208
 PHONE: 316-268-0230

**DELANO GREENWAY IMPROVEMENTS
 FROM EXPOSITION TO OSAGE STREET**
 WICHITA, KANSAS

REVISIONS:	MARK	DATE	DESCRIPTION

PROJ NO: 472-85463
 SCALE: 1" = 10'-0"
 DATE: 09/30/2022
 DESIGNED BY: J. Best
 DRAWN BY: J. Best
 CHECKED BY: J. Best

SHEET TITLE:
LANDSCAPE PLAN

SHEET NO.
33
 SHEET 33 OF xshs x