

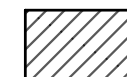

LEGEND

-  PHASE IA
-  PHASE IB
-  PHASE IC

Phase IA

Phase IA construction shall construct all improvements for the Delano Greenway between west of Exposition to west of Seneca Street, and East of Seneca Street to East of Osage Street. This phase may be done concurrently with Phases IB and IC. Major items of work include concrete pavement, storm sewer, curb & gutter, sidewalk construction, grading, sodding, pavement marking & signing, and streetscape aesthetics.

Phase IB

Phase IB construction shall construct all improvements at the Delano Greenway and Seneca Street intersection within the median and inside travel lanes. During this phase, the Contractor shall close the inside lanes on Seneca Street in each direction and shift all traffic to the outside lanes. Once all work in the area is complete, the Contractor shall fully open Seneca Street. Major items of work include concrete pavement, concrete pavers, curb & gutter, sodding, & traffic signal installation.

Phase IC

Phase IC construction shall construct all improvements at the Delano Greenway and Seneca Street intersection within the outside travel lane and curb & gutter. During this phase, the Contractor shall close the outside lanes on Seneca Street in each direction and shift all traffic to the inside lanes. Once all work in the area is complete, the Contractor shall fully open Seneca Street. Major items of work include concrete pavement, concrete pavers, curb & gutter, & traffic signal installation.

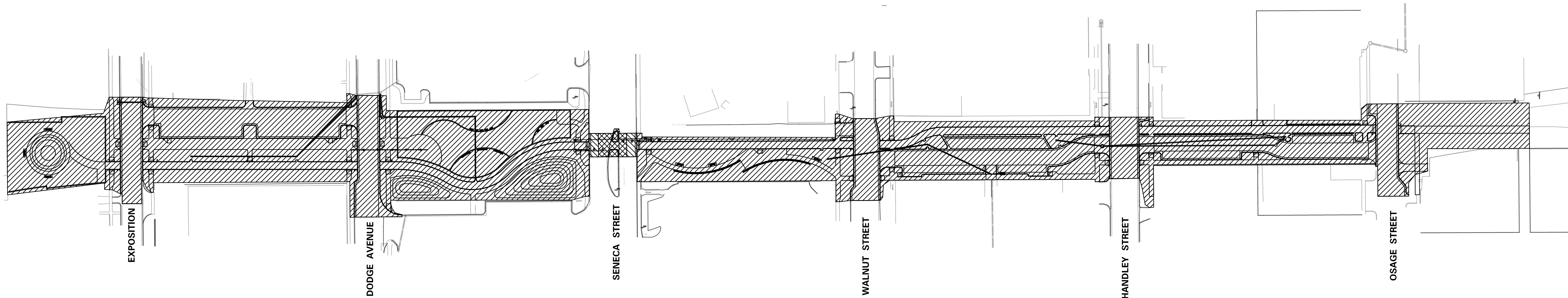
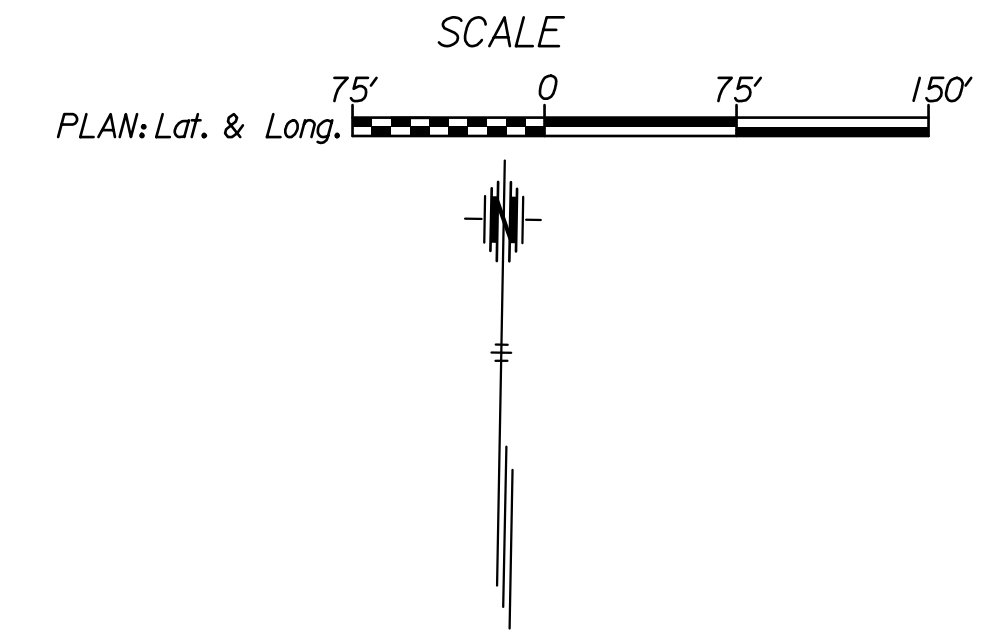

1. The construction phasing indicates major items of work and a general sequence of construction. It does not include all items of work. Certain situations may arise which preclude adhering to the original Construction Phasing. Should this occur, the Contractor may submit to the Engineer an alternate plan for approval.
2. All traffic control shall conform to the latest edition of the Manual of Uniform Traffic Control Devices (MUTCD).
3. Speed limit in the work zones shall remain the same prior to construction unless otherwise noted on the plans or at the discretion of the Engineer.
4. All existing signs in conflict with the traffic control or the final lane configuration shall be covered or removed and either reset or stored on site for retrieval by the Owner as directed by the Engineer. Existing signs necessary for traffic during construction shall be adjusted (and later reset), as necessary, as directed by the Engineer.
5. Pavement markings conflicting with the traffic control shall be either removed or covered with an approved removable tape during construction. Temporary pavement markings shall be Type I Temporary Pavement Marking Tape. The Contractor shall maintain all temporary pavement markings throughout their intended service life.
6. As work is complete, the Contractor shall install permanent signing and pavement markings as in the pavement marking and signing plans or as directed by the Engineer.
7. The Contractor is to build a temporary 3:1 slope along the centerline through the construction area at the end of each work day.
8. The Contractor shall keep Seneca open to two way traffic at all times. The Contractor may close sideroads other than Seneca Street as needed to complete the work necessary through the intersection. Local traffic access shall be maintained at all times during sideroad closures. All sideroad closures shall be approved by the Engineer prior to the closure. No two consecutive sideroads shall be closed at the same time. See Standard TE704 for Road Closure - Local Traffic Access details.
9. The Contractor will be required to provide access to property owners or occupants during construction. The Contractor shall provide seven (7) days advance notice to property owners and occupants before beginning improvements in the vicinity of their property.
10. The Contractor shall only close drives/entrances to businesses and residences during the time improvements are being made in the vicinity of the property.
11. The Contractor shall work with adjacent businesses and residents to maintain access as long as possible in advance of the work area and restore access as soon as possible after the construction is completed in the area.
12. The Contractor shall notify all property owners or business owners of any significant traffic changes during construction a minimum of seven (7) days in advance of traffic changing.

Tran Systems
 245 NORTH WACO
 SUITE 222
 WICHITA, KANSAS 67202
 PHONE: 316-303-3000
 FAX: 316-462-5629

CONSULTANTS:

 LK ARCHITECTURE, INC.
 345 RIVERVIEW
 SUITE 200
 WICHITA, KANSAS 67208
 PHONE: 316-268-0230

DELANO GREENWAY IMPROVEMENTS
 FROM EXPOSITION TO OSAGE
 WICHITA, KANSAS

REVISIONS:	DESCRIPTION	MARK	DATE

PROJ NO: 472-85462
 SCALE: 1"=75'
 DATE: 11/1/2022
 DESIGNED BY: MCG
 DRAWN BY: MCG
 CHECKED BY: MDB

SHEET TITLE:
CONSTRUCTION PHASING OVERVIEW

SHEET NO.
68