

LEGEND



Proposed Sign



Existing Sign (To Be Removed)

Single Post Sign

Double Post Sign

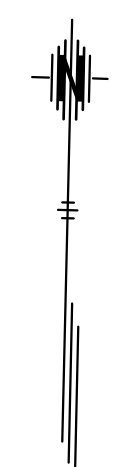

URBAN:

1. Ground-mounted signs shall be mounted at a minimum height of 7' measured from the bottom of sign to the top edge of the curb.
2. Permanent sign supports should not be located on sidewalks or areas designated for pedestrian or bicycle traffic.
3. The height from bottom of the secondary sign mounted below another sign may be 6' measured from the bottom of sign to the near edge of the pavement. Signs shall not overlap each other. Signs mounted lower than 7' should not project more than 4" into pedestrian facilities.

ADJUSTMENTS:

Signs may be moved laterally or longitudinally if it will improve the visibility of the sign or other signs and if it will protect the sign more.

For additional details on mounting location and height, See Sheet B1

*If the edge of a sign placed adjacent to the 10' sidewalk is at least 2'-0" from the edge of the sidewalk then the bottom of the sign may be placed 7'-0" higher than the edge of the sidewalk. If the edge of a sign placed adjacent to the 10' sidewalk is less than 2'-0" from the edge of the sidewalk then the bottom of the sign must be a minimum of 8'-6" higher than the edge of the sidewalk.

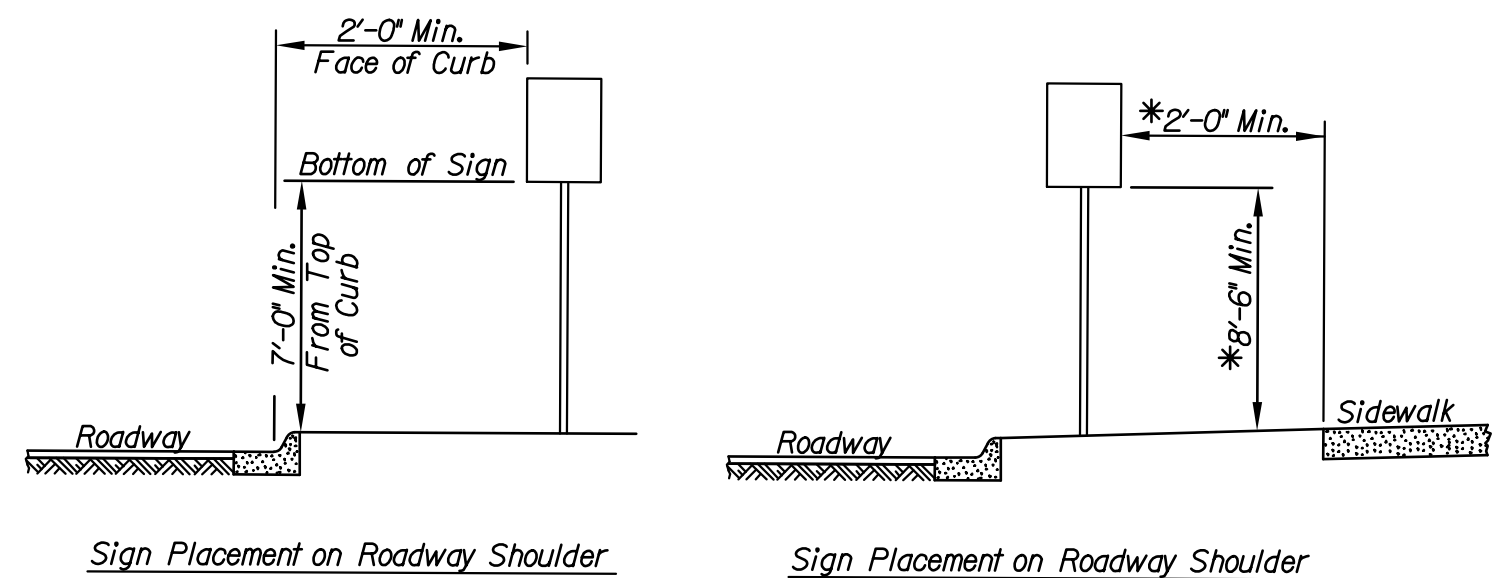

Sign Placement on Roadway Shoulder

Sign Placement on Roadway Shoulder

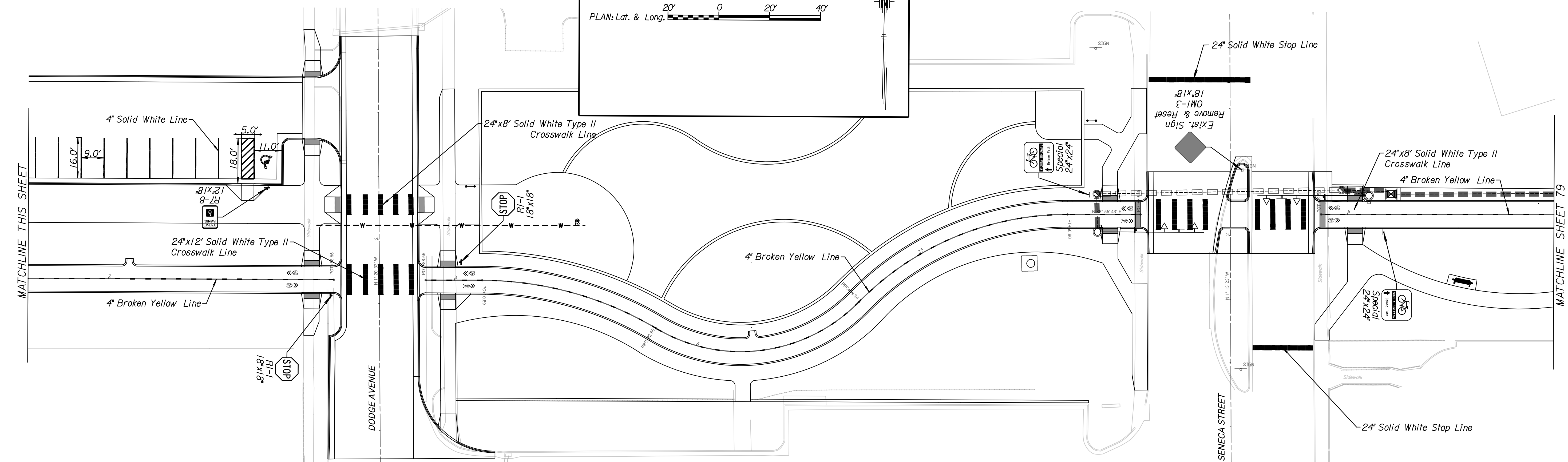
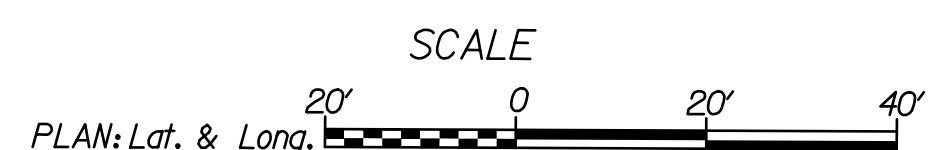
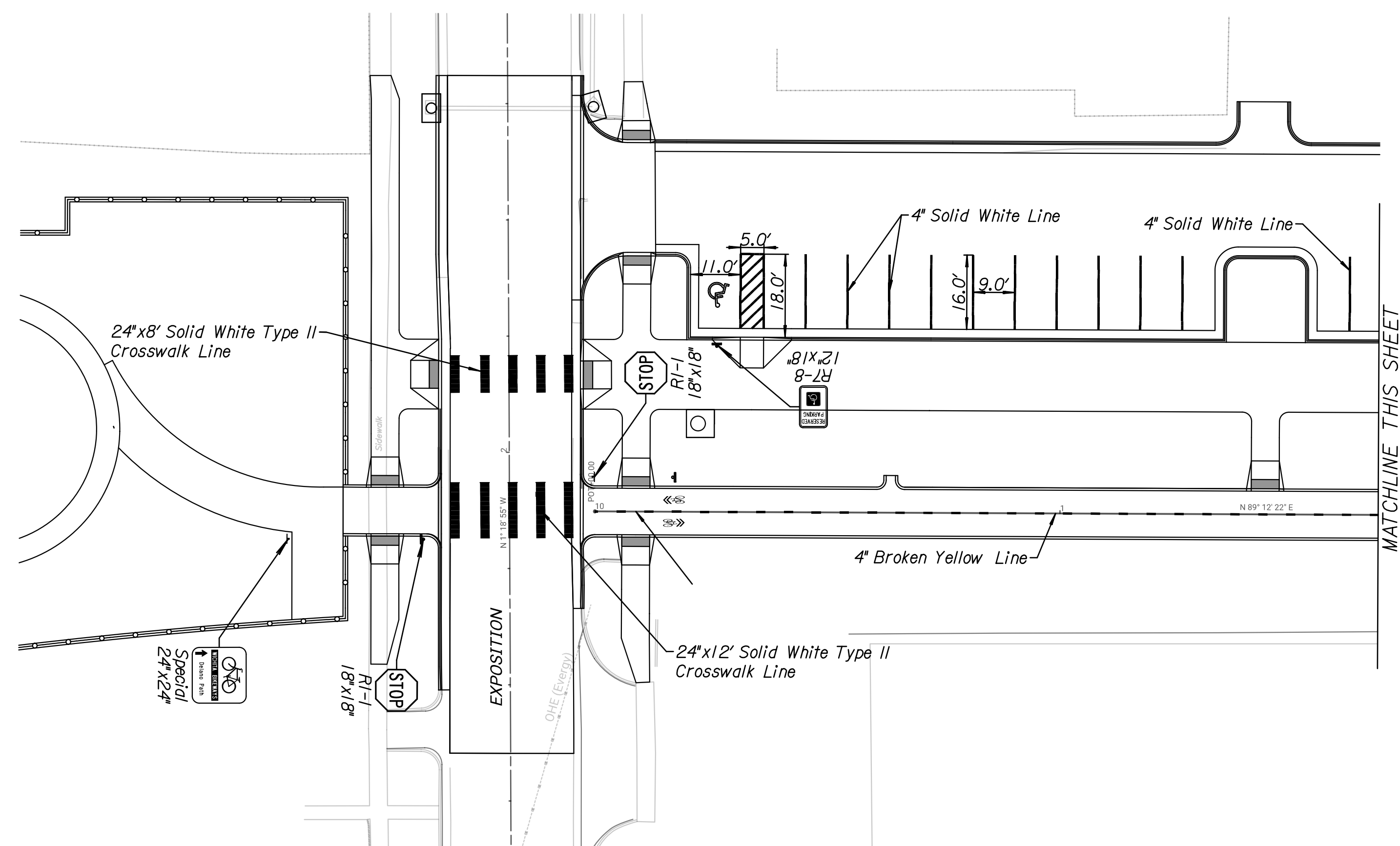

TranSystems
 245 NORTH WACO
 SUITE 222
 WICHITA, KANSAS 67202
 PHONE: 316-303-3000
 FAX: 316-462-5629

CONSULTANTS:
LK ARCHITECTURE, INC.
 345 RIVERVIEW
 SUITE 200
 WICHITA, KANSAS 67208
 PHONE: 316-268-0230

DELANO GREENWAY IMPROVEMENTS FROM EXPOSITION TO OSAGE
 WICHITA, KANSAS
CITY OF WICHITA

REVISIONS:	MARK	DATE	DESCRIPTION

PROJ NO: 472-85462
 SCALE: 1"=20'
 DATE: 11/1/2022
 DESIGNED BY: MCG
 DRAWN BY: MCG
 CHECKED BY: MDB

SHEET TITLE:
 DELANO GREENWAY PAVEMENT MARKING & SIGNING

SHEET NO.
 78

SHEET 78 OF 96

d:\projects\11172022 - 656005 AM - c:\transtrans\paw_local\transtrans\paw\delano\0875431C-PK-K-G01-101.dgn
 11/1/2022