

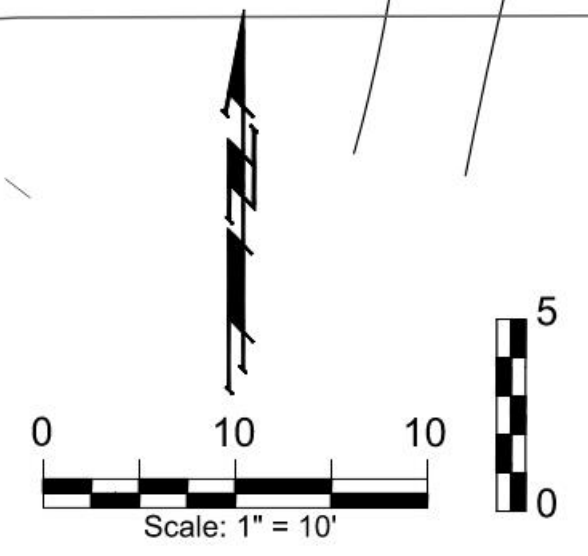

Revision Schedule

No.	Date	Description
1	10/6/2023	PERMIT SET
2	1/23/2024	REVISED SET FOR REBID

Bridge #7

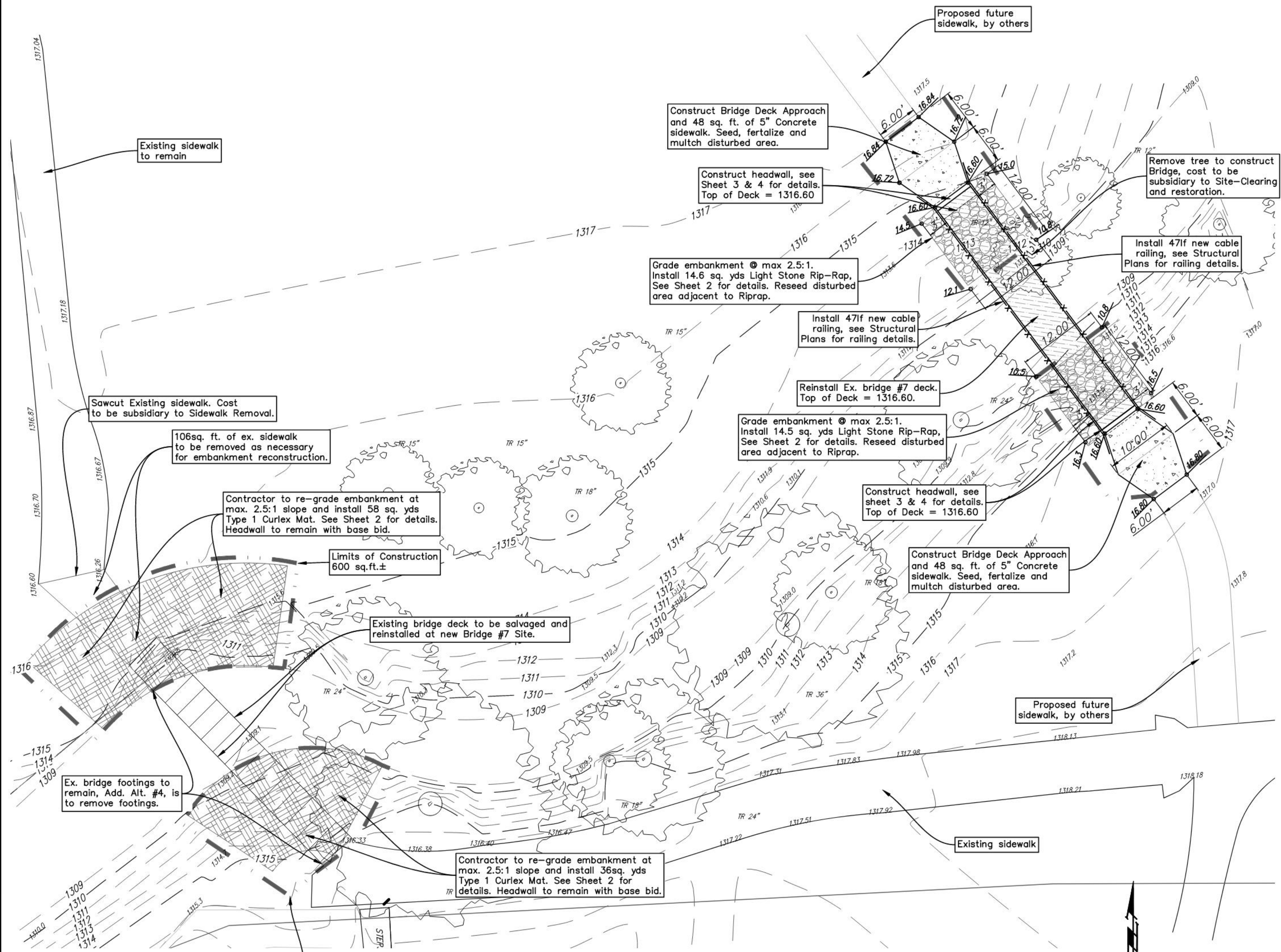

Add Alternate #1, Bridge #2 Channel

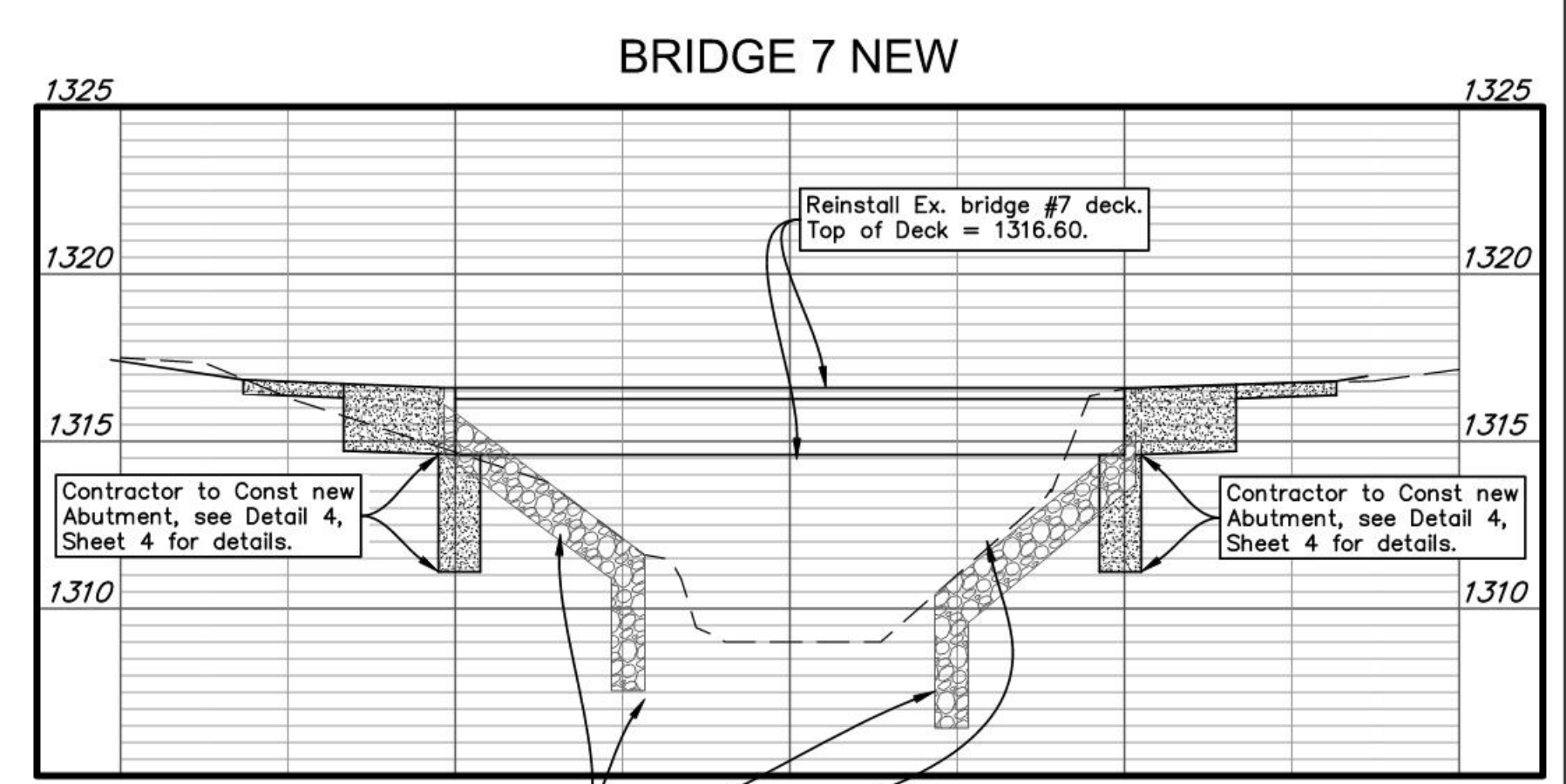
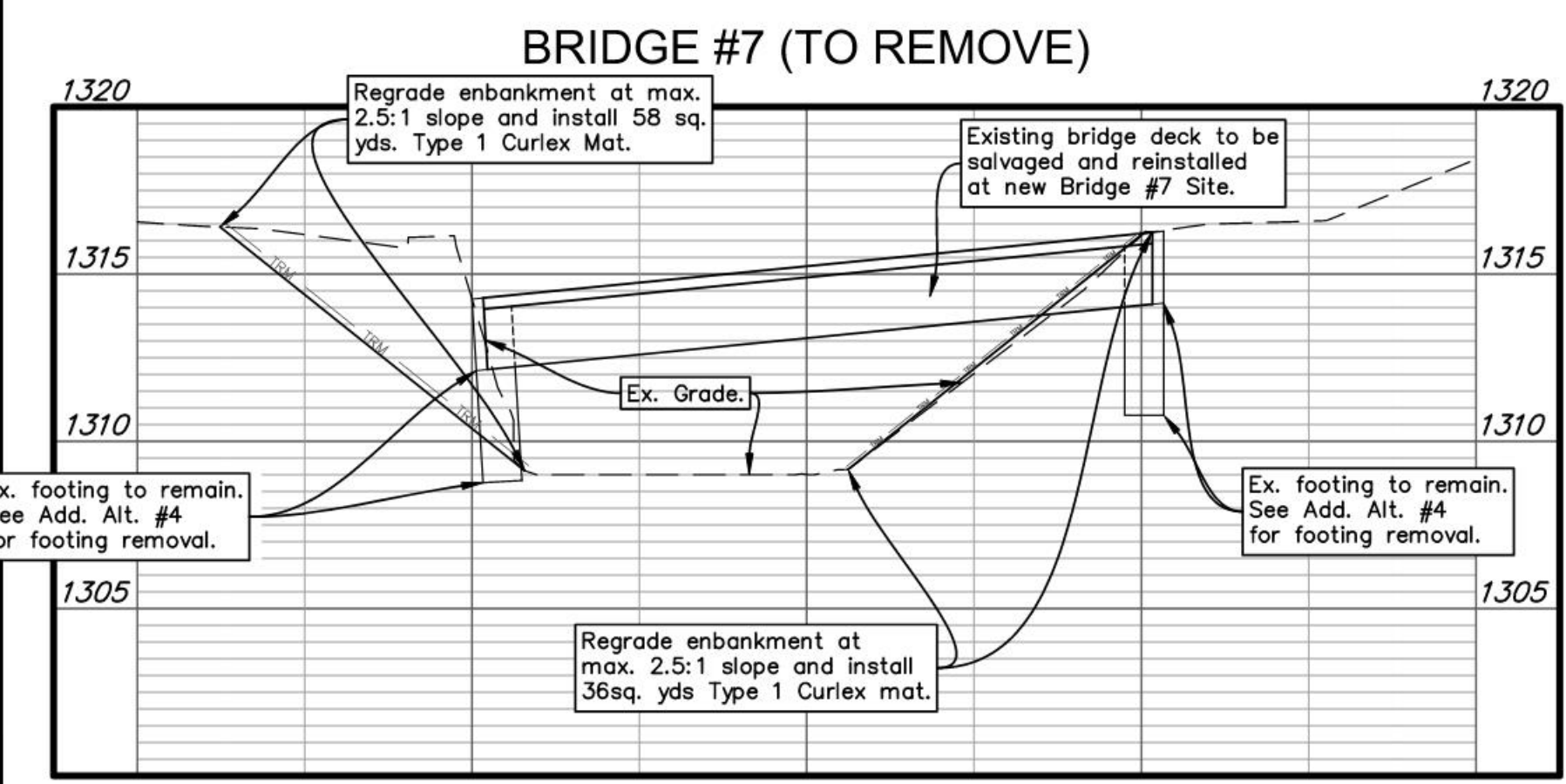
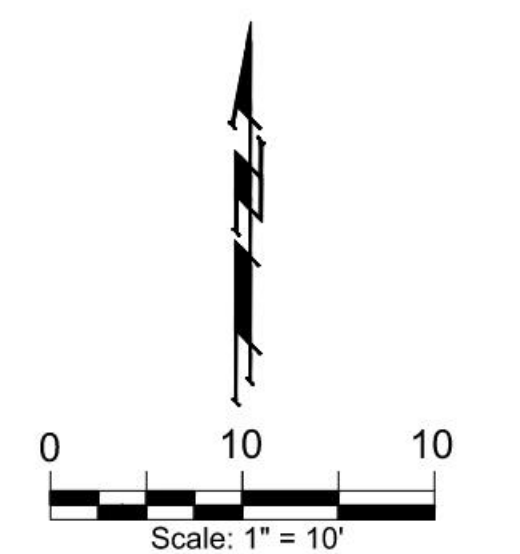
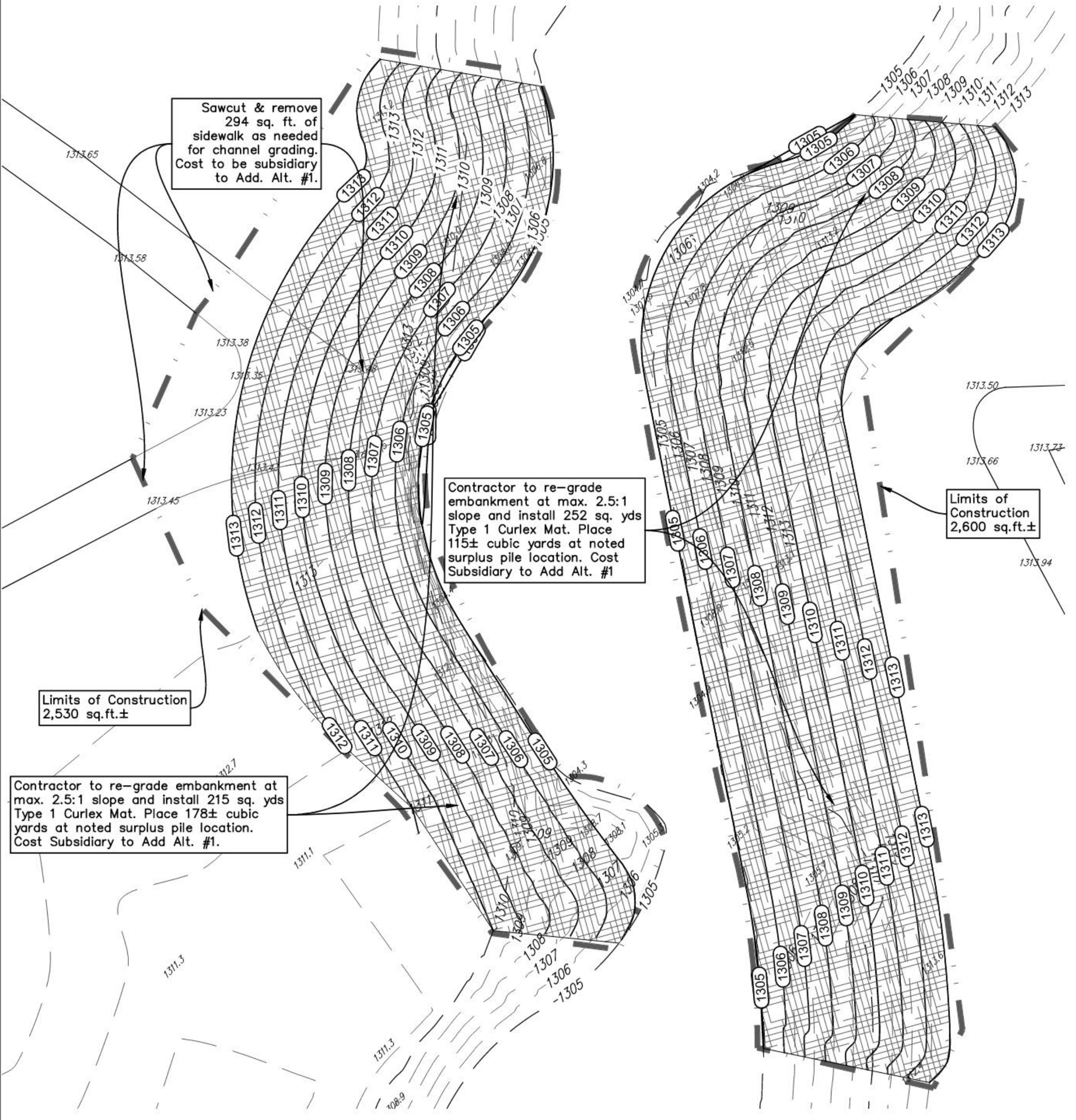

Add Alternates:

- 1. Regrade Bridge 2 location and install curlex mat.
- 2. Salvage & move Bridge 11 & 12 deck and combine at new location.
- 3. Removal of Footings at Bridge 4, 7, 9, 11 & 12 in place of abandonment.
- 4. Substitute 6"x1" IPE Wood for the Base Treated Wood for Railing Top Frame. Substitute Stainless Steel Cables for the base Galv. Steel Cable.

RECONSTRUCTION OF BRIDGE 7, REGRADE OF BRIDGE 2



L.W. CLAPP PARK
CITY OF WICHITA
4611 E HARRY STREET
WICHITA, KS 67218

Project Number 19305
Issue PERMIT SET
Date 2023-10-06

8
11

THE SCALE SHOWN ABOVE IS EXACTLY ONE INCH LONG AT THIS SCALE IS ORIGINAL PAPER SIZE
THE SQUARES REPRESENT COLORS WITH BLACK AND WHITE LETTERS IF PRINTED CORRECTLY
File Location: E:\Projects\Clapp Park PH1 - Gypsum Creek Bridge Replacement (23-01-E414)\Engineering\Clapp Park Base / SAVE DATE: 2/7/2024 3:37 PM BY: pml / PLOT DATE: 2/7/2024 3:39 PM BY: pml