

**Benchmark**

BM #1 - City Disc Located @ 12.89m South and 10.91m West of the Centerline of both Meridian and Central. Elev. = 397.376 SI Units (1303.71 MSL Datum)

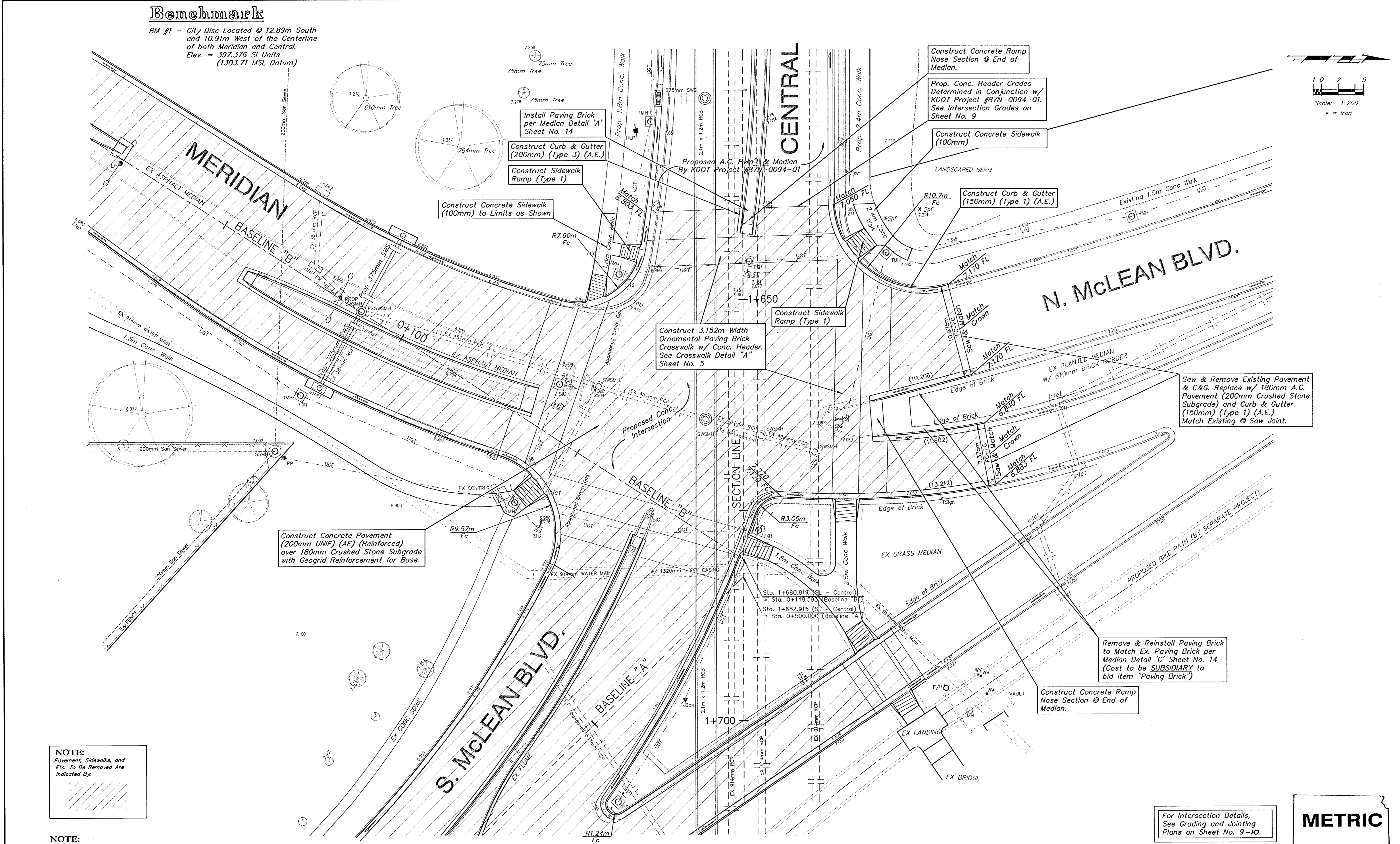
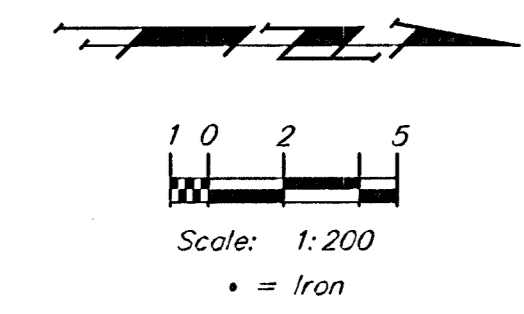

**NOTE:**  
Pavement, Sidewalks, and Etc. To Be Removed Are Indicated By

**NOTE:**  
Utility poles, electrical junction pedestals, boxes, and etc. are to be REMOVED & RELOCATED as necessary by the Respective Utility Company/ Owner PRIOR TO CONSTRUCTION of this Project.

For Intersection Details, See Grading and Jointing Plans on Sheet No. 9-10

**METRIC**

DESIGN	DATE	CITY PROJECT NUMBER	BAUGHMAN PROJECT NUMBER
JFB	JULY99	472-78-245-82910	98-01-E965
DRAWN	SCALE	APPROVED	DIRECTOR
AZIERE	NOTED	JFB	F/MC/LN/T/P/V
			SHEET NO. 3 OF 40

CAPITAL IMPROVEMENT PROJECT  
**INTERSECTION IMPROVEMENTS AT CENTRAL & McLEAN**

**BAUGHMAN COMPANY P. A.**  
ENGINEERING, SURVEYING, & PLANNING  
316-262-7271 • 315 ELLIS • WICHITA, KANSAS 67211