

STATE	PROJECT NO.	YEAR	SHEET NO.	TOTAL SHEETS
KANSAS	472-2021	2024	1	163

# CITY OF WICHITA, KANSAS

## PLAN AND PROFILE OF PROPOSED COMMERCE STREET & ST. FRANCIS AVENUE IMPROVEMENTS

### FROM WATERMAN TO KELLOGG

**C.O.W. PAVING PROJ. NO. 472-2021-085759**

**MUNIS NO. E2028 ORG CODE 40106922**

**C.O.W. WATER PROJ. NO. 448-2023-012700**

**MUNIS NO. W3010 ORG CODE 54250023**

**C.O.W. SAN. SEWER PROJ. NO. 468-2023-012701**

**MUNIS NO. S3005 ORG CODE 53200023**

GRADING  
CONCRETE PAVEMENT  
STORM SEWER  
PAVEMENT MARKING  
SIGNING  
SODDING  
SANITARY SEWER  
WATERLINE  
LANDSCAPING  
AESTHETICS  
LIGHTING

#### INDEX OF SHEETS

1	Title Sheet
2	General Notes
3	Coordinate Control Data
4	Geometric Data
5 - 7	Typical Sections
8 - 10	Plan Sheets - Commerce Street
11 - 13	Plan Sheets - St. Francis Street
14 - 25	Streetscape Plan Sheets
26 - 27	Art Tower Foundation Details
28	Plan Sheet - Driveway & Pedestrian Walkway
29 - 38	Storm Sewer Plan & Profile Sheets
39	Schedule of Storm Sewer
40 - 50	Storm Sewer Details
51 - 53	Jointing Plan Sheets
54 - 61	Intersection & Entrance Layout Details
62 - 67	Geometric Layouts and Details
68	Driveway Details
69	Wheelchair Ramp Details
70	Curb & Gutter Details
71	Valley Gutter Details
72 - 75	Erosion Control Details
76 - 77	Summary of Quantities
78	Construction Phasing Overview
79 - 95	Construction Phasing Plans
96 - 99	Traffic Control Standards
100 - 105	Pavement Marking & Signing Plans
106 - 109	Electrical & Lighting Plans
110 - 111	Sanitary Sewer System Details
112	Sanitary Sewer System Plan & Profile Sheet
113	Water System General Notes & Summary of Quantities
114 - 115	Water System Coord Data
116 - 122	Waterline Plan & Profile Sheets
123 - 126	Water System Details
127 - 141	Commerce Street Cross Sections
142 - 163	St. Francis Avenue Cross Sections

#### DESIGN DESIGNATION

AADT (2022) COMMERCE ST.	=	400
AADT (2052) COMMERCE ST.	=	970
AADT (2022) ST. FRANCIS ST.	=	500
AADT (2052) ST. FRANCIS ST.	=	1200
V (COMMERCE)	=	20 MPH
V (ST. FRANCIS)	=	30 MPH
C of A	=	NONE
LATERAL OFFSET	=	6.0 FT

#### CONVENTIONAL SIGNS

COUNTY LINE	-----	CENTER LINE OF PROJECT	-----
CITY LIMITS	=====	TERRACE	-----
STATE OR NATIONAL LINE	-----	CULVERTS	-----
TOWNSHIP, SECTION or GRANT LINE	-----	DROP INLET & STORM SEWER	-----
PROPERTY LINE	-----	ACCESS CONTROL	-----
HIGHWAY FENCE	-----	POWER POLE	-----
EXISTING FENCE	-----	TELEPHONE POLE	-----
GUARD FENCE	-----	MARSH	-----
CONSTRUCTION LIMITS	-----	HEDGE	-----
RIGHT OF WAY LINE	-----	TREES	-----
TRAVELED WAY	-----	PROFILE ELEVATION	-----
RAILROADS	-----	STREAM or CREEK	-----

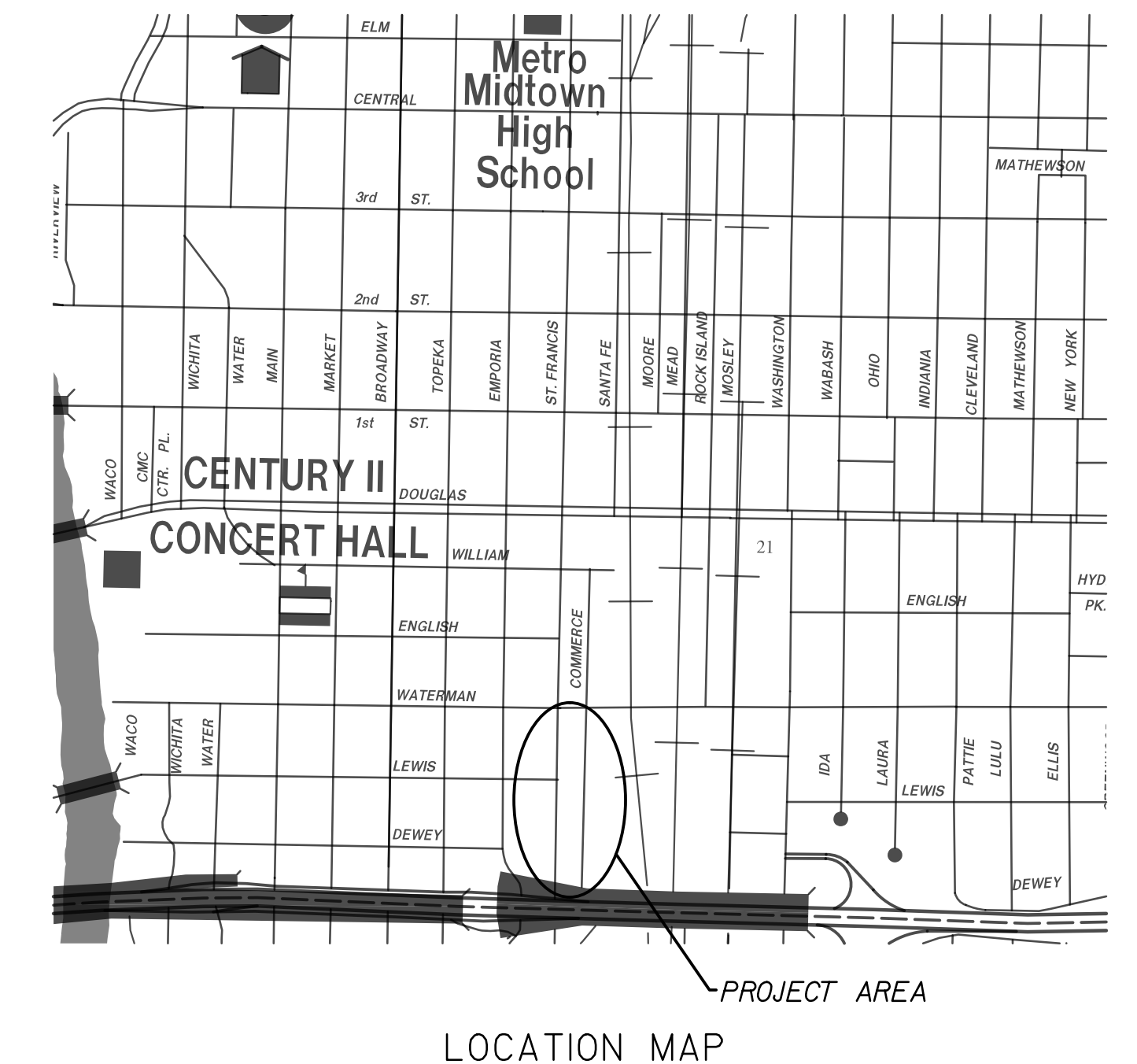
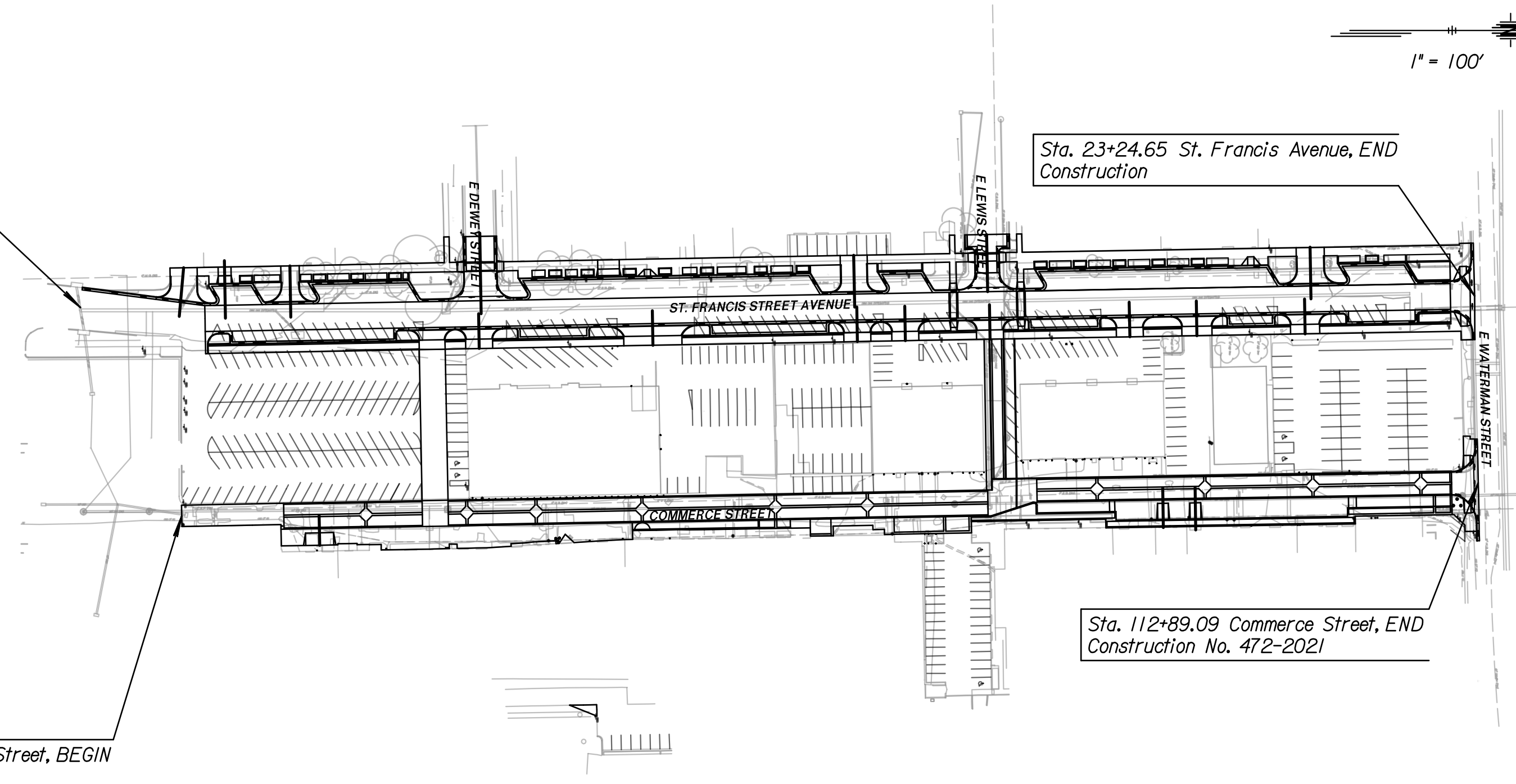

GROSS LENGTH OF PROJECT 2,496.02 FT. 0.47 MILES

NET LENGTH OF PROJECT 2,496.02 FT. 0.47 MILES

NET LENGTH OF BRIDGES 0 FT. 0 MILES

NET LENGTH OF ROAD 2,496.02 FT. 0.47 MILES

PREPARED BY:

**TRANSYSTEMS**  
245 N. WACO, SUITE 222  
WICHITA, KANSAS 67202  
MAIN: 316-303-3000  
FAX: 316-462-5629

**LK ARCHITECTURE**  
LK Architecture, Inc.  
345 Riverview  
Suite 200  
Wichita, KS 67208  
Main: 316-268-0230

	TranSystems Mace L. Crowell, P.E. KS License No. 30168 Sheets: 1-13, 28-105, & 127-163
	LK Architecture, Inc. Landscape Architect Jeffrey A. Best, P.L.A. KS License No. 679 Sheets: 14-25
	LK Architecture, Inc. Courtney O. Wasson, P.E. KS License No. 18859 Sheets: 106-109