

LEGEND

-  Pavement, Sidewalk, and Gutter Removal
-  Tree/Shrub Removal

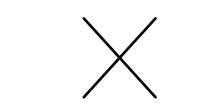
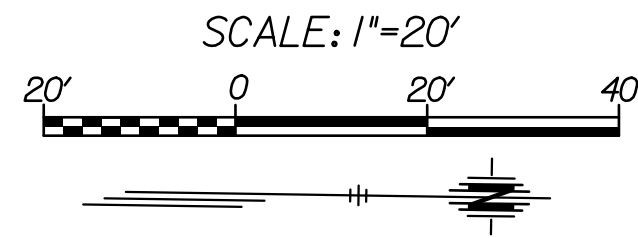

PROJECT SURVEY CONTROL & DATUM BENCHMARK

Horizontal - Kansas State Plane Coordinate System (South Zone) - NAD83 - Reduced to Ground (CAF = 0.99988682)

Vertical - BM#100  
 \*Cut set in top of curb on South side of Waterman.  
 N: 1,683,287.2601  
 E: 1,650,540.8426  
 Datum: NAVD88 - Elevation = 1296.68

- Note:  
 (XXX) For control and coordinate data, See Sheet 3  
 For Storm Sewer Plan and Profiles, See Sheets 29-38  
 For Geometric Layout & Details of the brick and concrete transitions, See Sheets 62-67  
 Contractor is to field verify all utility locations and elevations prior to excavating. Utility locations and elevations are shown to the best knowledge of the utility companies.

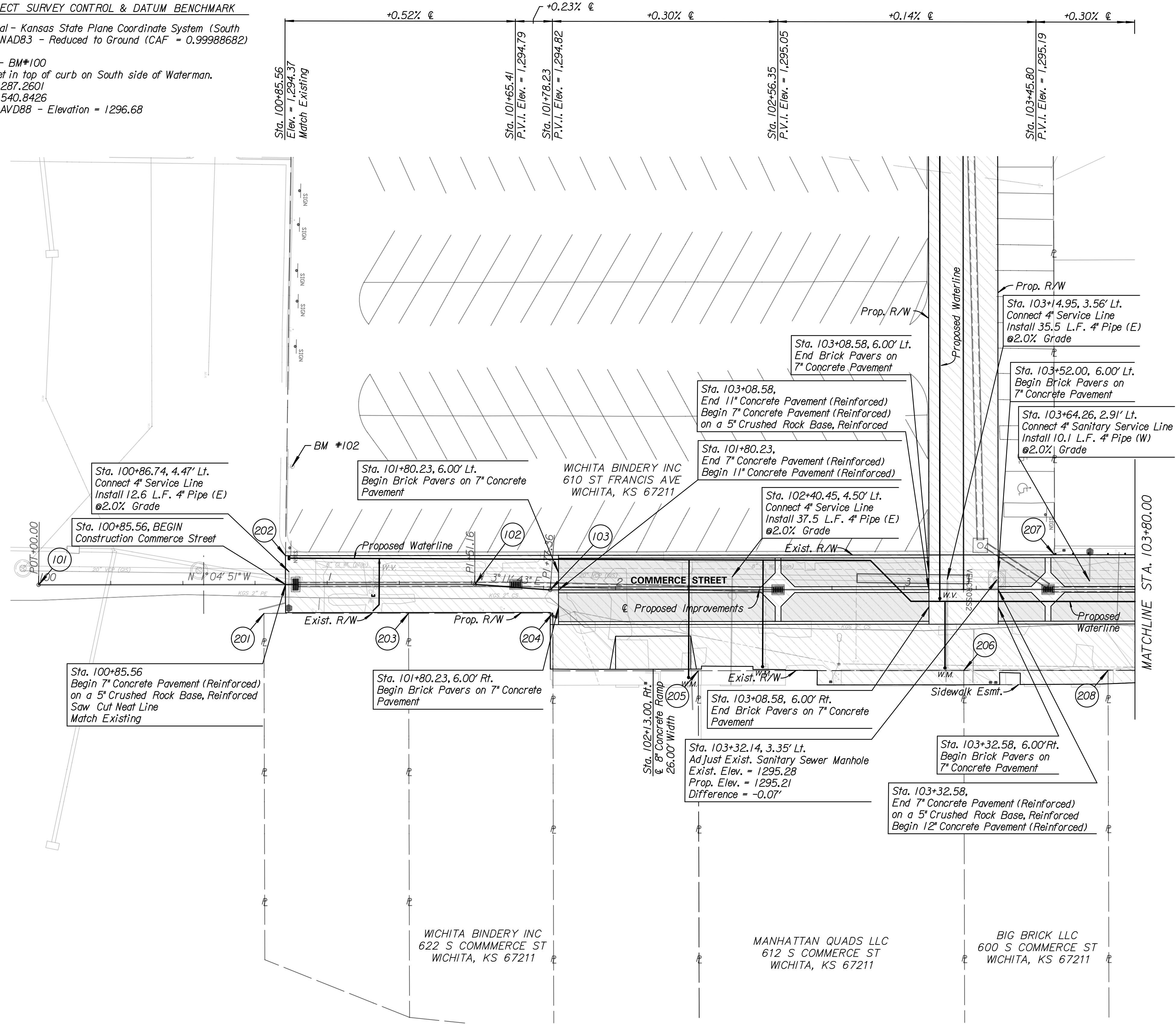

BM #102  
 \*Cut in top of Light Pole Base  
 N: 1,683,091.8049  
 E: 1,650,609.6675  
 40.93' Lt., Sta. 100+87.95, Elev = 1298.08

**TRANSYSTEMS**  
 245 N. WACO  
 SUITE 222  
 WICHITA, KANSAS 67202  
 MAIN: 316-303-3000  
 FAX: 316-462-5629

CONSULTANTS:

COMMERCE STREET & ST. FRANCIS AVENUE IMPROVEMENTS FROM WATERMAN TO KELLOGG  
 WICHITA, KANSAS  

REVISIONS:	MARK	DATE	DESCRIPTION

PROJ NO: 472-2021  
 SCALE: 1"=20'  
 DATE: 2/21/2024  
 DESIGNED BY: MLC  
 DRAWN BY: DJK  
 CHECKED BY: MDB

SHEET TITLE:  
 COMMERCE STREET IMPROVEMENTS  
 STA. 100+85.56 TO STA. 103+80.00

SHEET NO.  
 8  
 SHEET 8 OF 163

2/21/2024 11:42:48 AM c:\transystems\pwworkspace\jkratzend1254772\C-RDWM02-101.dgn