

FHWA REG NO.	STATE	PROJECT NO.	YEAR	SHEET NO	TOTAL SHEETS
7	KANSAS	87 N-0088-01	1999	18	38

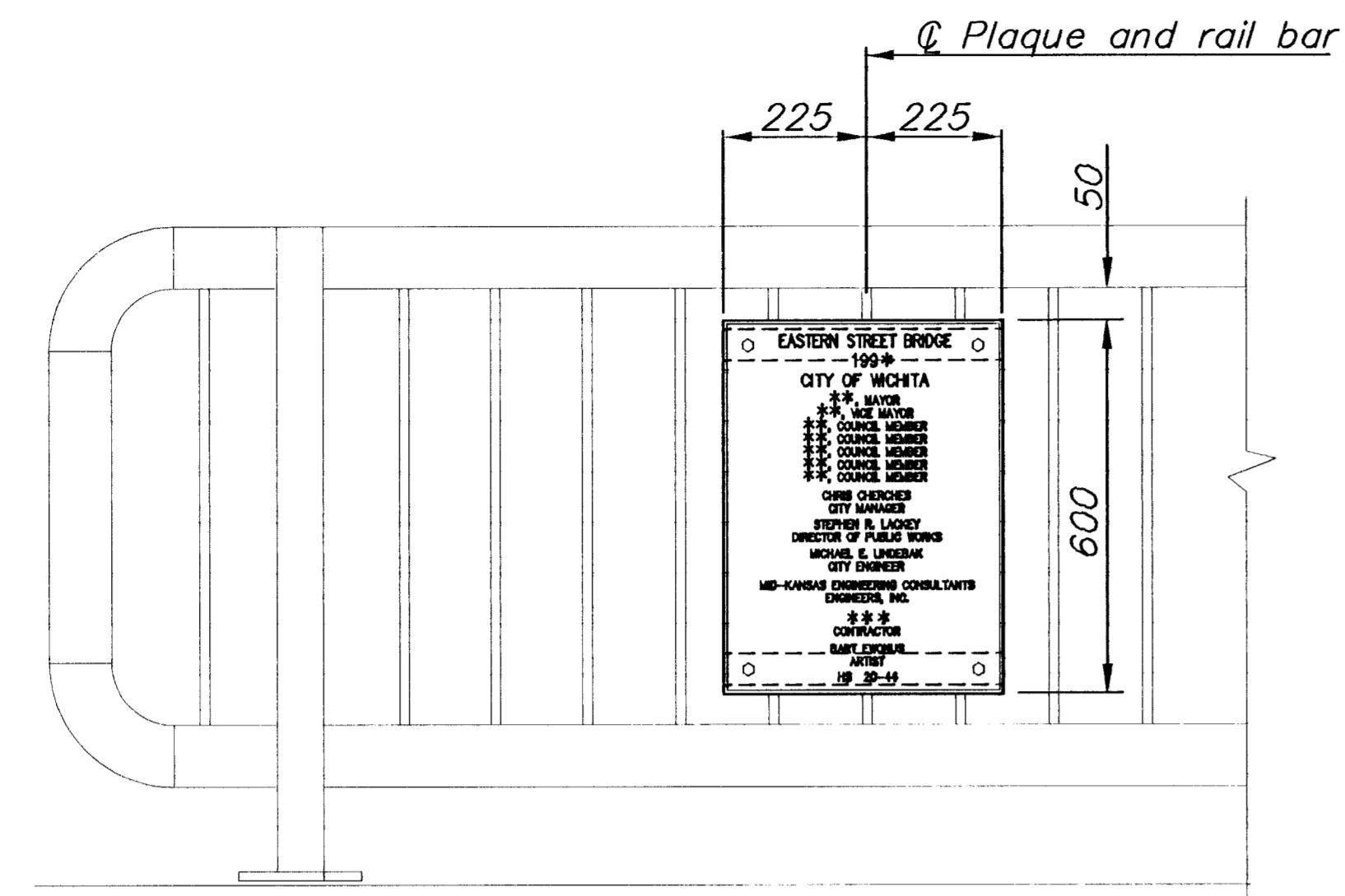

ELEVATION

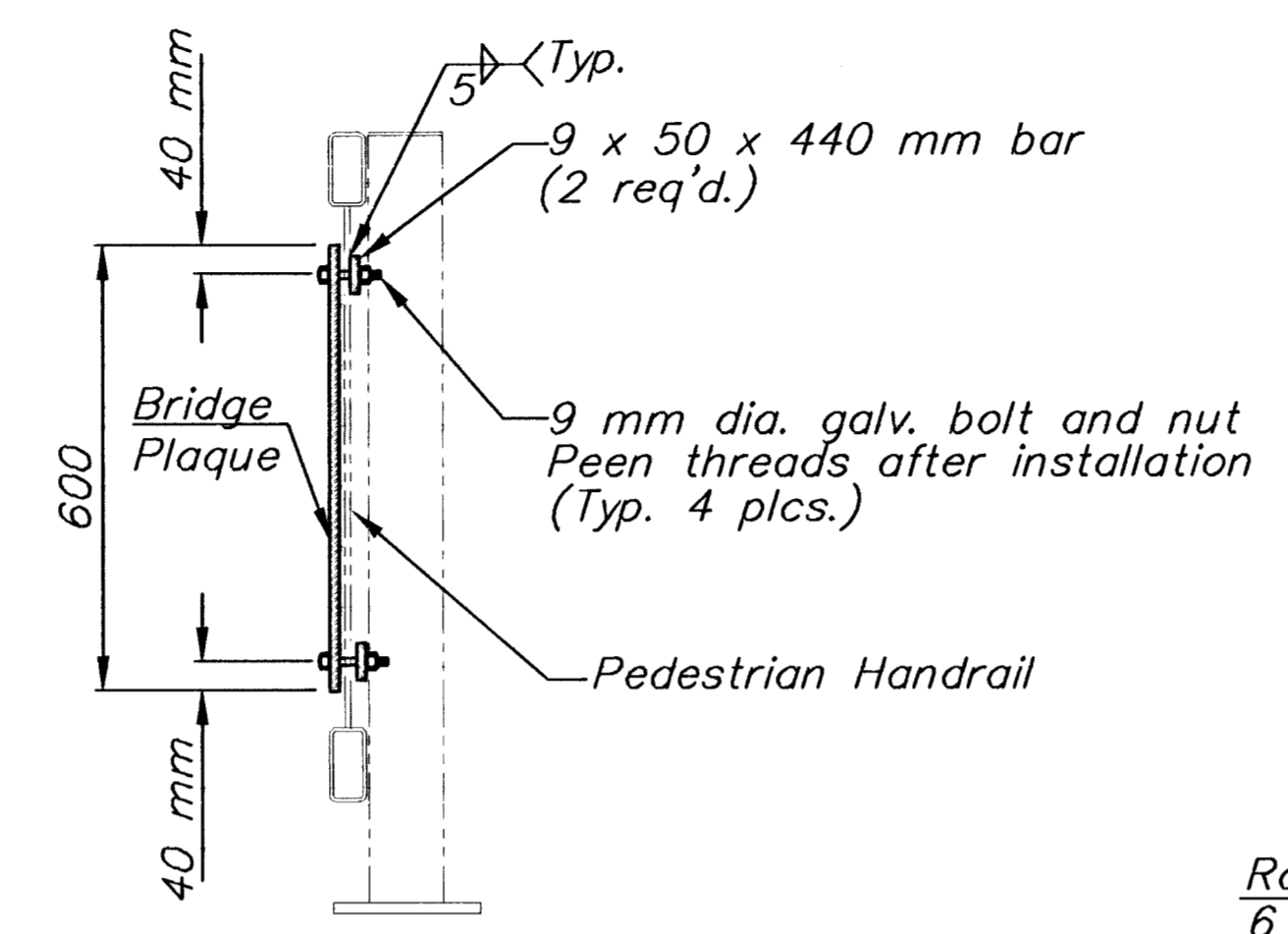

SECTION

BRIDGE PROJECT MARKER DETAIL

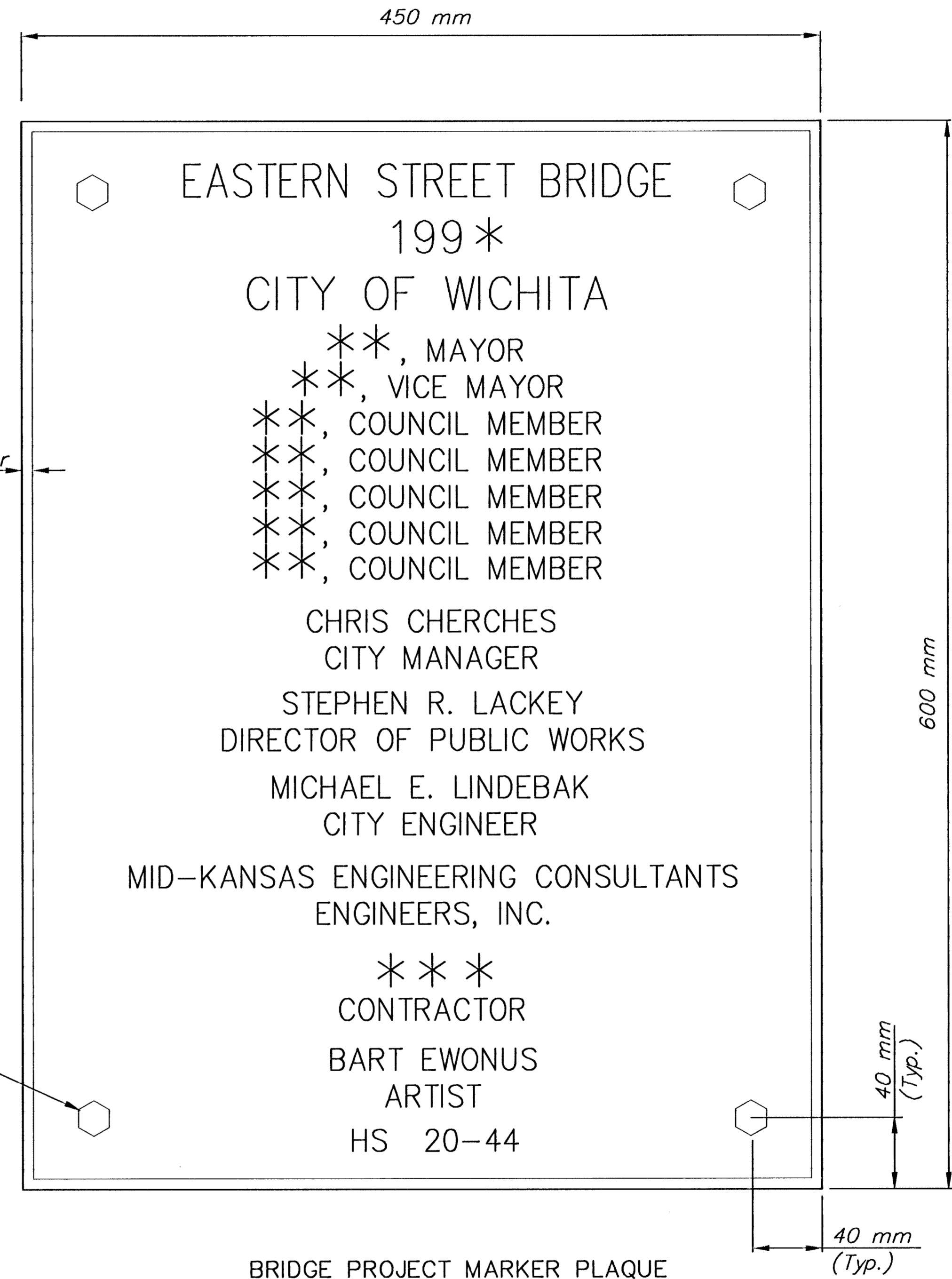

BRIDGE PROJECT MARKER PLAQUE

(1 Marker Required)

(Non Participating)

* Year Bridge Completed

** First Name, Middle Initial, Last Name

(by City Engineering Dept.)

*** Name of Contractor

GENERAL NOTES:

Contractor to furnish a rubbing of the Bridge Project Plaque to the Engineer for approval before casting. Project Bridge Plaque shall conform to applicable requirements of Sub-section 1625 of the Kansas Dept. of Transportation Standard Specifications. Plaque shall be manufactured such that it can be attached to pedestrian handrail.

Plaque to be mounted on the traffic side of the southeast sidewalk pedestrian rail. Plaque shall be centered vertically on the rail.

NO.	DATE	REVISIONS	BY	APP'D
2				
1				

KANSAS DEPARTMENT OF TRANSPORTATION
BR. NO. 530400870GC1020 STA. 1+450.20
BRIDGE PLAQUE DETAIL
PROJ. NO. 87 N-0088-01 SEDGWICK CO.
MID-KANSAS ENGINEERING CONSULTANTS, INC.
WICHITA, KANSAS

DESIGNED BY: KJS CHECKED BY: MDK
DRAWN BY: DPG DATE: NOV 98 SHEET OF