

FHWA REG NO.	STATE	PROJECT NO.	YEAR	SHEET NO.	TOTAL SHEETS
7	KANSAS	87 N-0088-01	1999	33	38

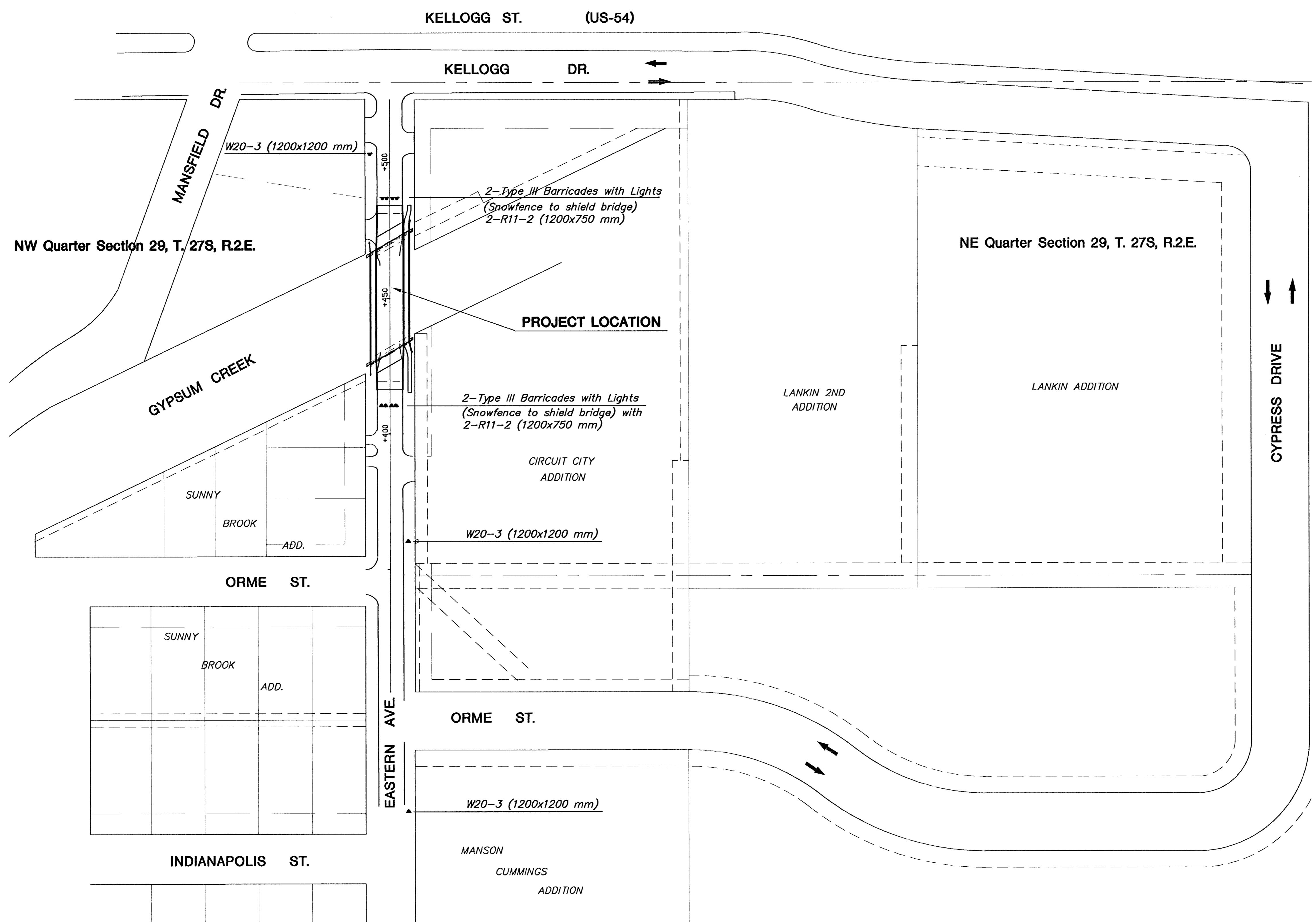

NOTE: Bridge shall be closed to traffic during construction.

Contractor to notify 911 a minimum of 48 hours prior to closing bridge.

See Sheet No. 37 for additional details.

DETOUR PLAN

NO.	DATE	REVISIONS	BY	APP'D
2				
1				

KANSAS DEPARTMENT OF TRANSPORTATION

TRAFFIC CONTROL PLAN
(Eastern over Gypsum Creek)

PROJ. NO. 87 N-0088-01 SEDGWICK CO.

DESIGNED		APP'D	
SDJ	DPG	QUANTITIES	CADD
MDK	MDK	QUAN. CK.	MDK
DESIGN CK.		CADD CK.	