

**City of Wichita**  
Sedgwick County, Kansas

| FHWA REGION NO. | STATE  | PROJECT NO.  | YEAR | SHEET NO. | TOTAL SHEETS |
|-----------------|--------|--------------|------|-----------|--------------|
| 7               | KANSAS | 87 N-0137-01 | 99   | 1         | 94           |

FEDERAL AID No. STP-N013(701)

## 29th Street North Paving and Storm Sewer Improvements

(from Oliver Street to Woodlawn Avenue)  
 KDOT Project No.: 87 N-0137-01  
 City Project No.: 472-82996  
 Index Code: 706754

## Decel Lane on 29th Street North at Meadow Oaks Street

KDOT Project No.: 87 N-0137-01  
 City Project No.: 472-87355  
 Index Code: 764084

City Engineer: Mr. Michael E. Lindebak, P.E.

### INDEX OF SHEETS:

|   |       |
|---|-------|
| TITLE SHEET                               | 1     |
| KEY MAP AND GENERAL NOTES                 | 2     |
| TYPICAL PAVEMENT SECTIONS                 | 3-4   |
| 29TH STREET NORTH PLAN / PROFILE          | 5-14  |
| INTERSECTION DETAILS, (MEADOW OAKS)       | 15    |
| BEACON HILL, CL STA. 15+57.73, AND        |       |
| CL STA. 18+26.23)                         |       |
| STD. DRIVE ENTRANCE - FULL HEIGHT CURB    | 16    |
| VALLEY GUTTER DETAILS AND                 | 17    |
| WHEELCHAIR RAMP DETAILS                   |       |
| PAVEMENT UNDERDRAIN DETAILS               | 18    |
| STORM SEWER PLAN / PROFILE                | 19-25 |
| STD. TYPE I CURB INLET                    | 26-27 |
| STD. TYPE I-A CURB INLET                  | 28-29 |
| STD. TYPE 'P' MANHOLE                     | 30    |
| REINFORCED CONCRETE MANHOLE               | 31    |
| MANHOLE FRAME & COVER                     | 32    |
| MANHOLE ADJUSTMENT DETAIL                 | 33    |
| PAVEMENT MARKING PLANS                    | 34-38 |
| SUMMARY AND RECAPITULATION OF PAVEMENT    | 37    |
| MARKING QUANTITIES                        |       |
| TRAFFIC CONTROL PLANS                     | 38-41 |
| TRAFFIC SIGNALIZATION PLANS FOR           | 42-44 |
| WOODLAWN AND 29TH STREET NORTH            |       |
| LANDSCAPING PLANS                         | 45-54 |
| SUMMARY OF EARTHWORK QUANTITIES           | 55    |
| CROSS SECTIONS                            | 56-86 |
| SUMMARY OF QUANTITIES                     | 87-88 |
| TEMPORARY PROJECT WATER POLLUTION CONTROL |       |
| EROSION CONTROL PLANS AND DETAILS         | 89    |
| SOIL EROSION (LA852A, LA852B)             | 90-91 |
| TEMPORARY SLOPE DRAIN, STREAM CROSSING,   | 92    |
| INLET SEDIMENT BARRIER (LA852C)           |       |
| STRAW OR HAYBALE SLOPE BARRIERS, SILT     | 93    |
| FENCE SLOPE BARRIERS (LA852D)             |       |
| STRAW OR HAYBALE DITCH CHECK, SILT        | 94    |
| FENCE DITCH CHECK (LA852E)                |       |

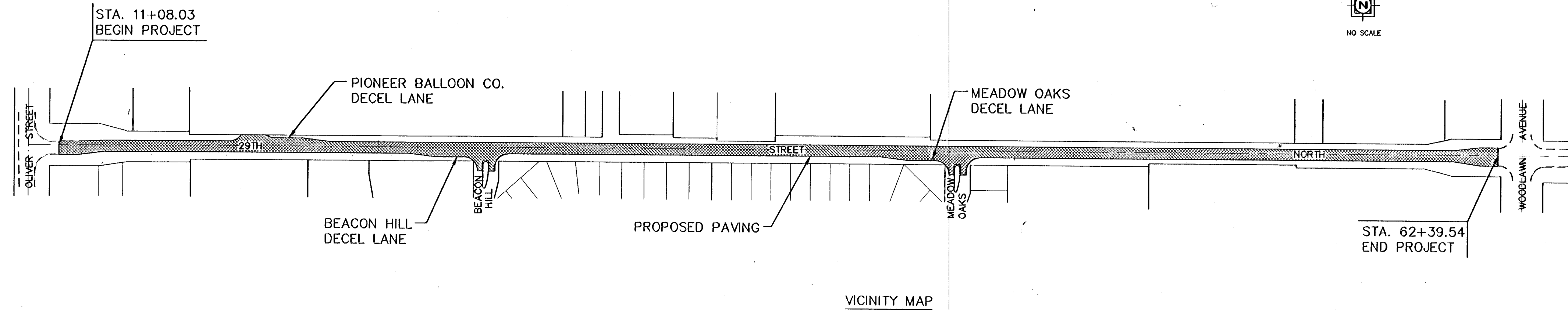

TOTAL PROJECT LENGTH: 5,131.51 L.F. = 0.97 MILES

**SUMMARY OF EARTHWORK:**

|                |          |
|----------------|----------|
| EXCAVATION     | 19087 CY |
| LOOSE FILL     | 3723 CY  |
| COMPACTED FILL | 2032 CY  |

**APRIL 1999**

PLANS PREPARED BY:



**YOUNG & ASSOCIATES, P.A.**  
CIVIL AND ENVIRONMENTAL ENGINEERS

100 South Georgia \* Dorby, Kansas \* 67037