

FHWA REGION NO.	PROJECT NO.	YEAR	SHEET NO.	TOTAL SHEETS
7	KANSAS	87 N-0137-01	98	36
FEDERAL AID No. STP-N013(701)				

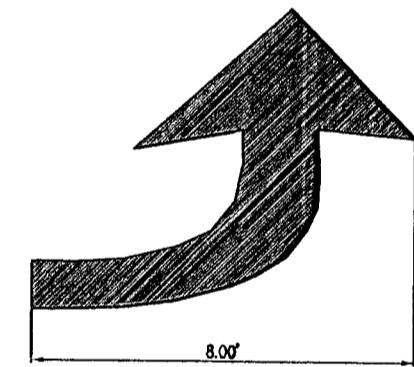
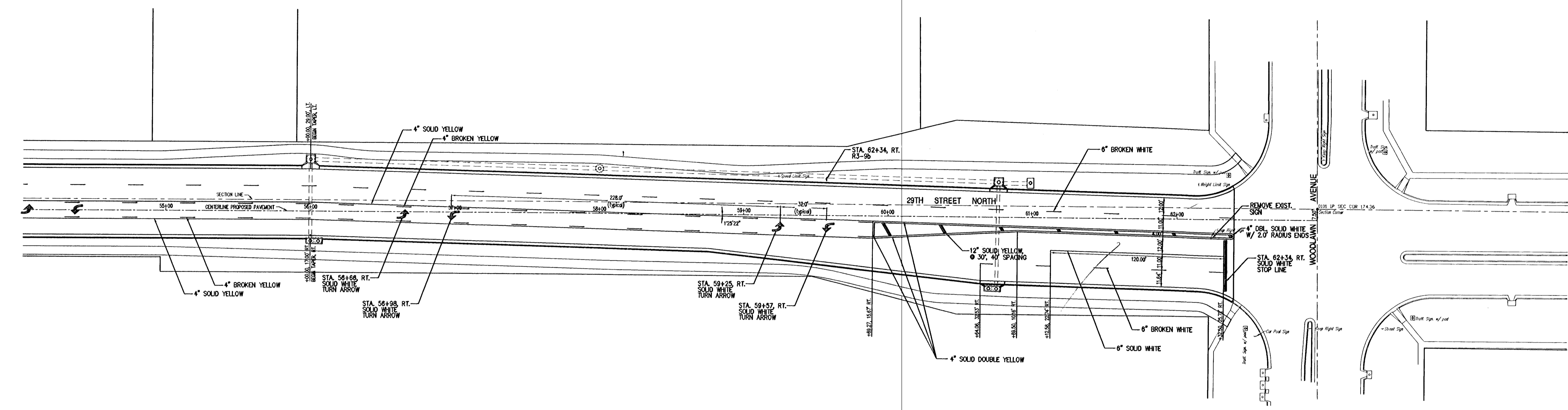
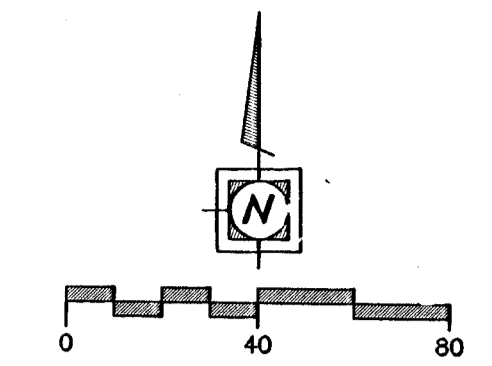

*Turn Arrows*

- NOTE:
1. THE CONTRACTOR SHALL NOTIFY UTILITY COMPANIES TO REMOVE AND RESET THEIR EXISTING SIGNS AND MARKERS AS REQUIRED FOR NEW CONSTRUCTION.
  2. ALL SIGNS ARE TO BE FURNISHED AND INSTALLED BY THE CONTRACTOR.
  3. PAVEMENT WORD AND SYMBOL MARKINGS SHALL BE IN CONFORMANCE WITH THE "STANDARD ALPHABETS FOR HIGHWAY SIGNS AND PAVEMENT MARKINGS", (FHWA, H10-20).

<b>YOUNG &amp; ASSOCIATES, P.A.</b> Civil and Environmental Engineers		100 South George Dorcy Kansas, 67037 Tel: (316) 788-2552 Fax: (316) 788-4408
City of Wichita Sedgwick County, Kansas		
<b>29TH STREET NORTH PAVEMENT MARKING PLAN</b>		
29th Street North from Oliver Street to Woodlawn Avenue Street, Decal Lane, and Storm Drainage Improvements		
Project No. 472-82787 and 472-82355	Engr.: CRY	Tech.: DAS, DIM
Y&A Proj. No.: 98-035-002	Scale: 1"=40'	
Date: April 1999		Sheet No. 36 of 94

FILE: P:\AMKCS\4400\_PLOT\_4-8-99\_ARCH\DWG\_114