

S.V.A. DWG. NAME: 8003E002.DWG; DATE: 04/30/98; TIME: 09:15

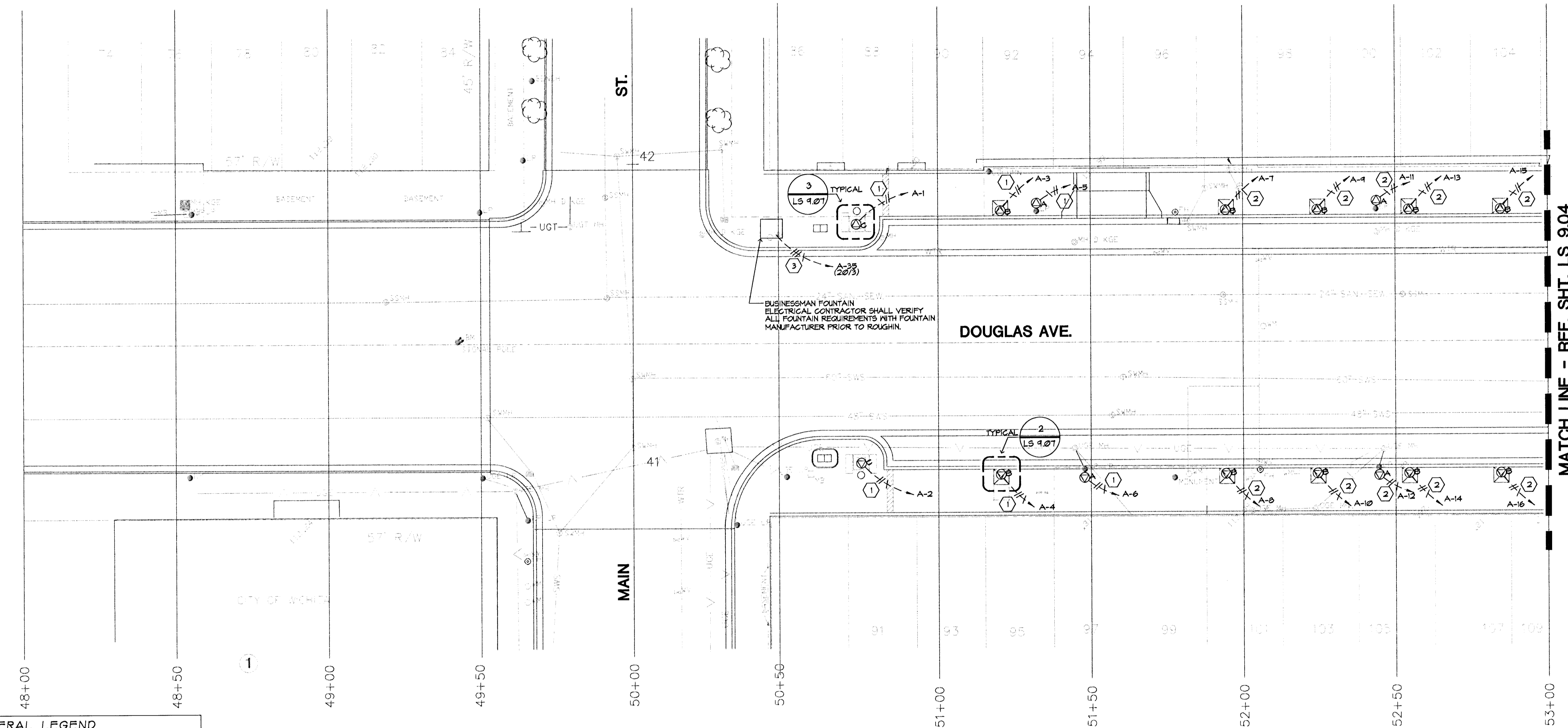

**GENERAL LEGEND**

- - - - - PROPERTY LINE  
 - - - - - CLL - - - - - CONTRACT LIMIT LINE  
 - - - - - CENTER LINE  
 WTR - - - - -  
 UGT - - - - -  
 GAS - - - - -  
 SWS - - - - -  
 ^ - UGE - ^  
 - - - - - EXISTING UTILITY LINES  
 - - - - - EDGE OF BASEMENT  
 --- --- --- EXISTING VAULTS

**DETAIL REFERENCE**

1 - - - - - DETAIL NO.  
 LS 9.07 - - - - - SHEET NO.

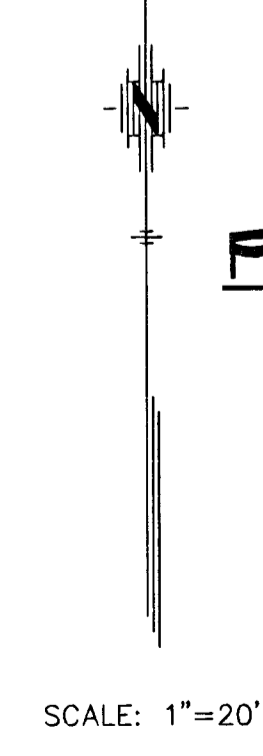

**PARTIAL DOUGLAS AVE. POWER PLAN**

**NOTES:**

1. BRANCH CIRCUITS ARE INDICATED AS ONE CIRCUIT HOME RUNS FOR CLARITY ONLY. CONTRACTOR MAY GROUP SINGLE POLE BRANCH CIRCUITS IN MULTIPLE CIRCUIT HOME RUNS (3 CIRCUIT MAXIMUM). A GROUND CONDUCTOR SIZED PER N.E.C. ARTICLE 250 IS REQUIRED IN ALL POWER, RECEPTACLE, AND LIGHTING CIRCUITS.

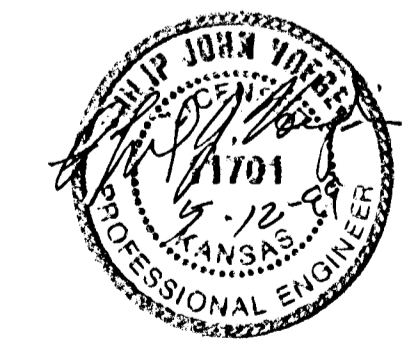

Electrical Engineering and Design  
 349 S. Hydraulic  
 Wichita, Ka 67211-1908  
 (316) 264-5061  
 FAX: (316) 264-3542

MID-KANSAS ENGINEERING CONSULTANTS, INC.  
 411 N. WEBB ROAD  
 WICHITA, KS. 67206  
 316-684-9600

**STREETSCAPES**  
 PROJECT NAME

**DOUGLAS AVE @ 50+00 TO 53+00**  
 SHEET TITLE

SVA DESIGN BY.	SVA DRAWN BY.	SVA CHECKED BY.
MAY 1998 DATE	92010 JOB NO.	LS 9.03 SHEET/OF