

S.V.A. DWG. NAME: 8003E005.DWG; DATE: 05/27/98; TIME: 09:25

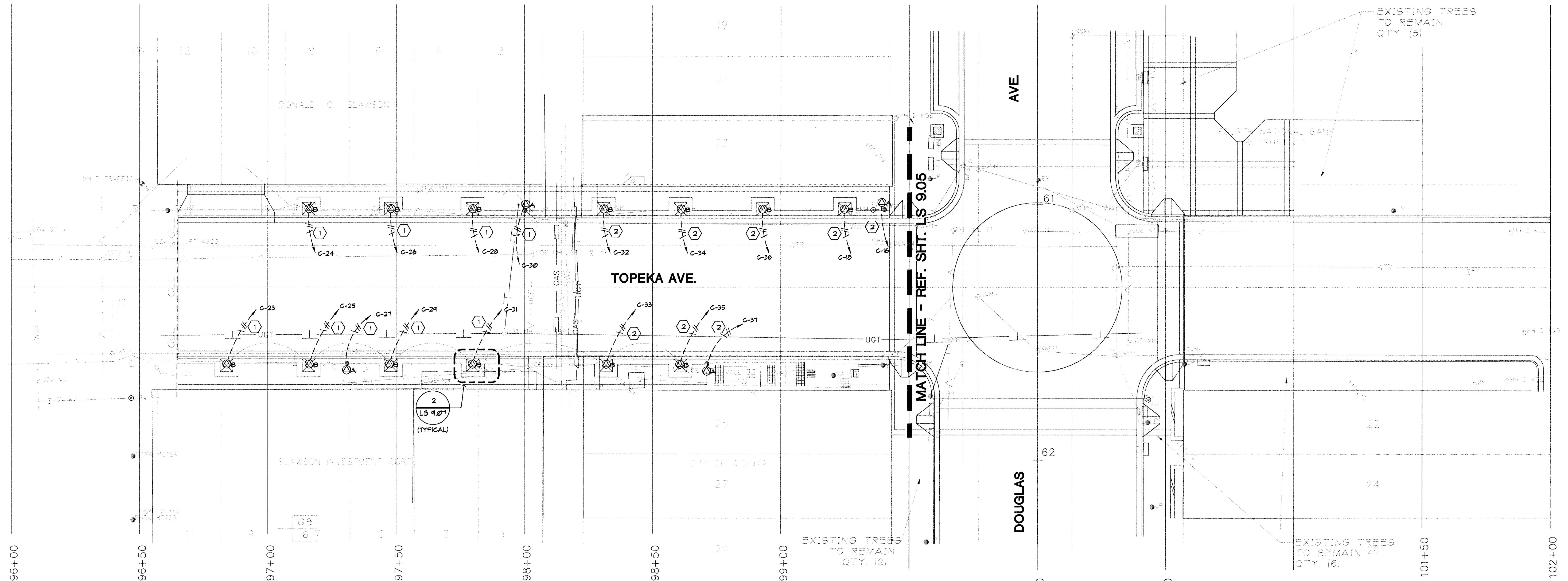

**GENERAL LEGEND**

- - - - - PROPERTY LINE  
 - - - - - CLL - CONTRACT LIMIT LINE  
 - - - - - CENTER LINE  
 - - - - - UGT  
 - - - - - GAS  
 - - - - - SWS  
 - - - - - UGE - U  
 - - - - - EXISTING UTILITY LINES  
 - - - - - EDGE OF BASEMENT  
 1 - - - - - DETAIL NO.  
 LS 9.07 - - - - - SHEET NO.  
 [Symbol] - - - - - EXISTING VAULTS

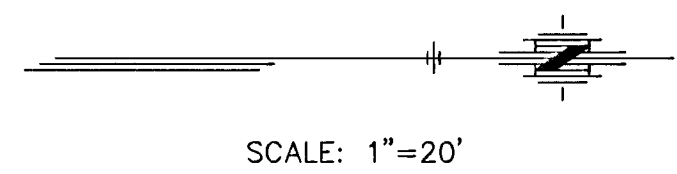

**PARTIAL TOPEKA AVE. POWER PLAN**

**NOTES:**

1. BRANCH CIRCUITS ARE INDICATED AS ONE CIRCUIT HOME RUNS FOR CLARITY ONLY. CONTRACTOR MAY GROUP SINGLE POLE BRANCH CIRCUITS IN MULTIPLE CIRCUIT HOME RUNS (3 CIRCUIT MAXIMUM). A GROUND CONDUCTOR SIZED PER N.E.C. ARTICLE 250 IS REQUIRED IN ALL POWER, RECEPTACLE, AND LIGHTING CIRCUITS.

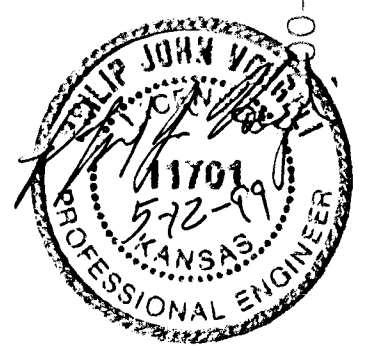

**Sterfan, Argeli Associates, Inc.**  
 Electrical Engineering and Design  
 349 S. Hydraulic  
 Wichita, KS. 67211-1908  
 (316) 264-5051  
 FAX: (316) 264-3542

**MID-KANSAS ENGINEERING CONSULTANTS, INC.**  
 411 N. WEBB ROAD  
 WICHITA, KS. 67206  
 316-684-9600

**STREETSCAPES**  
 PROJECT NAME  
**TOPEKA AVE. @ 96+50 TO 99+50**  
 SHEET TITLE

SVA DESIGN BY:	SVA DRAWN BY:	SVA CHECKED BY:
MAY 1998 DATE	92010 JOB NO.	LS 9.06 SHEET/OF