

LANDSCAPING  
**SENECA STREET**

CITY OF WICHITA  
 SEDGWICK COUNTY, KANSAS

PROJECT NO. 472-82966

MICHAEL E. LINDEBAK, CITY ENGINEER

OCA NO. 706747

PHASE II

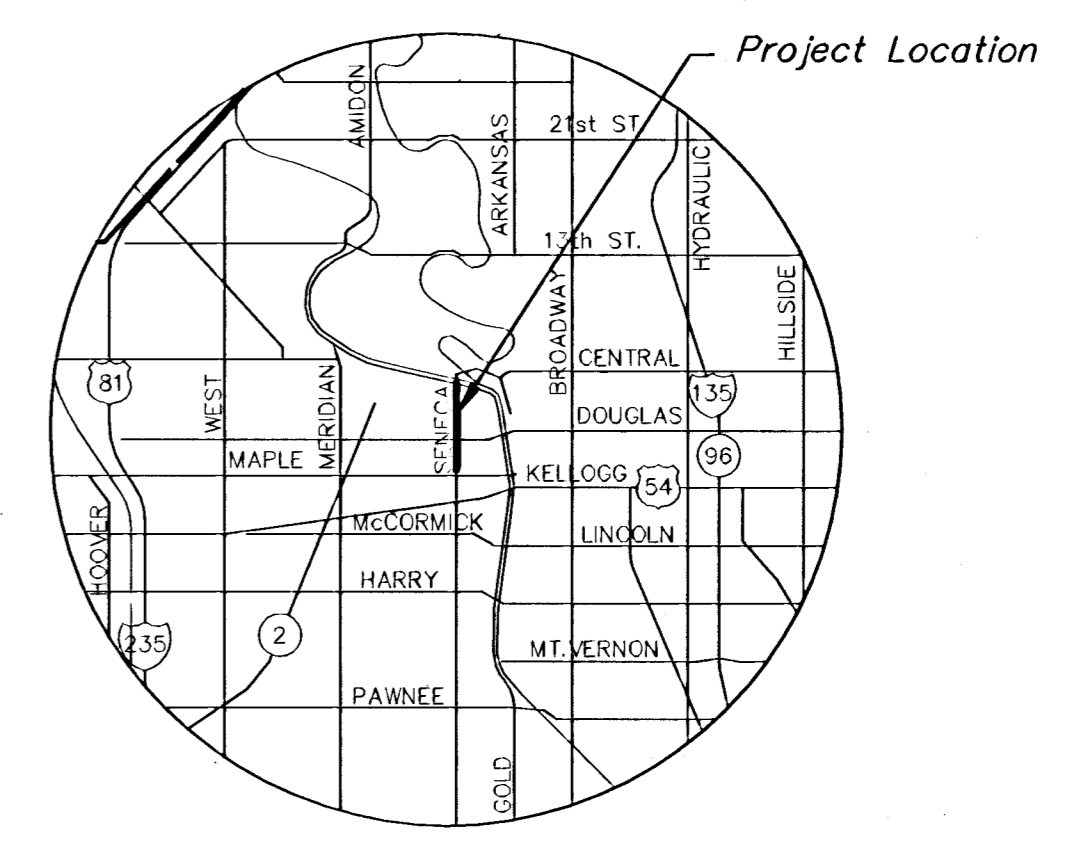

LOCATION MAP

**INDEX TO DRAWINGS**

SHEET NO.	DESCRIPTION
1	TITLE SHEET
LP1-LP7	LANDSCAPE PLANS
LI1-LI6	IRRIGATION PLANS
E1-E5	ELECTRICAL PLANS

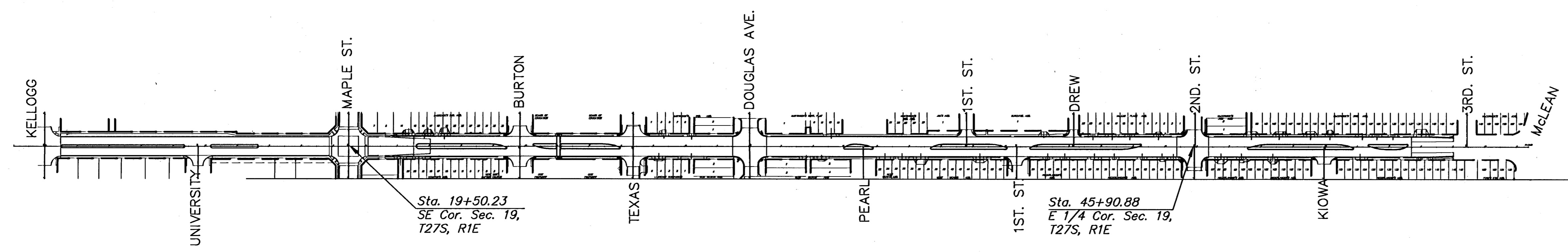

**BENCHMARKS**

- BM #2 COW BENCHMARK, 39.0' WEST AND 32.6' SOUTH OF CENTERLINE, SENECA AND MAPLE. ELEV.=109.78
- BM #3 CHISELED "L" TC, 20.1' EAST AND 36.1' SOUTH OF CENTERLINE, SENECA AND TEXAS. ELEV.=111.53
- BM #3A CHISELED "+", CENTERLINE 4' CONCRETE SIDEWALK, SOUTHEAST CORNER OF SENECA AND BURTON, WEST SIDE BAPTIST CHURCH. ELEV.=111.65
- BM #4 CHISELED "+", TOP OF SOUTHWEST BOLT, RR SIGNAL LIGHT, 24.5' WEST AND 380' NORTH OF CENTERLINE SENECA AND DOUGLAS. ELEV.=115.36
- BM #4A CHISELED "L" SOUTHEAST CORNER CONCRETE CURB INLET ON NORTHWEST CORNER SENECA AND DOUGLAS. ELEV.=112.56
- BM #4B CHISELED "L" TOP NORTHEAST CORNER 2.3' x 2.3' CONCRETE FLAGPOLE BASE, JAMES ALLISON SCHOOL. ELEV.=111.84
- BM #5 CHISELED "L" TOP OF EAST SIDE, 24" DIAMETER CONCRETE BASE, NORTHWEST CORNER, JOE'S EXPRESS LUBE AND OIL. ELEV.=116.94
- BM #6A RR SPIKE IN SOUTH SIDE OF 2ND. PP NORTH OF THE NORTHWEST CORNER OF SECOND AND DODGE. ELEV.=111.86
- BM #7 CHISELED "L" TOP SOUTHEAST CORNER 4' x11' CONCRETE STOOP, SENECA VETERINARY CLINIC, 435 N. SENECA. ELEV.=112.65

\* Established by Larkin Associates, 3-5-92

Background Topography established by Larkin Associates, circa 1992, supplemented with vertical data obtained by MKEC, May 1999.

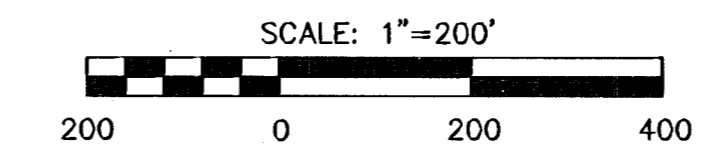
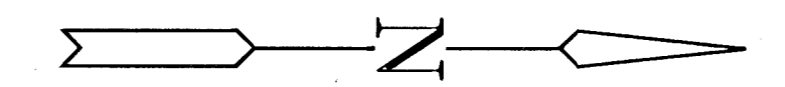

**SENECA PAVING PLANS**  
PROJECT NAME

---

**TITLE SHEET**  
SHEET TITLE

---

**GJA/KHB**      **DM**      **GJA/KHB**  
DESIGN BY.      DRAWN BY.      CHECKED BY.

---

**FEBRUARY 2003**      **98092ET**      **1 / 18**  
DATE      JOB NO.      SHEET/OF