

PLAN NOTES

1. E.C. SHALL COORDINATE ALL WORK WITH IRRIGATION CONTRACTOR.
2. E.C. SHALL USE EXISTING 6" SLEEVES BETWEEN ISLANDS AND CURB. E.C. SHALL REWORK THE EXISTING 6" SLEEVES TO ALLOW 36"-48" COVER.
3. E.C. SHALL MAINTAIN A MIN. COVER OF 36" OVER ALL U.G. CONDUITS. E.C. SHALL INCREASE CONDUIT COVER WITHIN THE STREET ISLANDS TO 48" MIN. TO CLEAR THE IRRIGATION AND TREE PLANTING EXCAVATION. MAINTAIN 12" CLEARANCE UNDER ALL IRRIGATION PIPING.
4. E.C. SHALL PROVIDE 1ea. 15 AMP 120 VOLT UNSWITCHED CIRCUIT TO THE IRRIGATION CONTROLLER. IRRIGATION CONTROL PROVIDED AND MOUNTED BY IRRIGATION CONTRACTOR.

NOTE: INSTALL POWER RECEPTACLE LOCATIONS AS INDICATED ON LANDSCAPE PLANS, RELATIVE TO TREE LOCATIONS.

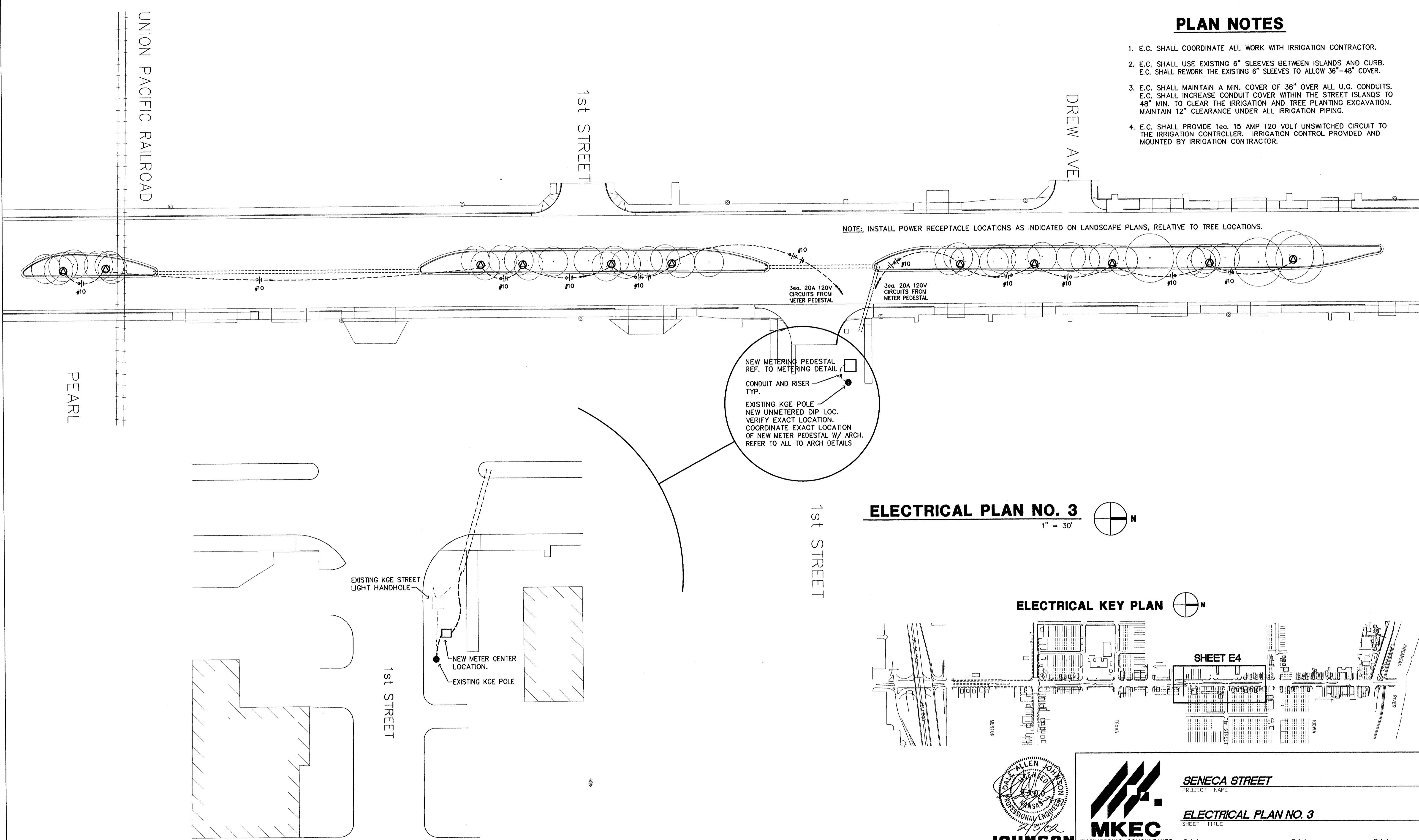

ELECTRICAL PLAN NO. 3

1" = 30'

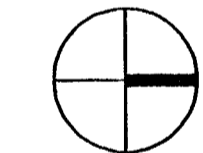

ELECTRICAL KEY PLAN

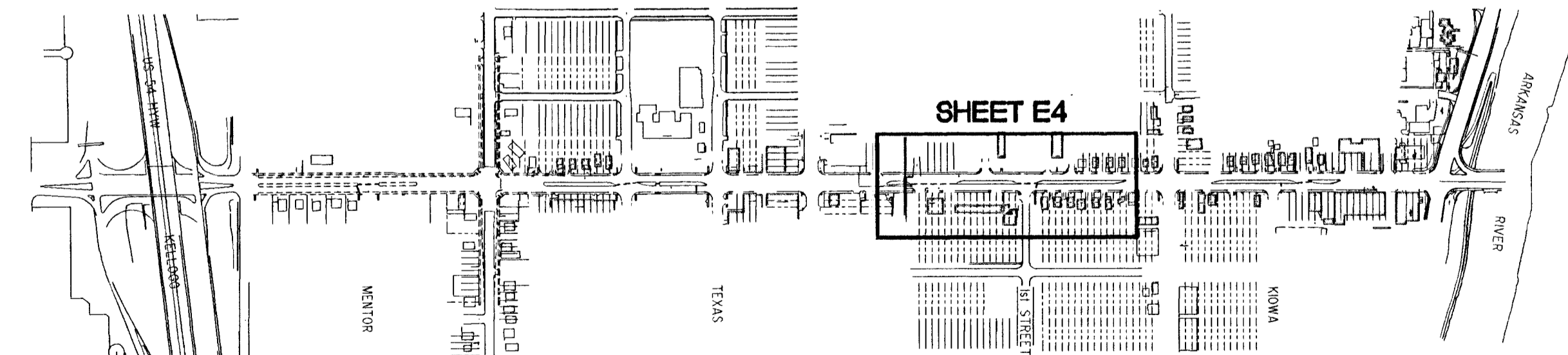
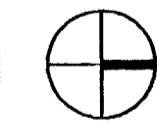

METER CENTER #3

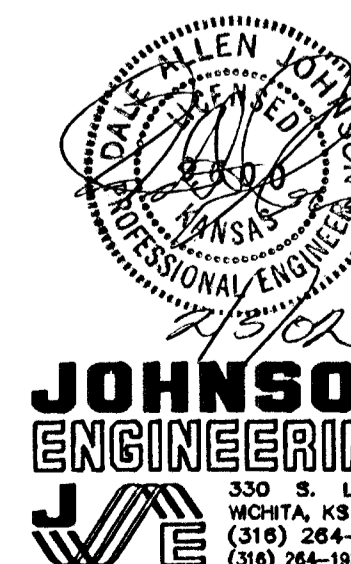

JOHNSON ENGINEERING
330 S. LAURA
WICHITA, KS 67211
(316) 264-1953
(316) 264-1956 FAX



MKEC
ENGINEERING CONSULTANTS
411 N. WEBB ROAD
WICHITA, KS. 67206
316-684-9600

SENECA STREET
PROJECT NAME

ELECTRICAL PLAN NO. 3
SHEET TITLE

DAJ DESIGN BY DAJ DRAWN BY DAJ CHECKED BY

2/3/03 DATE E4 DRAWING NAME E4 / 5 SHEET / DF