

PROJECT NO.	SHEET NO.	TOTAL SHEETS
472-83468	8	55

STREET	STATION	OFFSET	PROPOSED ELEVATION
BRACKEN	20+34.76	25.0' Lt.	1362.2

SCALE: 1"=20'

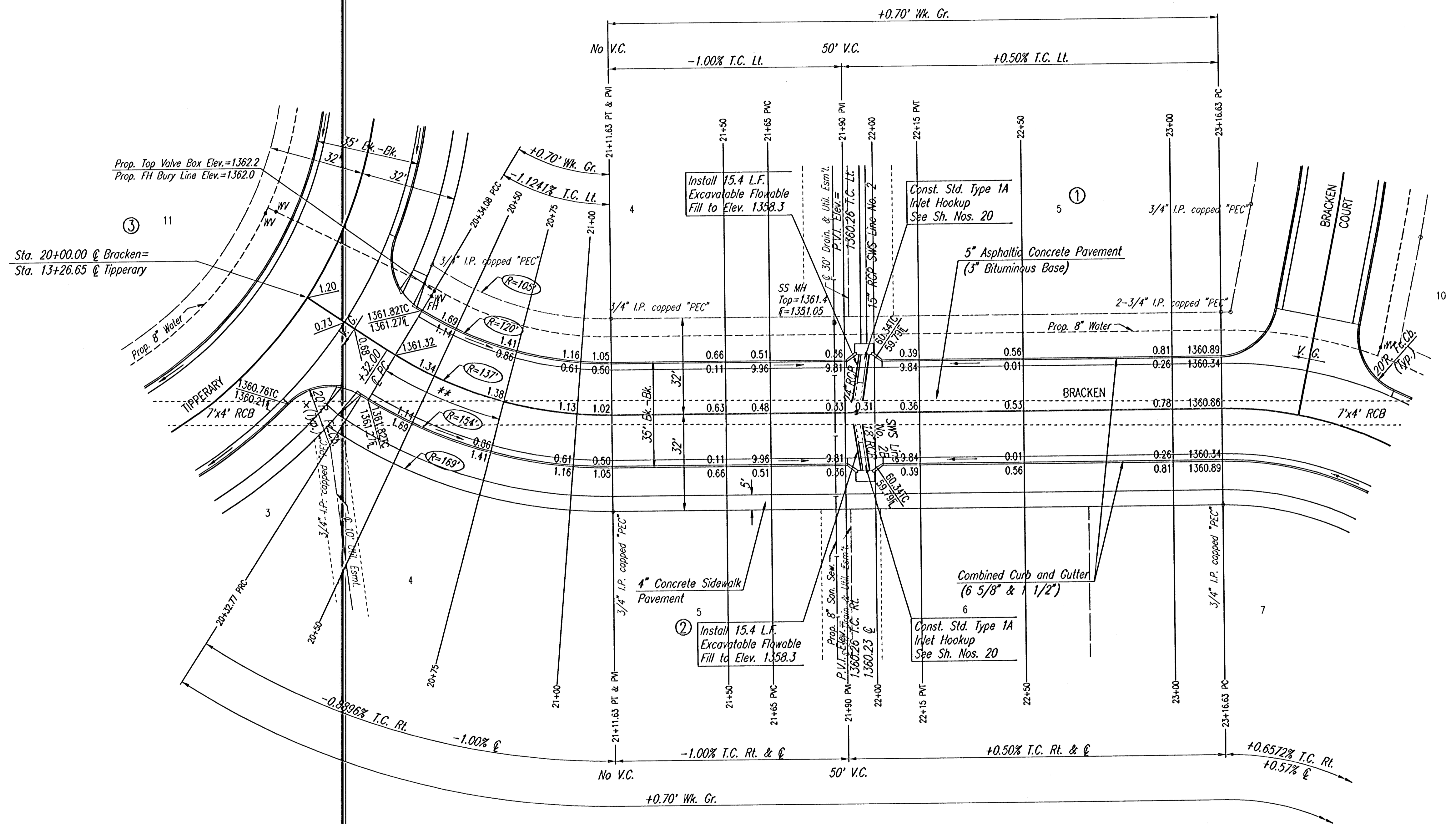

\*\* TRANSITION FROM NO CROWN LT. AND RT. TO 3/8" X-SLOPE LT. AND RT.

$\Delta=33^{\circ}18'15"$	$D=41^{\circ}49'18"$	$R=137'$	$L=79.63'$	$T=40.98'$	$E=6.00'$	
CURVE DATA BASED ON $\Delta/2=16^{\circ}39'07"$						
STATION	ARC LENGTH	FACE CURB LEFT	FACE CURB RIGHT	CHORD LENGTH	DEFLECTION ANGLE	TOTAL DEFLECTION
20+32					0°00'00"	0°00'00"
20+32.77	0.77'	0.70'	0.85'	0.65'	0°09'39"	0°09'39"
20+34.08	1.31'	1.19'	1.44'	1.10'	0°16'26"	0°26'05"
20+50	15.92'	14.44'	17.55'	13.38'	3°19'44"	3°45'50"
20+75	25.00'	22.88'	27.55'	20.98'	5°13'40"	8°59'50"
21+00	25.00'	22.88'	27.55'	20.98'	5°13'40"	14°13'09"
21+11.63	11.63'	10.56'	12.82'	9.76'	2°25'58"	16°39'07"
TOTAL	79.63'	72.25'	87.77'			

Defl./lt.=12.324916 min.

DSNR: DEP OPER: SAD SCALE: 1"=20.00  
 C:\2001\101545\1000\BRACKEN\20-23 03-13-2002 04:05:35 pm

BALTHROP 4TH ADDITION

**BRACKEN**  
STA. 20+00.00 TO STA. 23+16.63

**Professional Engineering Consultants, P.A.**  
303 S. TOPEKA • WICHITA, KANSAS 67202  
316-262-2691 • FAX 316-262-3003

Designed by	BER	Checked by	
Drawn by	DEP	Date	FEB. 2002
		Job No.	01545