

TRENCH DETAIL

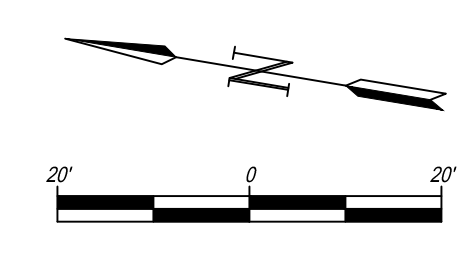

CAUTION!
EXISTING OVERHEAD ELECTRIC

CAUTION!
EXISTING SANITARY SEWER

REMOVE AND RESET RETAINING WALL BLOCKS AS NECESSARY FOR CONSTRUCTION (BOTH SIDES) INCIDENTAL TO BID ITEM FOR SITE RESTORATION

INSTALL 18.0 L.F. OF HANDRAIL ON HUBGUARD

REMOVE & REPLACE 16 SF THICK RED TINTED, CONCRETE SIDEWALK (6") TO NEAREST JOINT.

REMOVE AND REPLACE 57 LF 6" CURB (EACH SIDE)

REMOVE AND REPLACE 80 SF CONCRETE SIDEWALK (4") TO NEAREST JOINT AS NECESSARY FOR BOX INSTALLATION

INSTALL 33 S.Y. L.S. RIP-RAP.

REMOVE 165 SY EXISTING PAVEMENT AS INDICATED.

INSTALL 165 S.Y. 7" REINFORCED CONCRETE PAVEMENT (W4XW4 6X12) OVER REINFORCED CRUSHED ROCK BASE (SEE NOTES)

INSTALL 10'X3' TYPE 1 INLETS ON EACH SIDE OF ROADWAY. SEE PROFILES BELOW

REMOVE EXISTING CURB INLETS (4 Locations)

REMOVE 152 LF EXISTING 54X39 HECMP AND SLOPE STABILIZATION ON BOTH ENDS

INSTALL 41 S.Y. L.S. RIP-RAP.

HYDRO-EXCAVATION LOCATION TOP OF EXIST. WATER ELEV. = 1344.63 DATE = 02/28/2024

REMOVE AND REPLACE 88 SF CONCRETE SIDEWALK (4") TO NEAREST JOINT AS NECESSARY FOR BOX INSTALLATION

CAUTION!
EXISTING AT&T & FIBER OPTIC CABLE

CAUTION!
EXISTING WATER LINE

STA. 0+00, LINE 2
INSTALL PRECAST DOUBLE 7'x3' RCB W/ CAST-IN-PLACE WINGWALLS 8"50' SKEW
SEE DETAILS, SHEET 5

INSTALL EROSION CONTROL MAT, CURLEX II OR APPROVED EQUAL IN ALL DISTURBED AREAS

NOTES

- 7" REINFORCED CONCRETE PAVEMENT (W/5" REINFORCED ROCK BASE) SHALL BE INSTALLED IN ALL AREAS WHERE PAVEMENT IS REMOVED. THICKENED PAVEMENT OVER BOX SHALL BE SUBSIDIARY TO THE BID ITEM FOR 5" REINFORCED CRUSHED ROCK BASE.
- INSTALL PRECAST BOXES WITH 1" SEPARATION BETWEEN AND PLACE GROUT OR FLOWABLE FILL BETWEEN BOXES. CONTRACTOR MAY NEED TO PARTIALLY BACKFILL AROUND BOXES FOR STABILITY PRIOR TO GROUTING.
- CONTRACTOR SHALL INSTALL GEOTEXTILE FABRIC SUITABLE FOR BRIDGE BACKWALL PROTECTION BETWEEN BOX AND PAVEMENT.
- BACKFILL TRENCH ON BOTH SIDES OF BOX WITH FLUSHED AND VIBRATED SAND (SEE DETAIL). SUBSIDIARY TO THE BID ITEM FOR "PIPE, RCBC"
- REGRADE CHANNEL AS INDICATED. 3:1 MAXIMUM SIDE SLOPES UNLESS PROTECTED BY LIGHT STONE RIP-RAP.
- RETAINING WALL BLOCKS THAT ARE NOT RESET DURING CONSTRUCTION SHALL BE REMOVED FROM THE SITE BY THE CONTRACTOR.
- REMOVAL OF EXISTING CURB INLETS, PIPE AND STONE RETAINING WALLS SHALL BE SUBSIDIARY TO BID ITEM "REMOVAL OF EXISTING STRUCTURES".
- THERE ARE NO ACTIVE EVERGY LINES ANTICIPATED WITHIN THE PROJECT LIMITS. IF ACTIVE OR INACTIVE LINES ARE EXPOSED DURING CONSTRUCTION, CONTRACTOR SHALL CONTACT SHANE PRICE (316-706-6702) OR LADONNA VANDERFORD (316) 250-8963 TO COORDINATE REMOVAL.

© 2024 GARVER, LLC
THIS DOCUMENT, ALONG WITH THE IDEAS AND DESIGNS CONVEYED HEREIN, SHALL BE CONSIDERED INSTRUMENTS OF PROFESSIONAL SERVICE AND ARE PROPERTY OF GARVER, LLC. ANY USE, REPRODUCTION, OR DISTRIBUTION OF THIS DOCUMENT, ALONG WITH THE IDEAS AND DESIGN CONTAINED HEREIN, IS PROHIBITED UNLESS AUTHORIZED IN WRITING BY GARVER, LLC OR EXPLICITLY ALLOWED IN THE GOVERNING PROFESSIONAL SERVICES AGREEMENT FOR THIS WORK.

1995 Midfield Road
Wichita, Kansas 67209

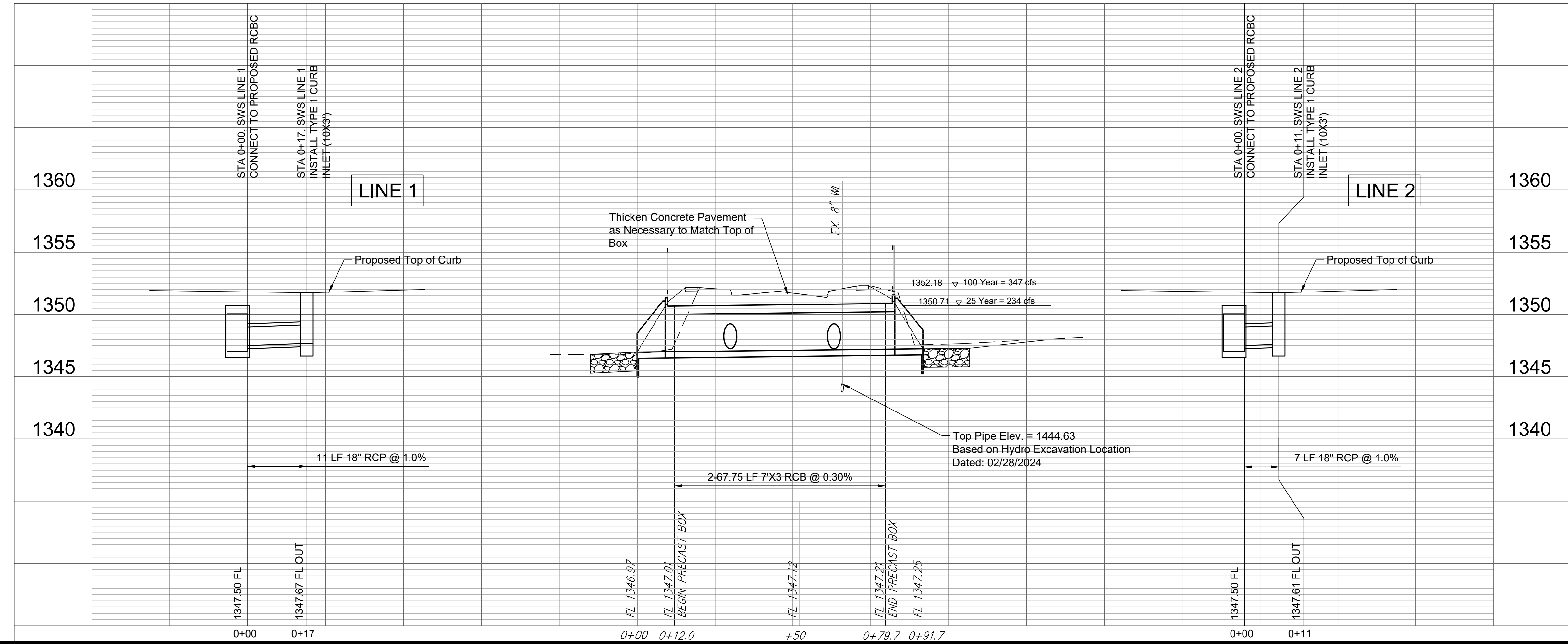

File: L:\2024\141-2302463 - Greenbriar Box Drawings\DESIGN\3886D Greenbriar Engineering Base.dwg, Last Save: 3/29/2024 9:26 AM, Last saved by: KWL/lee, Last plotted by: Lee, Ken W., Plot Style: ---, Plot Scale: 1:2,849, Plot Date: 3/29/2024 12:25 PM, Plotter used: None

REV.	DATE	DESCRIPTION	BY

CITY OF WICHITA
KANSAS

GREENBRIAR BOX REPLACEMENT

Greenbriar Plan

JOB NO.: 19T41013
DATE: JUNE 2019
DESIGNED BY: KWL
DRAWN BY: KWL

BAR IS ONE INCH ON ORIGINAL DRAWING
IF NOT ONE INCH ON THIS SHEET, ADJUST SCALES ACCORDINGLY.

DRAWING NUMBER

SHEET NUMBER **2** OF **10**