

WATER SERVICE LINES REMOVED FROM DRAWING PER CITY OF WICHITA.

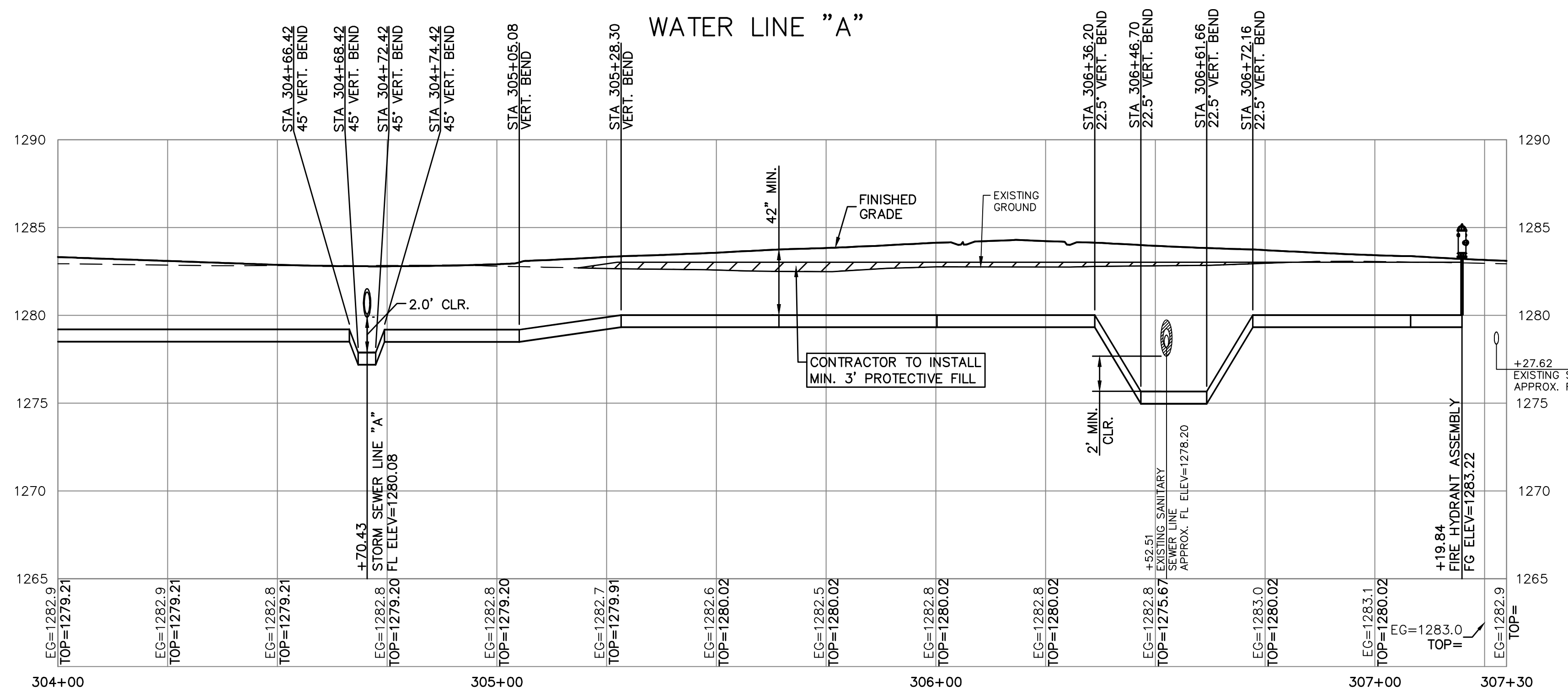

CS	SMM	SMW	SMW
TDA	SMM	SMW	SMW
DSN	SMW	SMW	SMW
DWN	SMW	SMW	SMW
CHK	SMW	SMW	SMW

REV	DATE	DESCRIPTION
1	04/16/24	RFI & CITY COMMENTS
0	03/01/24	BIDDING

SUNDIATA MARCELIN
ENGINEER
KS # 29546

KAW VALLEY ENGINEERING
KAW VALLEY ENGINEERING, INC., IS AUTHORIZED TO OFFER ENGINEERING SERVICES BY KANSAS STATE CERTIFICATE OF AUTHORIZATION # E-113. EXPIRES 12/31/24

MAC MERIDIAN ADDITION
WEST MACARTHUR ROAD
WICHITA, KANSAS 67217

WATER LINE IMPROVEMENTS
WATER LINE "A" - PLAN & PROFILE

PROJ. NO.	G21D1997
DESIGNER	SMM
DRAWN BY	TDA
CFN	1997WPP
SHEET	03
REV	1

THIS DRAWING SHALL NOT BE UTILIZED BY ANY PERSON, FIRM, OR CORPORATION IN WHOLE OR IN PART WITHOUT THE SPECIFIC PERMISSION OF KAW VALLEY ENGINEERING, INC.