

EROSION CONTROL MEASURE	INSTALL	MAINTAIN	REMOVE
BACK OF CURB PROTECTION (LF)	3,462	0	0
CONSTRUCTION ENTRANCE (EA)	0	1	0
CURB INLET BARRIER (EA)	4	0	0
DITCH CHECK (EA)	3	0	0
DROP INLET PROTECTION (EA)	2	0	0
EROSION CONTROL (LS)	0	0	0
EROSION CONTROL BERM (LF)	0	0	0
SILT FENCE (LF)	1,060	0	0
EROSION CONTROL MAT (SY)	0	0	0

QUANTITIES ARE FOR INFORMATION ONLY. CONTRACTOR SHALL VERIFY QUANTITIES PER FINAL BID QUANTITY SHEET.

* ALL EXISTING BMPs INCLUDING CONSTRUCTION ENTRANCE, SEDIMENT BARRIERS, SILT FENCE, EROSION CONTROL BERM, AND EROSION CONTROL MAT SHALL BE MAINTAINED AND REPAIRED IF NECESSARY. REPLACEMENT OR REMOVAL OF EROSION CONTROL MEASURES TO BE PAID FOR BY L.S. BID ITEM "MAINTAIN EXISTING BMPs"

Area to be graded $\frac{1}{8}''$ Proposed Grades

Approximate Easement Grading Quantities:

(For Information Only)
Excavation: 3,065 C.Y.
Fill: 1,151 C.Y.

Lot fill area

The contractor shall fill and grade the easements as shown to the elevations given on the easement grading plan. All costs for grading shall be incidental to the "Grading, Easement" bid item. The contractor shall "straight" grade the easements between the elevations given. Where a callout designates "Match", the contractor will grade to the existing ground elevation.

Any excess excavation from street grading and easement grading shall be used to fill hatched lot fill area. Fill for lot areas shall be included in bid item "Grading, Mass." Compaction of 95% Standard Proctor Density shall be obtained in all lot fill areas. Fill from on-site excavation shall be placed in 8" maximum thickness lifts within 0% to +4% of optimum moisture content of the soil at the time of placement. Testing shall be done at one location for each of the 7 lots for each lift. All testing shall be incidental to Lump Sum bid item "Testing".

BERM NOTE:

Contractor shall strip 4-6" of top soil within Res. "B" in area of proposed berm prior to berm construction and stockpile. Topsoil shall be spread over berm. Berm shall be seeded per cover sheet general notes. Cost of berm construction shall be included in bid item "Grading, Mass."

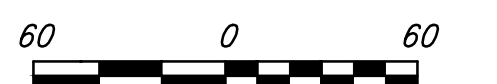

Scale: 1"=60'

---100--- Existing Grade

EROSION CONTROL PLAN LEGEND

- DROP INLET PROTECTION
- CURB INLET PROTECTION
- DITCH CHECKS
- SILT FENCING
- STRAW WATTLE DITCH CHECKS
- EROSION CONTROL BERM
- BACK OF CURB PROTECTION
- EROSION CONTROL MAT
- TEMPORARY DITCH

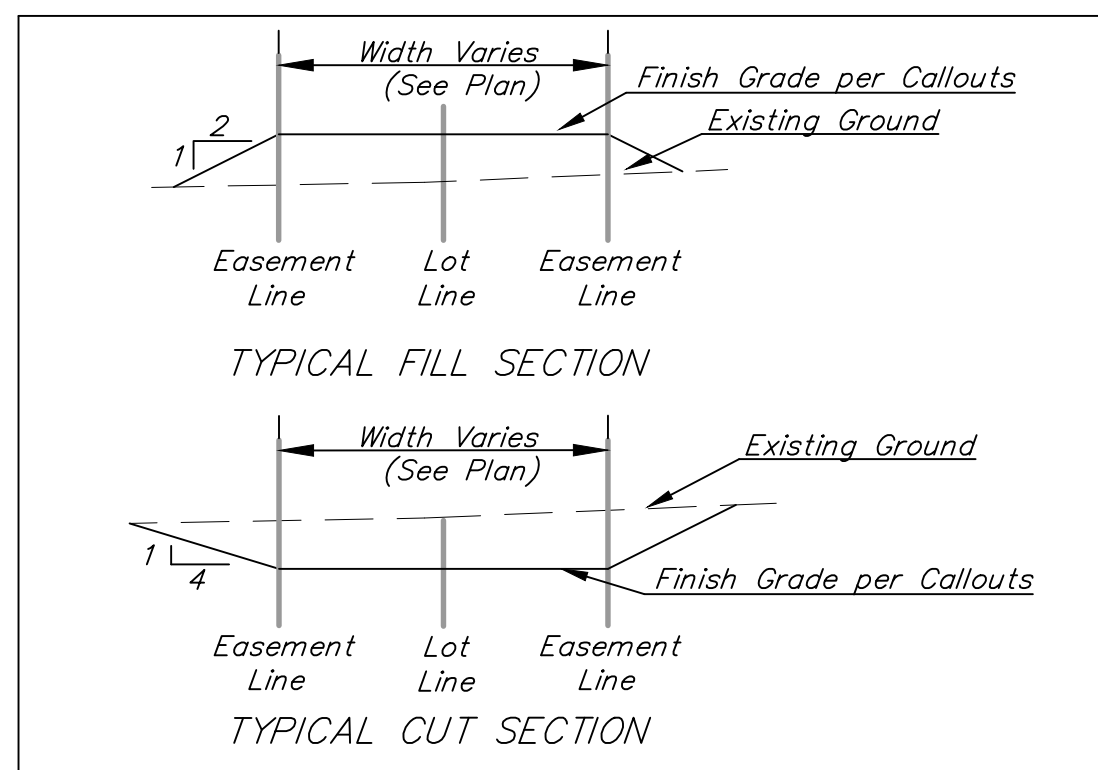

SECTION A-A

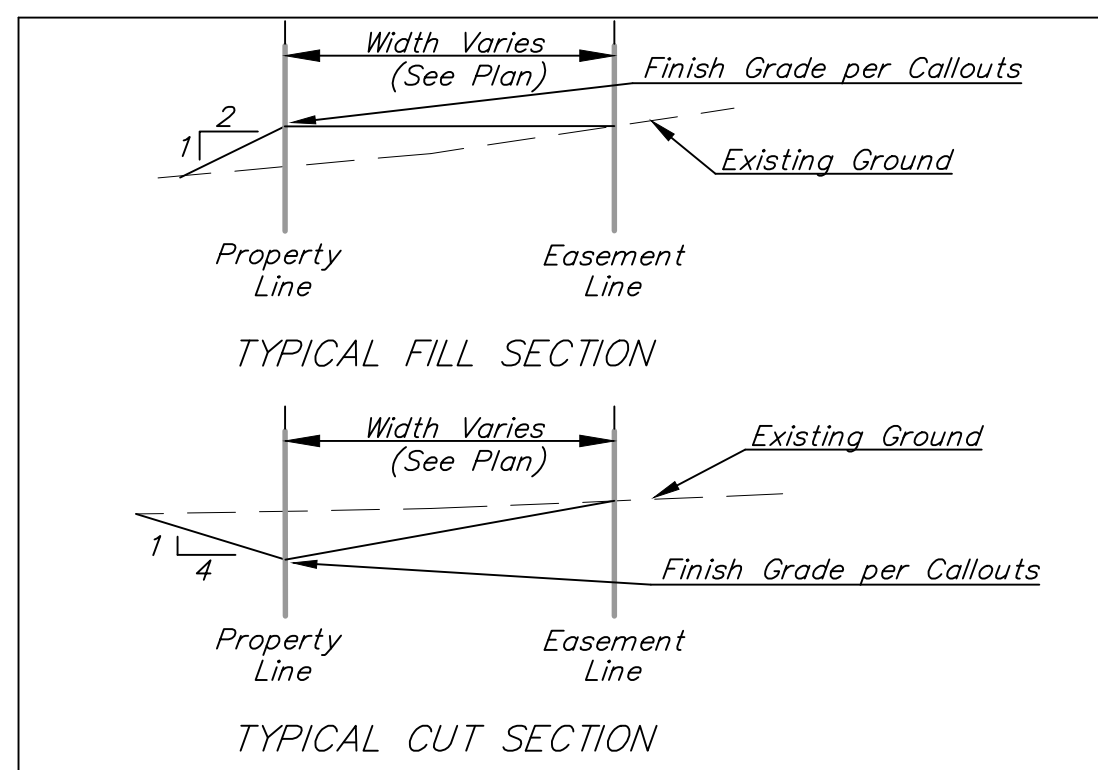

SECTION B-B

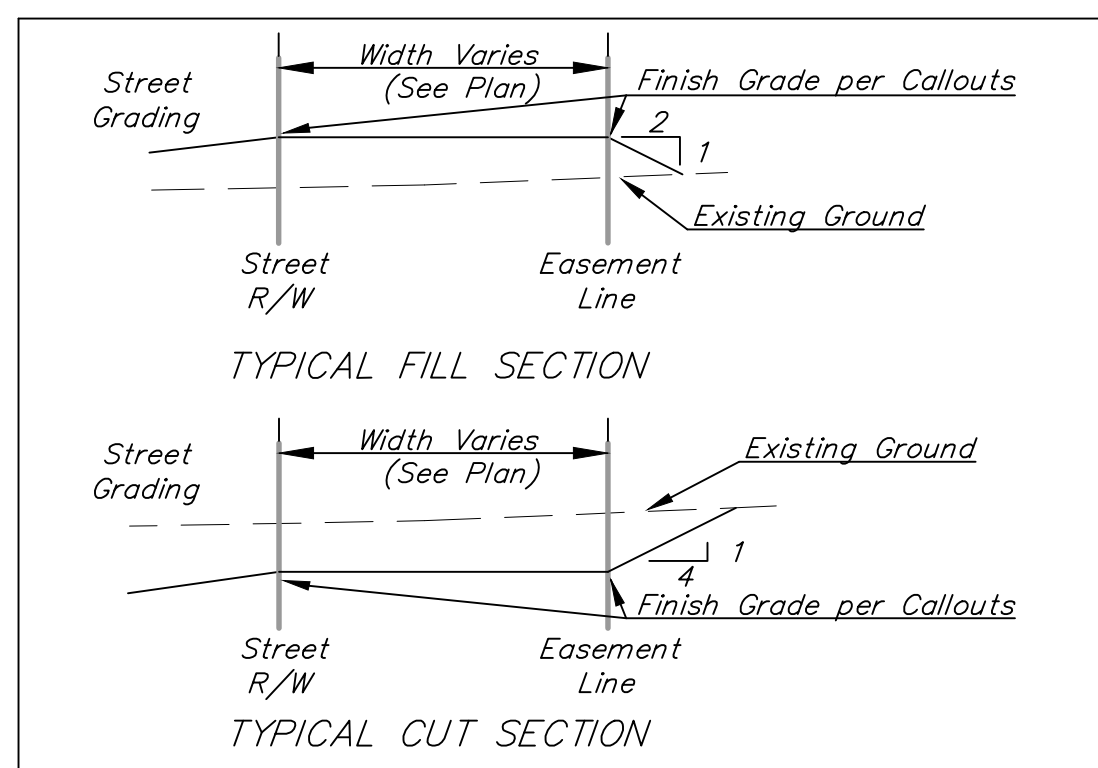

SECTION C-C

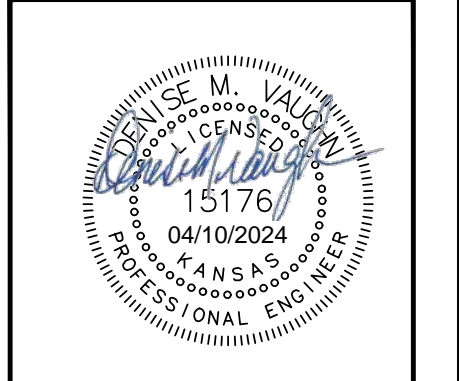
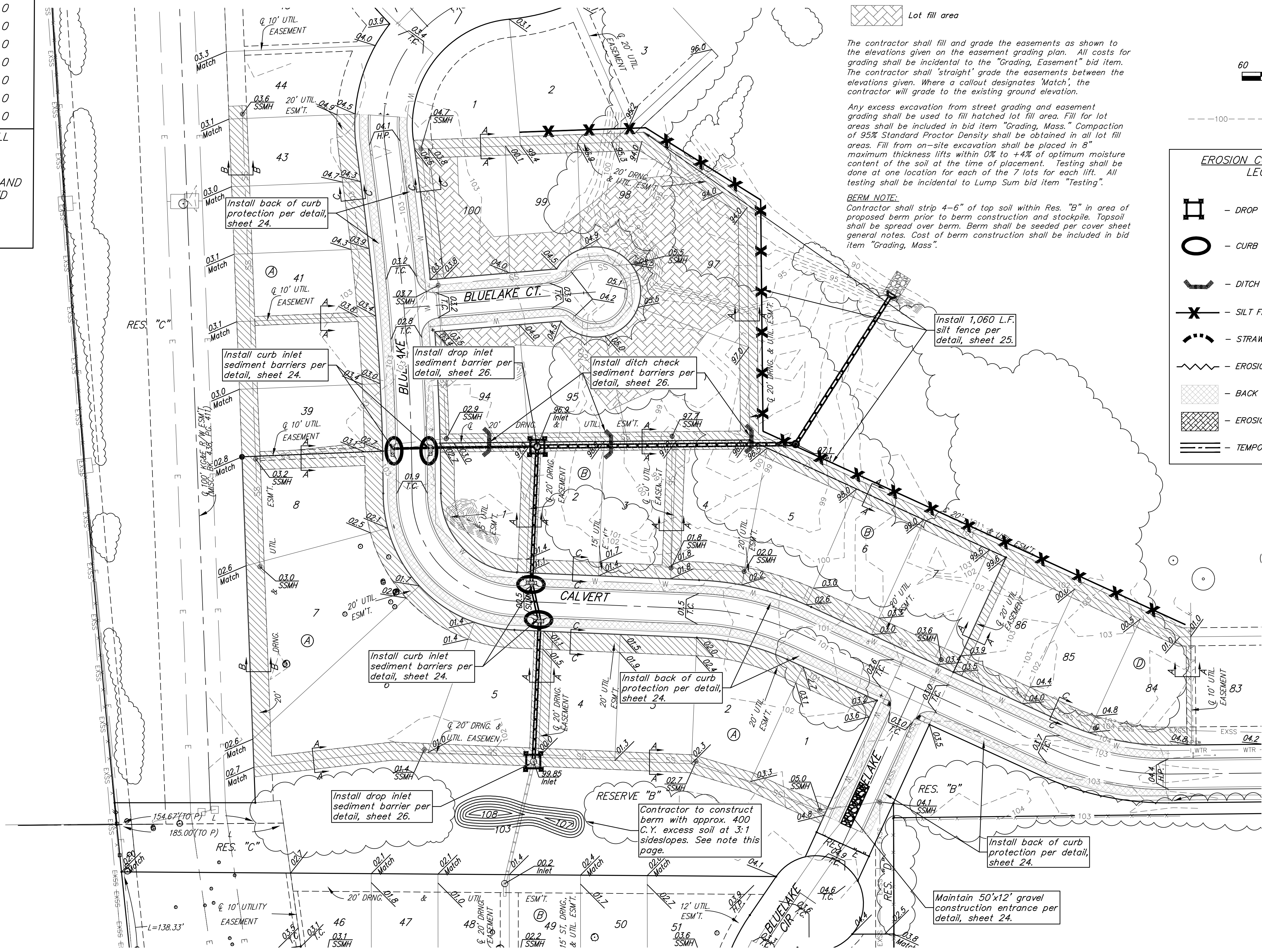

BAUGHMAN COMPANY

315 Ellis St.
Wichita, KS 67211
316-262-7271
BaughmanCo.com

BLUE LAKE ADD./2ND ADD.
PHASE 1

EROSION CONTROL & ESMT. GRADING PLAN

STREET & SWS IMPROVEMENTS

PROJECT NUMBER:
472-2023-085885

DESIGN: DRAWN:

DATE: April 10, 2024

SHEET **11** OF **37**

File: E:\Projects\Blue Lake 2nd Addition\Engineering\Phase 1\15176\15176.dwg