

BENCHMARKS:
 BM #1 - "□" on top of curb,
 north side of Calvert, 14.7' south of
 the most southerly corner common
 to Lots 83 and 84, Block D, Blue
 Lake Addition.
 Elev. = 103.95 City Datum

BM #2 - "□" with + cut on
 northwest face of drop inlet on
 north side of MacArthur Road, 79.4'
 North of centerline of MacArthur
 Road and 152.3' E/SE of southwest
 corner of Reserve "C", Blue Lake
 3rd Addition.
 Elev. = 95.55 City Datum

WATER VALVE LOCATION TABLE

VALVE NUMBER	STREET	BASELINE STATION	OFFSET DISTANCE	OFFSET DIRECTION
V7	Bluelake Ct.	1+96.76	39.73'	Lt.

Paving contractor will be responsible to operate all water valves on the project, in the presence of the inspector, to ensure accessibility to the valves, and that all valves (except blowoffs) are left in the "ON" position when the project is completed.

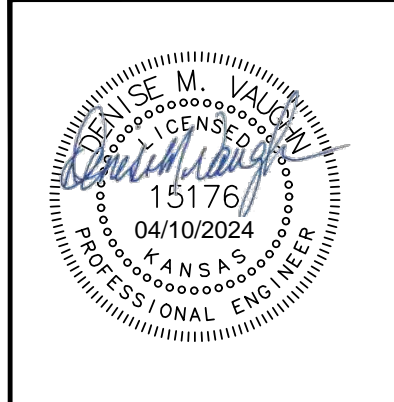
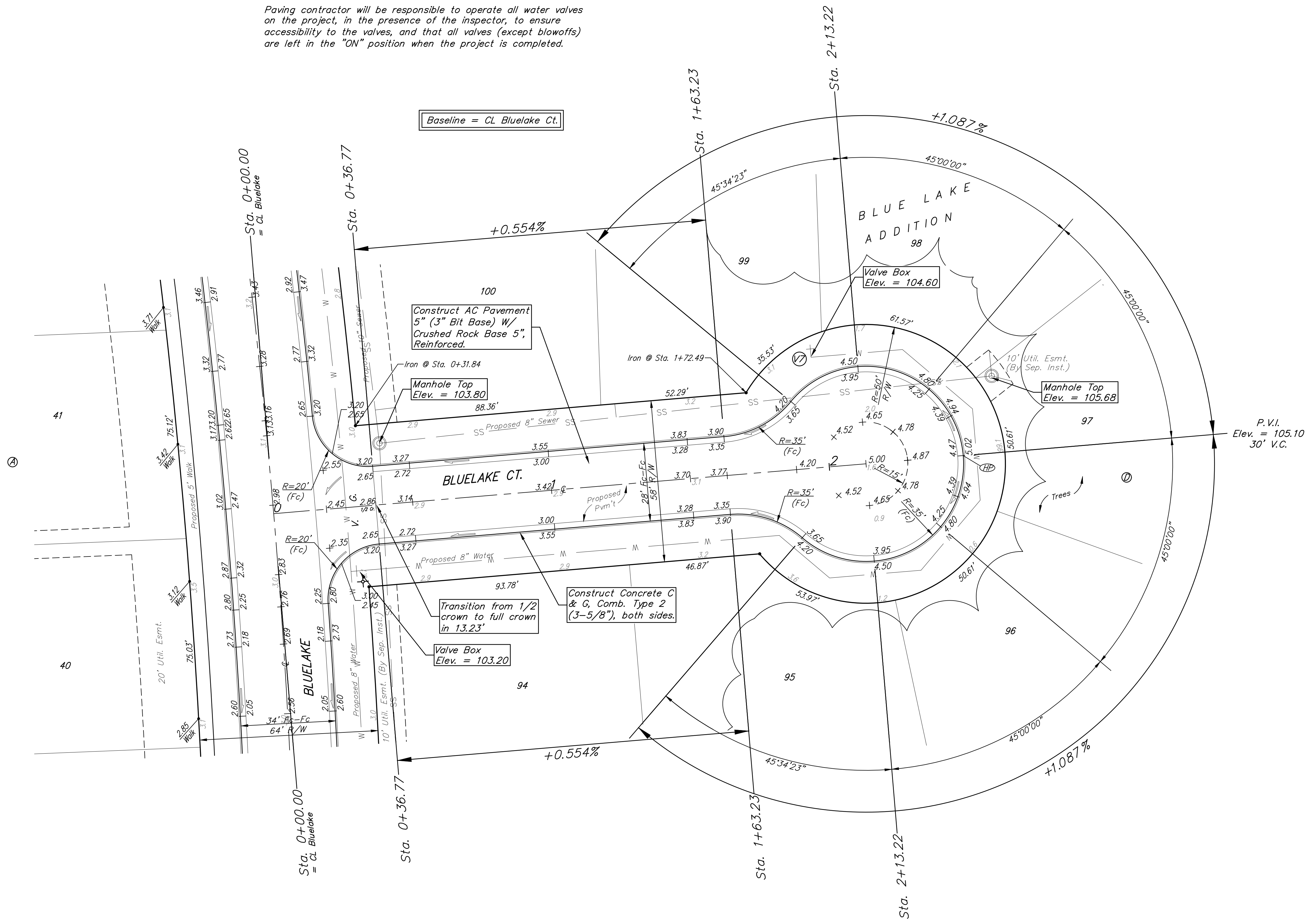
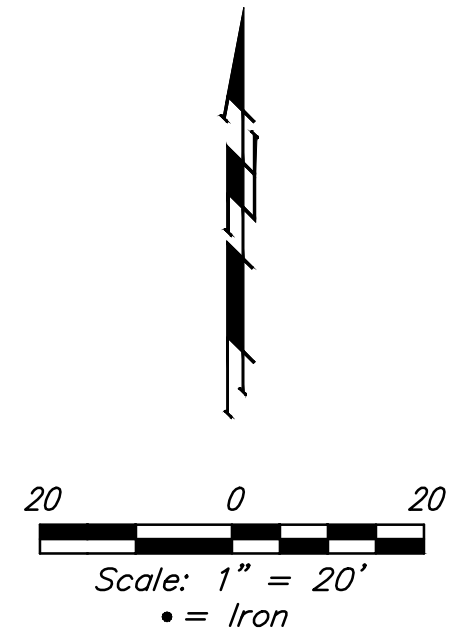

BAUGHMAN COMPANY
 315 Ellis St.
 Wichita, KS 67211
 316-262-7271
 BaughmanCo.com

BLUE LAKE ADD./2ND ADD.
 PHASE 1

BLUELAKE CT.

STREET & SWS
 IMPROVEMENTS

PROJECT NUMBER:
 472-2023-085885

DESIGN: AEG DRAWN: TMS
 DATE: April 10, 2024

SHEET **7** OF **37**

NOTE: ROLL TYPE CURB & GUTTER (TYPE 2) TO BE CONSTRUCTED ON THE PAVEMENT SHOWN ON THIS SHEET. TOP OF CURB ELEVATIONS ARE GIVEN FOR FULL HEIGHT CURB (TYPE 4).

File: E:\Projects\Blue Lake 2nd Addition\Engineering\Phase 1\1St\SW\23-03-E461\1St\SW\SW.dwg