

Revision Schedule

No.	Date	Description

**L.W. CLAPP PARK**  
 CITY OF WICHITA  
 4611 E HARRY STREET  
 WICHITA, KS 67218

Project Number	19305
Issue	100% CONSTRUCTION DOCUMENTS
Date	2024-01-26

LANDSCAPE PLAN

**L100**

**PLANTING NOTES**

- SOD ALL AREAS WITHIN CONTRACT LIMITS, NOT COVERED BY PAVING, BUILDINGS, OR PLANTING BEDS, UNLESS OTHERWISE NOTED.
- PLANT QUANTITIES ARE FOR INFORMATION ONLY; DRAWING SHALL PREVAIL IF CONFLICT OCCURS.
- NOTIFY LANDSCAPE ARCHITECT AFTER STAKING IS COMPLETED AND BEFORE PLANT PITS ARE EXCAVATED.
- CONTRACTOR SHALL PLACE SHREDDED BARK MULCH AROUND ALL TREES AND IN ALL PLANTING BEDS TO A DEPTH OF 3".
- KIND, SIZE AND QUALITY OF PLANT MATERIAL SHALL CONFORM TO AMERICAN STANDARDS FOR NURSERY STOCK, ANSI 260-1992, OR MOST RECENT EDITION.
- THE CONTRACTOR SHALL REPORT SUBSURFACE SOIL OR DRAINAGE PROBLEMS TO THE LANDSCAPE ARCHITECT.
- THE CONTRACTOR SHALL SHOW PROOF OF PROCUREMENT, SOURCES, QUANTITIES AND VARIETIES FOR ALL SHRUBS, PERENNIALS, ORNAMENTAL GRASSES, AND ANNUALS WITHIN 21 DAYS FOLLOWING THE AWARD OF CONTRACT. TIMELY PROCUREMENT OF ALL PLANT MATERIAL IS ESSENTIAL TO THE SUCCESSFUL COMPLETION AND INITIAL ACCEPTANCE OF THE PROJECT.
- SUBSTITUTIONS SHALL ONLY BE ALLOWED WHEN THE CONTRACTOR HAS EXHAUSTED ALL SOURCES FOR THE SPECIFIED MATERIAL, AND HAS PROVEN THAT THE SPECIFIED MATERIAL IS NOT AVAILABLE. THE CONTRACTOR MUST PROVIDE NAME AND VARIETY OF SUBSTITUTION TO THE LANDSCAPE ARCHITECT FOR APPROVAL PRIOR TO TAGGING OR PLANTING. SUBSTITUTIONS SHALL BE NEAREST EQUIVALENT SIZE OF VARIETY OF PLANT HAVING SAME ESSENTIAL CHARACTERISTICS.
- ALL PLANT MATERIAL SHALL BE NURSERY GROWN, SOUND, HEALTHY, VIGOROUS AND FREE FROM INSECTS, DISEASE AND INJURIES, WITH HABIT OF GROWTH THAT IS NORMAL FOR THE SPECIES. SIZES SHALL BE EQUAL TO OR EXCEEDING SIZES INDICATED ON THE PLANT LIST. THE CONTRACTOR SHALL SUPPLY PLANTS IN QUANTITY AS SHOWN ON THE DRAWINGS.
- STAKE OR PLACE ALL PLANTS IN FIELD AS INDICATED ON THE DRAWINGS OR AS DIRECTED BY THE LANDSCAPE ARCHITECT FOR APPROVAL BY THE OWNER PRIOR TO PLANTING.
- ALL SOD AREAS TO HAVE 6" MINIMUM OF TOPSOIL.
- SOIL AMENDMENTS ARE TO BE PER RECOMMENDATIONS PER THE SOILS REPORT.
- ALL SOD AND SEED AREAS TO BE INSTALLED WITH WRANGLER BERMUDA (2LBS/1,000SF) AND ANNUAL RYE (1LB/1,000SF).
- CONTRACTOR TO CONDUCT A PRE-INSTALLATION MEETING.
- ALL DETENTION AREAS WITH SEED MIX TO BE HYDROSEDED; DETENTION AREAS TO THEN RECEIVE PLANT MATERIAL PLANTED 24" O.C. AT 25 LB/AC WITH HAY MAT TO BE PUT DOWN AFTER HYDROSEED.
- ALL NEW PLANTING AREAS TO HAVE 12" MINIMUM TOPSOIL.

**LANDSCAPE LEGEND**

- RE-ESTABLISH TURF ZONE (SEED)
- PRAIRIE MIX (.72 ACRES)  
 PV (18%) AO (16%) IV (16%)  
 JE (18%) LC (16%) VH (16%)
- LACEBARK ELM
- LONDON PLANE TREE
- RED OAK
- JAPANESE ZELKOVA
- CHINESE PISTACHE TREE
- AMERICAN SMOKE TREE

PLANT SCHEDULE						
KEY	QTY.	BOTANICAL NAME	COMMON NAME	SIZE	ROOT	SPACING & REMARKS
<b>LARGE DECIDUOUS TREE</b>						
PB	2	Platanus x acerifolia 'Bloodgood'	LONDON PLANETREE	2" CAL	B&B	SPECIMEN QUALITY
QR	10	Quercus rubra	RED OAK	2" CAL	B&B	SPECIMEN QUALITY
UP	20	Ulmus parvifolia 'Emerald Prairie'	LACEBARK ELM	2" CAL	B&B	SPECIMEN QUALITY
ZS	9	Zelkova serrata 'Village Green'	JAPANESE ZELKOVA	2" CAL	B&B	SPECIMEN QUALITY
TOTAL	41					
<b>SMALL DECIDUOUS TREE</b>						
CP	14	Chinese Pistache 'Keith Davey'	PISTACIA CHINENSIS	1.5" CAL	B&B	SPECIMEN QUALITY (MALE)
CS	6	Cotinus spp.	AMERICAN SMOKETREE	1.5" CAL	B&B	SPECIMEN QUALITY (MALE)
TOTAL	20					
<b>SHRUBS</b>						
CA	17	Cornus alba 'Prairie Fire'	PRAIRIE FIRE DOGWOOD	#3	CONT.	18" TALL AT TIME OF PLANTING
PO	26	Physocarpus opulifolius	NINEBARK	#3	CONT.	18" TALL AT TIME OF PLANTING
SJ	23	Spiraea japonica 'Little princess'	LITTLE PRINCESS SPIREA	#3	CONT.	18" TALL AT TIME OF PLANTING
TOTAL	66					
<b>PERENNIALS</b>						
EC	142	Echinacea 'Cheyenne Spirit'	CHEYENNE SPIRIT CONEFLOWER	#1	CONT.	24" O.C.
LS	100	Liatris spicata	BLAZING STAR	#1	CONT.	24" O.C.
PA	145	Perovskia atriplicifolia 'Rocket Man'	RUSSIAN SAGE	#1	CONT.	24" O.C.
AF	71	Sedum spectabile 'Autumn Fire'	AUTUMN FIRE SEDUM	#1	CONT.	24" O.C.
TOTAL	458					
<b>GRASSES</b>						
BG	96	Bouteloua gracilis 'Blonde Ambition'	BLONDE AMBITION BLUE GRAMA	1 GALLON	CONT.	24" O.C.
BC	95	Bouteloua curtipendula	SIDE-OATS GRAMA	1 GALLON	CONT.	24" O.C.
MS	118	Miscanthus sinensis 'Gracillimus'	MAINDEN-HAIR GRASS	1 GALLON	CONT.	24" O.C.
SS	64	Schizachyrium scoparium 'minnblueA' Blue Heaven	BLUE HEAVEN LITTLE BLUESTEM	1 GALLON	CONT.	24" O.C.
TOTAL	373					
<b>PRAIRIE MIX</b>						
AO	2559	Acorus gramineus 'Ogon'	GRASSY LEAVED SWEET FLAG	4" PLUG	CONT.	18" O.C.
IV	2560	Iris versicolor	BLUE FLAG IRIS	4" PLUG	CONT.	18" O.C.
JE	2886	Juncus effusus	COMMON RUSH	4" PLUG	CONT.	18" O.C.
LC	2559	Lobelia cardinalis	CARDINAL FLOWER	4" PLUG	CONT.	18" O.C.
PV	2886	Panicum virgatum	SWITCHGRASS	4" PLUG	CONT.	18" O.C.
VH	2558	Verbena hastata	AMERICAN BLUE VERVAIN	4" PLUG	CONT.	18" O.C.
TOTAL	16008					
<b>TURF SOD/SEED</b>						
	31,202 SF			2LBS/1000SF	SEED	
	16 LBS	Wrangler' Bermuda		2LBS/1000SF	SEED	
	32 LBS	Annual Rye		1LBS/1000SF	SEED	
TOTAL	48 LBS					

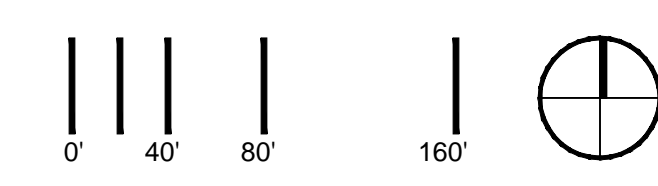
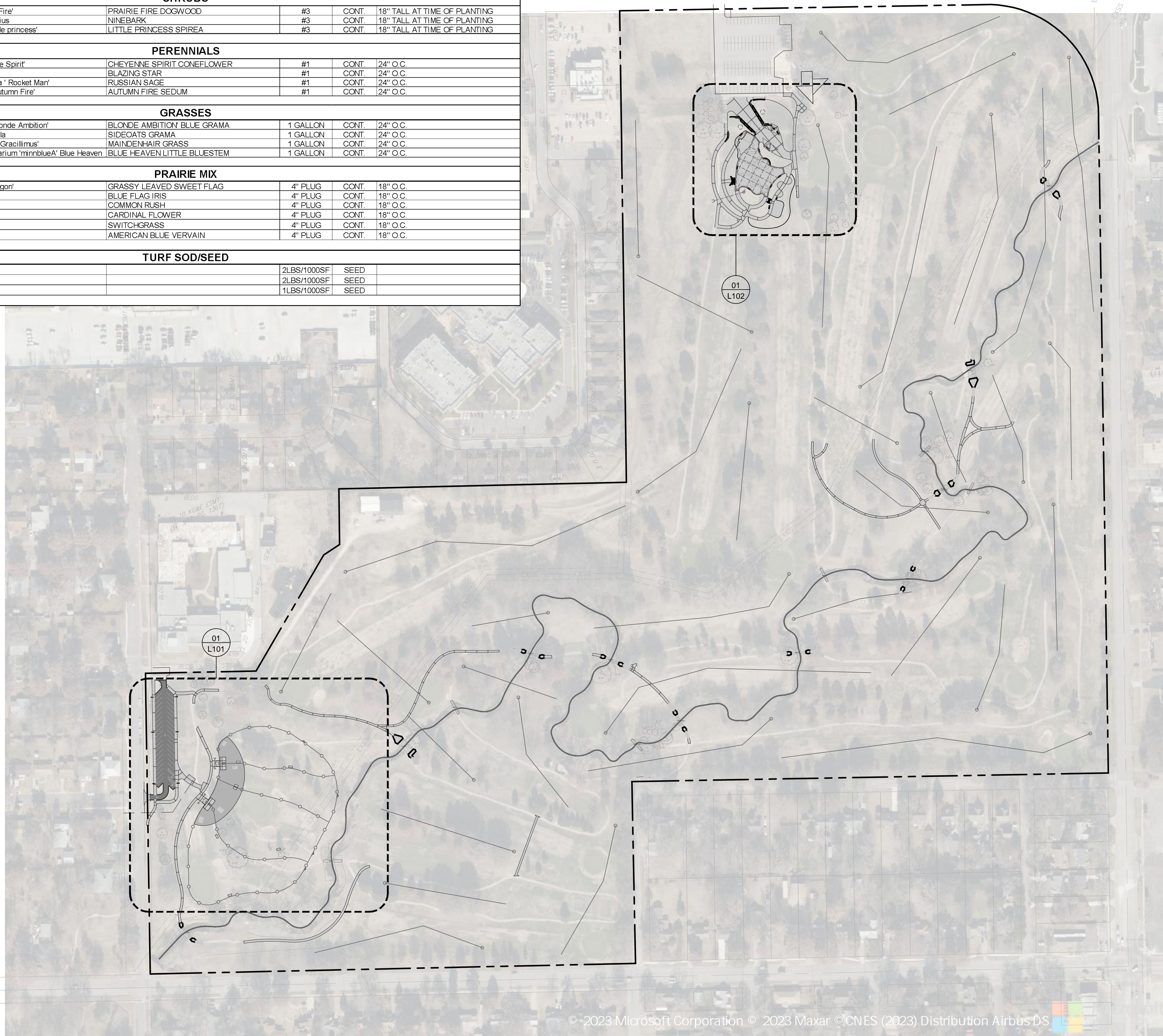

THE USER SHALL BE RESPONSIBLE FOR VERIFYING THE ACCURACY OF ALL INFORMATION AND DATA PROVIDED TO THE USER. THE USER SHALL BE RESPONSIBLE FOR VERIFYING THE ACCURACY OF ALL INFORMATION AND DATA PROVIDED TO THE USER.