

File: L:\2023\F02-2302060 - Meridian Dog Park Enhancements\Drawings\MER-C201 - R.dwg Last Save: 4/10/2024 5:30 PM Last saved by: BDThomas
 Last plotted by: Gillespie, Bailey I. Plot Style: AEC_B&W.ctb Plot Scale: 1:1 Plot Date: 4/29/2024 11:40 AM Plotter used: AutoCAD PDF (General Documentation).pc3

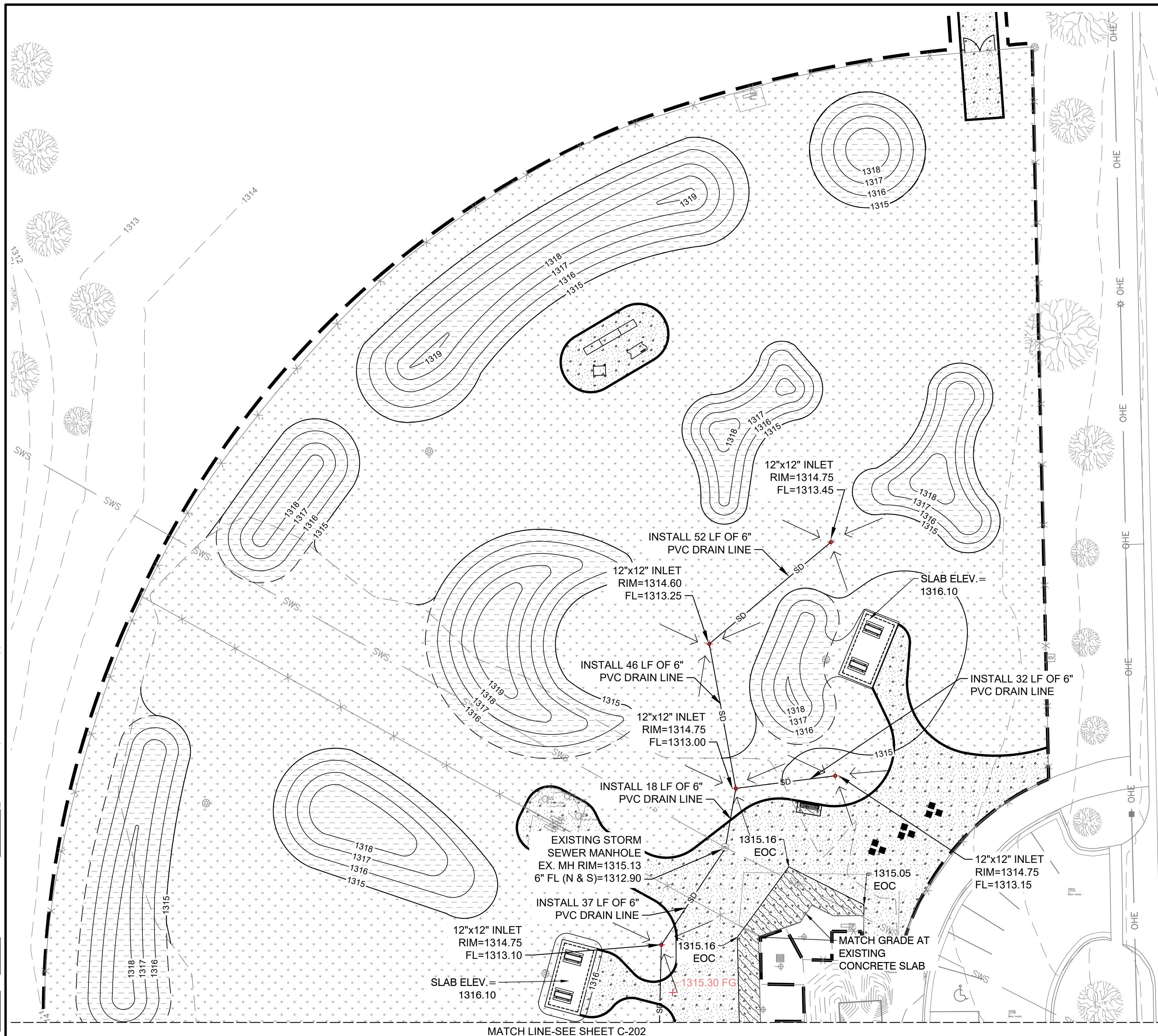

A SITE GRADING PLAN- NORTH
 SCALE: 1" = 20'

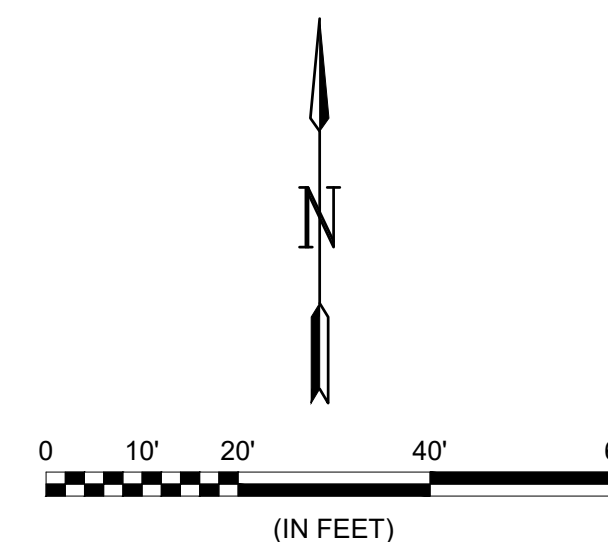

GENERAL GRADING NOTES

1. THE CONTRACTOR IS RESPONSIBLE FOR ADEQUATE EROSION CONTROL MEASURES. THESE MEASURES WILL SATISFY THE REQUIREMENTS ADEQ OF AND CAVHS. EROSION CONTROL DEVICES WILL BE MAINTAINED UNTIL PERMANENT GROUND COVER IS ESTABLISHED.
2. REFER TO LANDSCAPE PLAN FOR PERMANENT STABILIZATION. COMPLY WITH THE STANDARDS SET FORTH IN THE THE STANDARD SPECIFICATIONS. SEE LANDSCAPE PLANS/SPECS FOR GROUND COVER REQUIREMENTS.
3. CONTRACTOR SHALL MAINTAIN BENCHMARKS ON SITE UNTIL THE END OF CONSTRUCTION.
4. IT IS INCUMBENT UPON THE CONTRACTOR TO FIELD VERIFY THE EXISTING CONDITIONS PRIOR TO BEGINNING CONSTRUCTION. A TOPOGRAPHIC SURVEY INCLUDING UTILITY ROUTES AND TIE-INS, PAVEMENTS, STRUCTURES, AND GRADES SHALL BE CONDUCTED BY THE CONTRACTOR. SHOULD SIGNIFICANT DISCREPANCIES BE FOUND, IMMEDIATELY NOTIFY THE CONTRACTING OFFICER AND ENGINEER OF RECORD.
5. THE CONTRACTOR IS RESPONSIBLE FOR OBTAINING ALL GRADING RELATED PERMITS PRIOR TO BEGINNING EARTHWORK.
6. ALL STORM PIPES SHALL BE SCH 40 PVC UNLESS OTHERWISE NOTED.
7. UTILITIES SHALL MAINTAIN A 10 FOOT SEPARATION FROM BUILDING FOUNDATIONS.

AREA INLET INFORMATION

1. REFER TO DETAIL 4, SHEET C-501 FOR AREA INLET INSTALLATION DETAIL AND OPTIONS FOR INLETS.
2. REFER TO DETAIL 5, SHEET C-501 FOR PIPE EMBEDMENT DETAIL.

LEGEND

× TS	TOP OF SIDEWALK
— 511 —	MINOR CONTOUR
— 510 —	MAJOR CONTOUR
— CP — CP — CP —	CONCRETE STORM DRAIN
— SD —	PROPOSED SOLID PVC DRAIN
— — —	LIMITS OF CONSTRUCTION
— 505 —	EXISTING MAJOR CONTOUR
— — —	EXISTING MINOR CONTOUR
	PROPOSED SEEDED GRASS (90,560 S.F.) REFER TO SHEET L-101 FOR NOTES AND PLANT SCHEDULE
	PROPOSED BERMS WITH SEEDED GRASS (30,355 S.F.) REFER TO DETAIL 3/ SHEET L-502
	PROPOSED 4" CONCRETE PAVEMENT SURFACE (1,345 S.F.) REFER TO DETAIL 1/ SHEET C-501
	PROPOSED PERMEABLE GRAVEL PAVER W/ 3/8" CLEAN CHIPS (14,100 S.F.) REFER TO DETAIL 3/ SHEET L-501



© 2024 GARVER, LLC
 THIS DOCUMENT, ALONG WITH THE IDEAS AND DESIGNS CONVEYED HEREIN, SHALL BE CONSIDERED INSTRUMENTS OF PROFESSIONAL SERVICE AND ARE PROPERTY OF GARVER, LLC. ANY USE, REPRODUCTION, OR DISTRIBUTION OF THIS DOCUMENT, ALONG WITH THE IDEAS AND DESIGN CONTAINED HEREIN, IS PROHIBITED UNLESS AUTHORIZED IN WRITING BY GARVER, LLC OR EXPLICITLY ALLOWED IN THE GOVERNING PROFESSIONAL SERVICES AGREEMENT FOR THIS WORK.

1995 Midfield Road
 Wichita, KS 67209
 (316) 264-8008

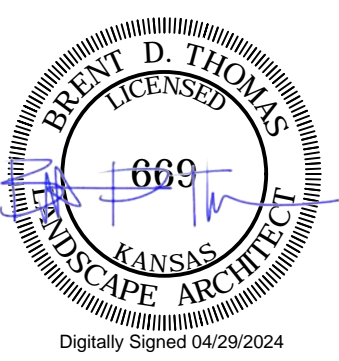

REV.	DATE	DESCRIPTION	BY

CITY OF WICHITA
 DEPT. OF PARK & RECREATION
 WICHITA, KANSAS
 2024 PARK FACILITY
 ENHANCEMENTS-
 K9 ROOSTER DOG PARK
 ENHANCEMENTS

SITE GRADING PLAN
 DOG PARK NORTH

JOB NO.: 2302060
 DATE: MAY 2024
 DESIGNED BY: BDT
 DRAWN BY: HG

BAR IS ONE INCH ON ORIGINAL DRAWING
 IF NOT ONE INCH ON THIS SHEET, ADJUST SCALES ACCORDINGLY.

DRAWING NUMBER
C-201

SHEET NUMBER