

File: E:\ecosystems\dwgs\3-16-2020\Rooster Canine Dog Park\Rooster Canine Dog Park - Irrigation Plan_4-29-2024.dwg Last Save: 4/29/2024 7:10 AM Last saved by: Brian Gates
 Last plotted by: Brian Gates Plot Style: LFX.ctb Plot Date: 4/29/2024 7:11 AM Plotter used: AutoCAD PDF (Smallest File).pc3

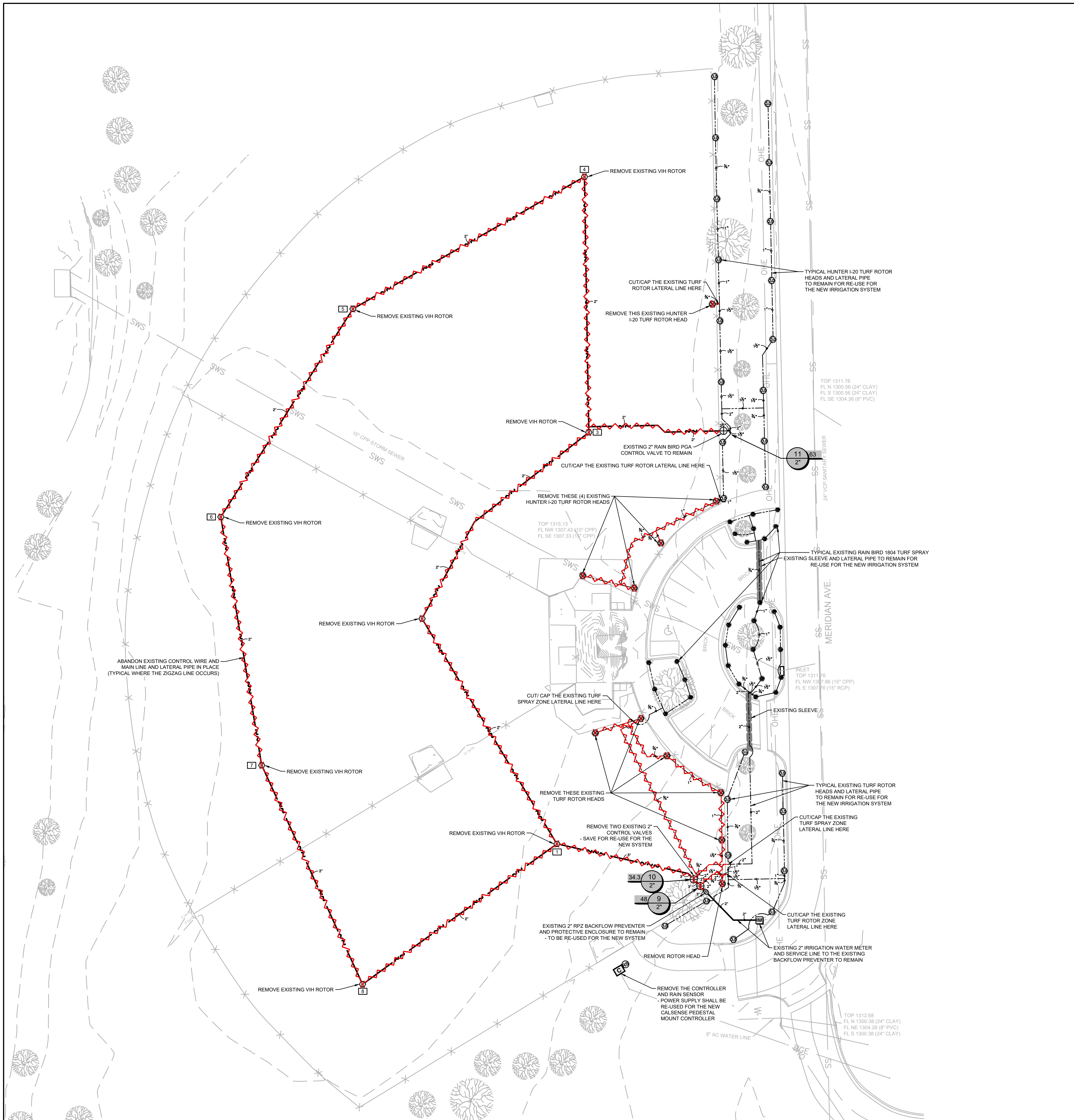

IRRIGATION SCHEDULE - EXISTING SYSTEM DEMO AND SALVAGE

SYMBOL	MANUFACTURER/MODEL	QTY	ARC	PSI
10	RAIN BIRD 1804 - EXISTING 10F	1	360	30
10	RAIN BIRD 1804 - EXISTING 10H	1	180	30
12	RAIN BIRD 1804 - EXISTING 12F	2	360	30
12	RAIN BIRD 1804 - EXISTING 12H	6	180	30
12	RAIN BIRD 1804 - EXISTING 12Q	9	90	30
12	RAIN BIRD 1804 - EXISTING 12T	7	120	30
15	RAIN BIRD 1804 - EXISTING 15F	1	360	30
15	RAIN BIRD 1804 - EXISTING 15H	2	180	30

SYMBOL	MANUFACTURER/MODEL/DESCRIPTION	QTY	PSI
3.0	HUNTER I-20-04 - EXISTING 3.0 EXISTING TURF ROTOR HEAD - 4IN. POP-UP, ADJUSTABLE AND FULL CIRCLE. PLASTIC RISER. DRAIN CHECK VALVE. STANDARD NOZZLE. 3/4" NPT INLET.	37	45
8	HUNTER G990E 53 GOLF AND LARGE TURF VALVE IN HEAD ROTOR. ELECTRIC VALVE-IN-HEAD, FULL CIRCLE. 3IN. POP-UP, 1-1/2IN. ACME FEMALE INLET. 80 PSI TO 120 PSI.	8	80

SYMBOL	MANUFACTURER/MODEL/DESCRIPTION	QTY
⊕	RAIN BIRD PGA GLOBE - EXISTING 2" EXISTING ELECTRIC SOLENOID REMOTE CONTROL VALVE, GLOBE. - TO BE RE-USED.	3
BF	ZURN WILKINS 975XL - EXISTING 2" EXISTING REDUCED PRESSURE BACKFLOW DEVICE WITH PROTECTIVE ENCLOSURE TO REMAIN.	1
C	EXISTING HUNTER WALL MOUNT CONTROLLER CONVENTIONAL WIRE HUNTER TYPE - REMOVE AND REPLACE WITH NEW CALSENSE PEDESTAL MOUNT CONTROLLER	1
RS	HUNTER MINI-CLIK RAIN SENSOR, TO BE REMOVED.	1
IM	WATER METER 2" EXISTING 2" IRRIGATION WATER METER TO REMAIN	1

---	IRRIGATION LATERAL LINE: PVC SCHEDULE 40 3/4" - EXISTING LATERAL PIPE. SIZES ARE ASSUMED.	970.4 L.F.
---	IRRIGATION LATERAL LINE: PVC SCHEDULE 40 1" - EXISTING LATERAL PIPE. SIZES ARE ASSUMED.	275.2 L.F.
---	IRRIGATION LATERAL LINE: PVC SCHEDULE 40 1 1/2" - EXISTING LATERAL PIPE. SIZES ARE ASSUMED.	252.0 L.F.
---	IRRIGATION LATERAL LINE: PVC SCHEDULE 40 2" - EXISTING LATERAL PIPE. SIZES ARE ASSUMED.	160.7 L.F.
---	IRRIGATION LATERAL LINE: PVC SCHEDULE 40 2 1/2" - EXISTING LATERAL PIPE. SIZES ARE ASSUMED.	3.7 L.F.
---	IRRIGATION MAINLINE: PVC CLASS 200 SDR 21 2" - EXISTING SERVICE LINE BETWEEN THE WATER METER AND THE BACKFLOW PREVENTER (2" ASSUMED SIZE) - TO REMAIN	36.3 L.F.
---	IRRIGATION MAINLINE: PVC CLASS 200 SDR 21 2" - EXISTING MAIN LINE AFTER THE BACKFLOW PREVENTER	1,203 L.F.
---	IRRIGATION MAINLINE: PVC CLASS 200 SDR 21 3" - EXISTING MAIN LINE AFTER THE BACKFLOW PREVENTER	89.4 L.F.
---	PIPE SLEEVE: PVC SCHEDULE 40 TYPICAL EXISTING PIPE SLEEVE FOR IRRIGATION PIPE AND WIRE TO REMAIN.	65.5 L.F.

Valve Callout
 # Valve Number
 # Valve Flow
 # Valve Size

ECOSYSTEMS
 IRRIGATION DESIGN AND CONSULTING
 2612 SW WINTERGARDEN DRIVE, LEE'S SUMMIT, MO 64081
 PHONE: 816-246-1082 EMAIL: Ecosystems@kc.ri.com

--- DEMO EXISTING PIPE (ABANDON PIPE (1 G35LF) AND CONTROL WIRE IN PLACE)
 X DEMO EXISTING HEAD (REMOVE HEAD AND RETURN TO OWNER)

IRRIGATION DEMO AND SALVAGE NOTES

- EXISTING SYSTEM AS BUILT INFORMATION HAS BEEN PROVIDED BY OTHERS AND IS ASSUMED TO BE ACCURATE.
- ALL DEMO AND SALVAGE WORK SHALL OCCUR BEFORE THE START OF OTHER NEW CONSTRUCTION.
- ALL EXISTING LATERAL PIPE SIZES ARE ASSUMED.
- ALL EXISTING COMPONENTS, INCLUDING LATERAL PIPE, TO REMAIN OR BE RE-USED FOR THE NEW IRRIGATION SYSTEM ARE ASSUMED TO BE FUNCTIONAL AND IN GOOD WORKING CONDITION. IF ANY EXISTING COMPONENTS TO REMAIN ARE DAMAGED OR OTHERWISE FOUND TO BE NON-FUNCTIONAL, THE IRRIGATION CONTRACTOR SHALL PREPARE AND SUBMIT A DETAILED CHANGE ORDER REQUEST FOR APPROVAL TO PROVIDE COMPARABLE NEW REPLACEMENT COMPONENTS.
- ALL EXISTING PIPE MARKED FOR DEMO SHALL BE ABANDONED IN PLACE AFTER THE REQUIRED CUTTING AND CAPPING OF LATERAL LINES. PIPE NOT MARKED FOR DEMO SHALL REMAIN FOR RE-USE FOR THE NEW IRRIGATION SYSTEM.
- ALL EXISTING HEADS MARKED FOR DEMO SHALL BE REMOVED AND RETURNED TO THE OWNER. EXISTING HEADS NOT MARKED FOR DEMO SHALL REMAIN.

IRRIGATION PLAN SHEET SCHEDULE

- | | |
|-----------------------------------|--------------------------------------|
| 1. SHEET IR-100 - IRRIGATION PLAN | - EXISTING SYSTEM DEMO AND SALVAGE |
| 2. SHEET IR-101 - IRRIGATION PLAN | - NEW SYSTEM SITE OVERALL (30 SCALE) |
| 3. SHEET IR-102 - IRRIGATION PLAN | - NEW SYSTEM NORTH (20 SCALE) |
| 4. SHEET IR-103 - IRRIGATION PLAN | - NEW SYSTEM SOUTH (20 SCALE) |
| 5. SHEET IR-104 - IRRIGATION PLAN | - SCHEDULES |
| 6. SHEET IR-105 - IRRIGATION PLAN | - NEW SYSTEM INSTALLATION DETAILS |

0 30 60 90 120 feet
 1" = 30'

NORTH



© 2024 GARVER, LLC
 THIS DOCUMENT, ALONG WITH THE IDEAS AND DESIGNS CONVEYED HEREIN, SHALL BE CONSIDERED INSTRUMENTS OF PROFESSIONAL SERVICE AND ARE PROPERTY OF GARVER, LLC. ANY USE, REPRODUCTION, OR DISTRIBUTION OF THIS DOCUMENT, ALONG WITH THE IDEAS AND DESIGN CONTAINED HEREIN, IS PROHIBITED UNLESS AUTHORIZED IN WRITING BY GARVER, LLC OR EXPLICITLY ALLOWED IN THE GOVERNING PROFESSIONAL SERVICES AGREEMENT FOR THIS WORK.

1995 Midfield Road
 Wichita, KS 67209
 (316) 264-8008

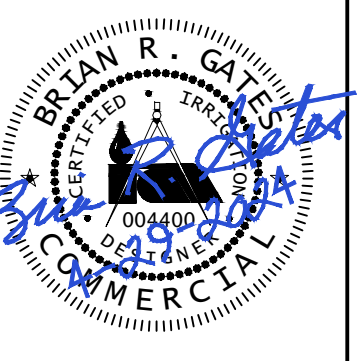

BY	DATE	DESCRIPTION

CITY OF WICHITA
 DEPT. OF PARK & RECREATION
 WICHITA, KANSAS

2024 PARK FACILITY
 ENHANCEMENTS -
 K9 ROOSTER DOG PARK
 ENHANCEMENTS

IRRIGATION PLAN
 - EXISTING SYSTEM
 DEMO AND SALVAGE

JOB NO.: 2302060
 DATE: MAY 2024
 DESIGNED BY: BRG
 DRAWN BY: BRG

BAR IS ONE INCH ON ORIGINAL DRAWING
 IF NOT ONE INCH ON THIS SHEET, ADJUST SCALES ACCORDINGLY.

DRAWING NUMBER
IR-100

SHEET NUMBER