

Scale: 1" = 60'

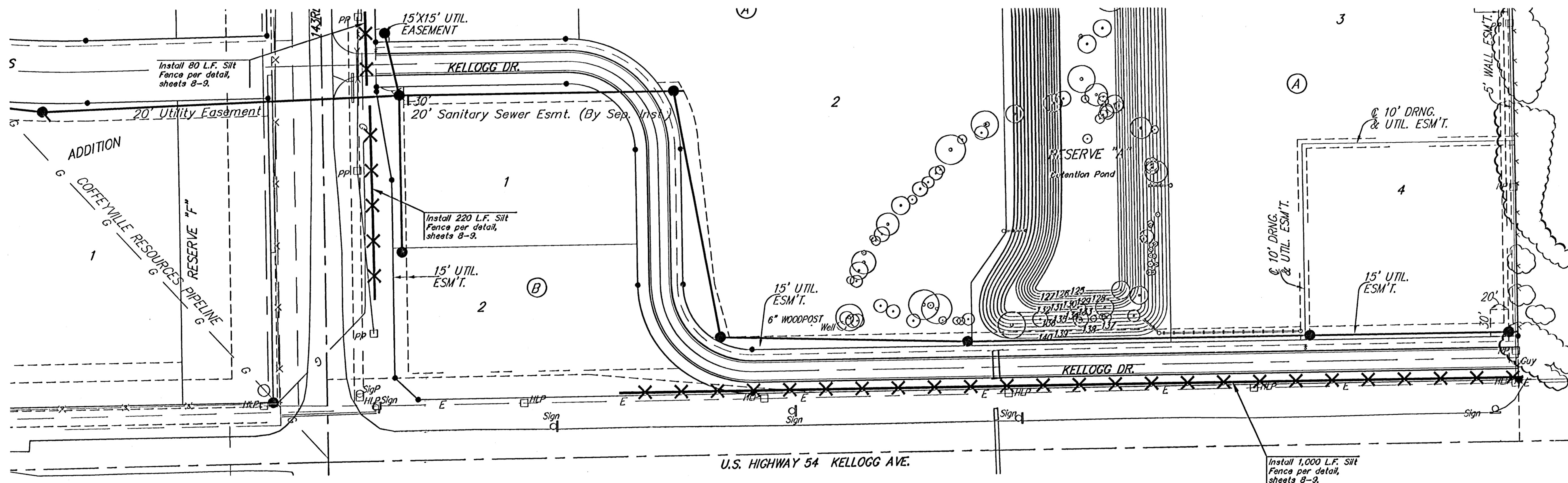

| EROSION CONTROL MEASURE | UNITS | QUANTITY |
|-----------------------------|-------|----------|
| SILT FENCE (Pond) | L.F. | --- |
| SILT FENCE (Site perimeter) | L.F. | 1,300 |
| RIPRAP | S.Y. | --- |
| DROP INLET BARRIER | EA. | --- |
| CURB INLET BARRIER | EA. | --- |
| Construction Entrance | EA. | 1 |

QUANTITIES ARE FOR INFORMATION ONLY
CONTRACTOR SHALL VERIFY QUANTITIES PER
SPECIFIC ENGINEERING PLAN SHEET.

Remove trees ONLY as necessary for construction. Cost of removal to be incidental to lump sum bid item "Site Clearing & Restoration".

NOTE: Contractor shall remove & replace existing erosion control measures as necessary for construction. Contractor shall be required to maintain all on-site erosion control items until final acceptance by the City of Wichita.

Install one construction entrance onto existing paved roadway per detail, sheets 8-9.

Baughman Prairie Pond Plaza Addition
EROSION CONTROL PLAN

Baughman Company, P.A. 313 Elm & Wilson, St. Louis, MO 63103 P 316-282-7271 F 316-282-0149
ENGINEERING | SURVEYING | PLANNING | LANDSCAPE ARCHITECTURE

| | | |
|---------------------------|---------------|------------------|
| PROJECT NUMBER 4688340 | DESIGN MWS | DRAWN TMS |
| REVISIONS | APPROVED | DATE 08/05 |
| SCALE Noted | | SHEET 7 OF 11 |

Prairie Pond Plaza/SSECPlan 05-05-E246