

STORM WATER DRAIN #269 to serve **CLIFTON COVE ADDITION** CITY OF WICHITA, KANSAS

James L. Armour, P.E. City Engineer
Project Number
468-84024
O.C.A. Number
751421

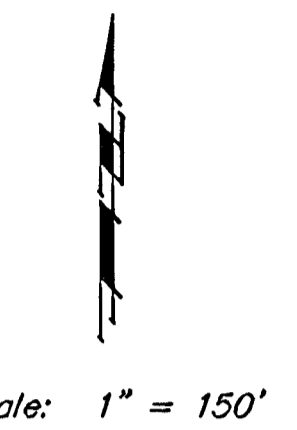

GENERAL NOTES:

1. Contractor will be required to provide notice to utility companies a minimum of forty-eight (48) hours prior to any excavation, as follows:

Kansas One-Call	687-2470
-----------------	----------

The Contractor must notify the following in case of an emergency:

Cox Communications	262-4270
Kansas Gas Service	1-888-482-4950
Westar Energy	383-8650
Aquila Energy	1-888-482-4950
SBC	268-2245
City of Wichita Water Dept.	268-4563
City of Wichita Sewer Maint.	268-4024
City of Wichita Storm Sewer Maint.	268-4090
City of Wichita Traffic Maint.	268-4034
Conoco Pipeline Co.	1-800-231-2551
Southern Star Pipeline Co.	529-6600
Phillips Pipeline Co.	1-800-766-8230
Jayhawk Pipeline Co.	1-888-542-9575
2. Underground utility service lines and overhead utility pole lines are to be adjusted as necessary by others prior to construction unless the plans specifically call for their adjustment by the Contractor or unless the plans specifically identify a utility to be adjusted by its owner during construction. Existing utilities and their location, as shown on the plans, represent the best information obtainable for design. The Contractor will be required to work around existing utilities within the right-of-way which do not conflict with proposed construction.
3. Trees and shrubs in public right-of-way which are in direct conflict with proposed new construction shall be removed by the Contractor with the Engineer's approval. Trees and shrubs which are not in direct conflict with proposed new construction shall be saved and protected from damage.
4. The Contractor shall give all property owners and/or tenants of developed property abutting the construction of this project a minimum of ten (10) days advance notice prior to start of construction.
5. The Contractor shall be responsible for preserving property irons. The Contractor will be required to re-establish any property irons which are damaged or destroyed by his construction operations. Such irons shall be re-established by a licensed land surveyor in accordance with state laws.
6. All excavation & trenching material shall be stockpiled or spread out on site as determined by the Engineer.
7. All existing and proposed erosion control measures including silt fencing, erosion control mat, straw bales, inlet barriers, and const. entrance shall be maintained throughout construction by the contractor and until project is accepted by the City of Wichita. The on-site engineer shall complete weekly reports on the status of erosion control measures. The contractor shall be required to comply with maintenance and/or replacement of erosion control measures as determined by the on-site engineer until project is accepted by City of Wichita. Maintenance and/or replacement of erosion control measures to be paid by L.S. bid item "Site Clearing & Restoration"
8. All areas disturbed during construction shall be seeded at 300 lbs./acre with Rye Grass immediately following construction in that area. Contractor shall prepare ground per City Specifications.
9. The developer for this project is Jay W. Russell, and may be contacted at (316)722-2417.

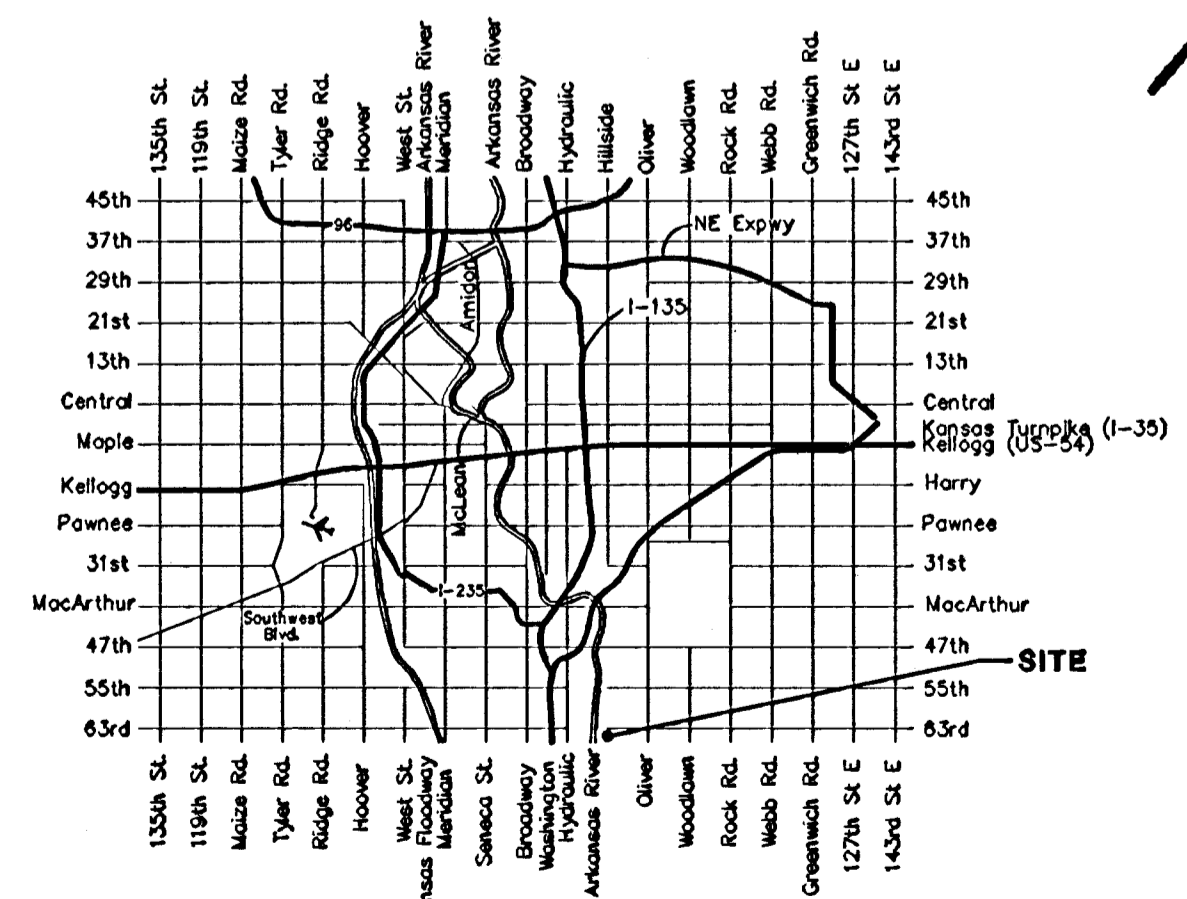
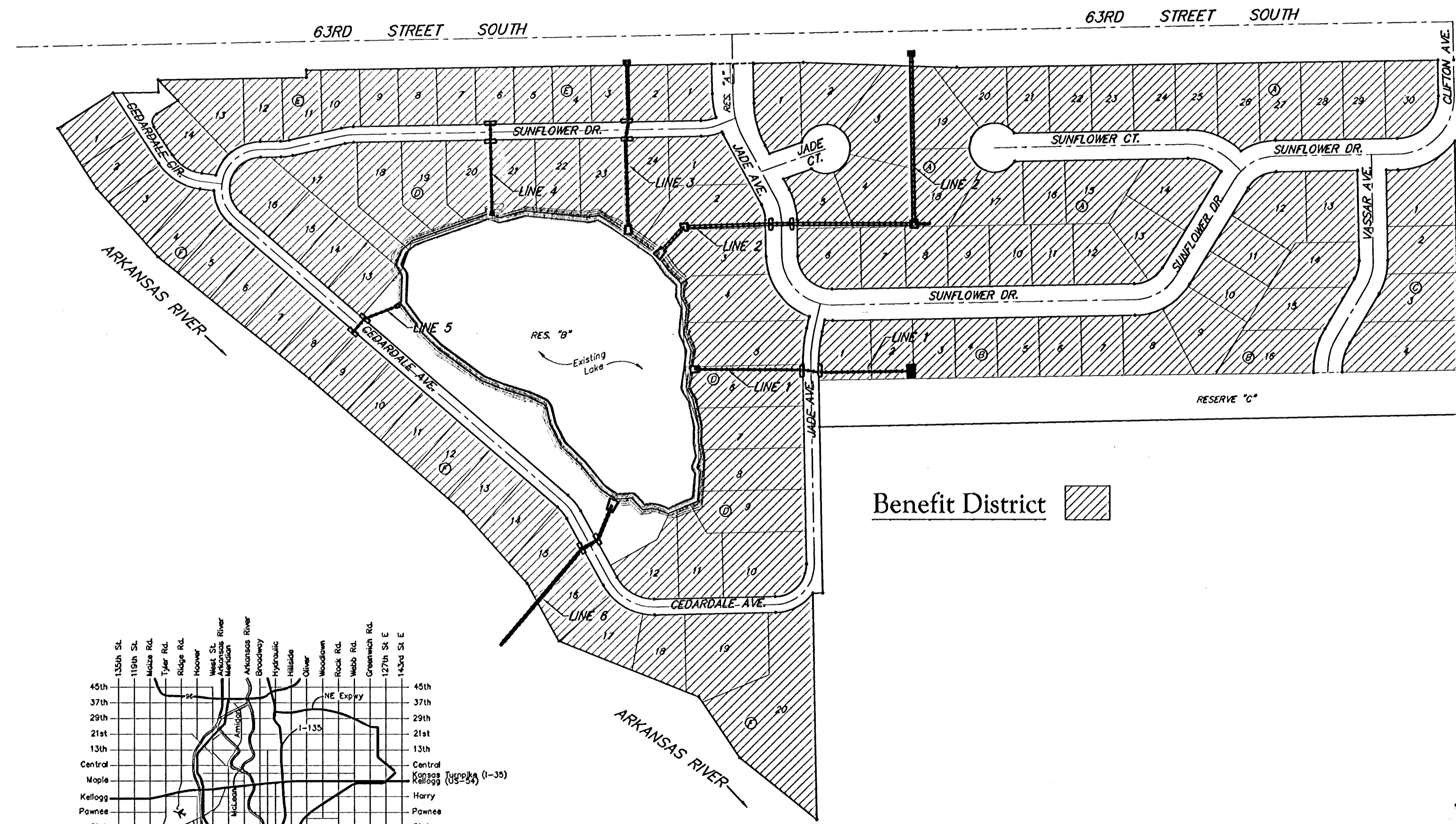

Vicinity Map

Benchmarks

Arkansas River bridge & 63rd St. S.
City of Wichita Benchmark Disc. SW
Cor. of bridge, top of hubguard.
500± E. of Grove.
Elev. = 1269.95 NGVD29
(per City record)

Brass plate on the NE wingwall of
Arkansas River bridge & 63rd St. S.
Elev. = 1267.48 NGVD29
(per County record)

Sheet Index

Title Sheet	1
Line 1	2
Line 2	3-5
Line 3	6
Line 4	7
Line 5	8
Line 6	9
Mass Grading Plan	10-11
Manhole Ring & Cover Detail	12
Std. Type 1A Double Inlet Detail	13
Standard Drop Inlet Detail	14
Headwall Details	15-16
Reinf. Conc. Manhole Detail	17
Inlet Manhole Detail	18
Erosion Control Plan	19
Erosion Control Details	20-23
Copy of Plat	24
Storm Sewer Coordinates	25



As Built