

REINFORCED CONCRETE MANHOLE
DEPTH OF STACK: 0' TO 2.33'

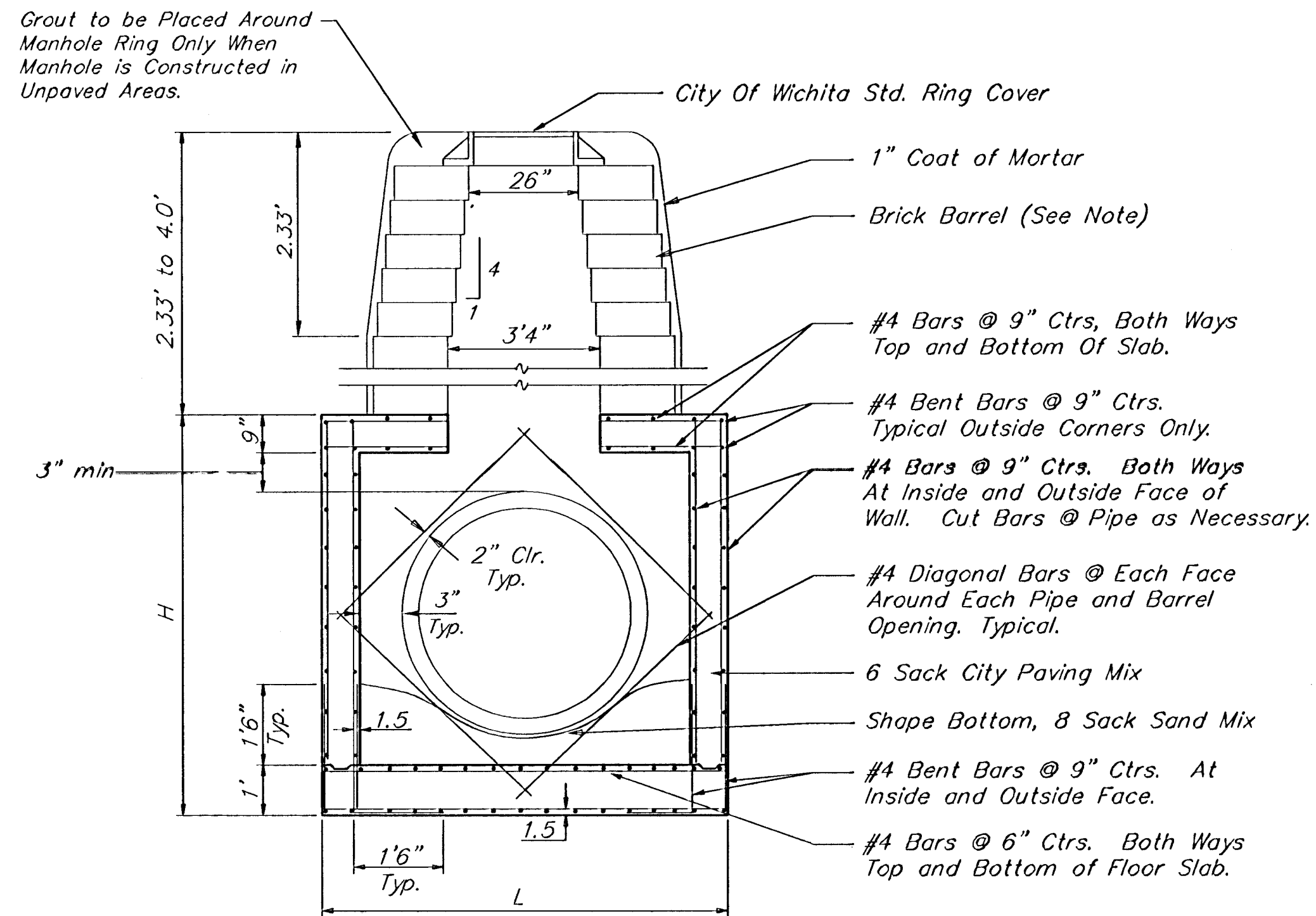

REINFORCED CONCRETE MANHOLE
DEPTH OF STACK: 2.33' TO 4.0'

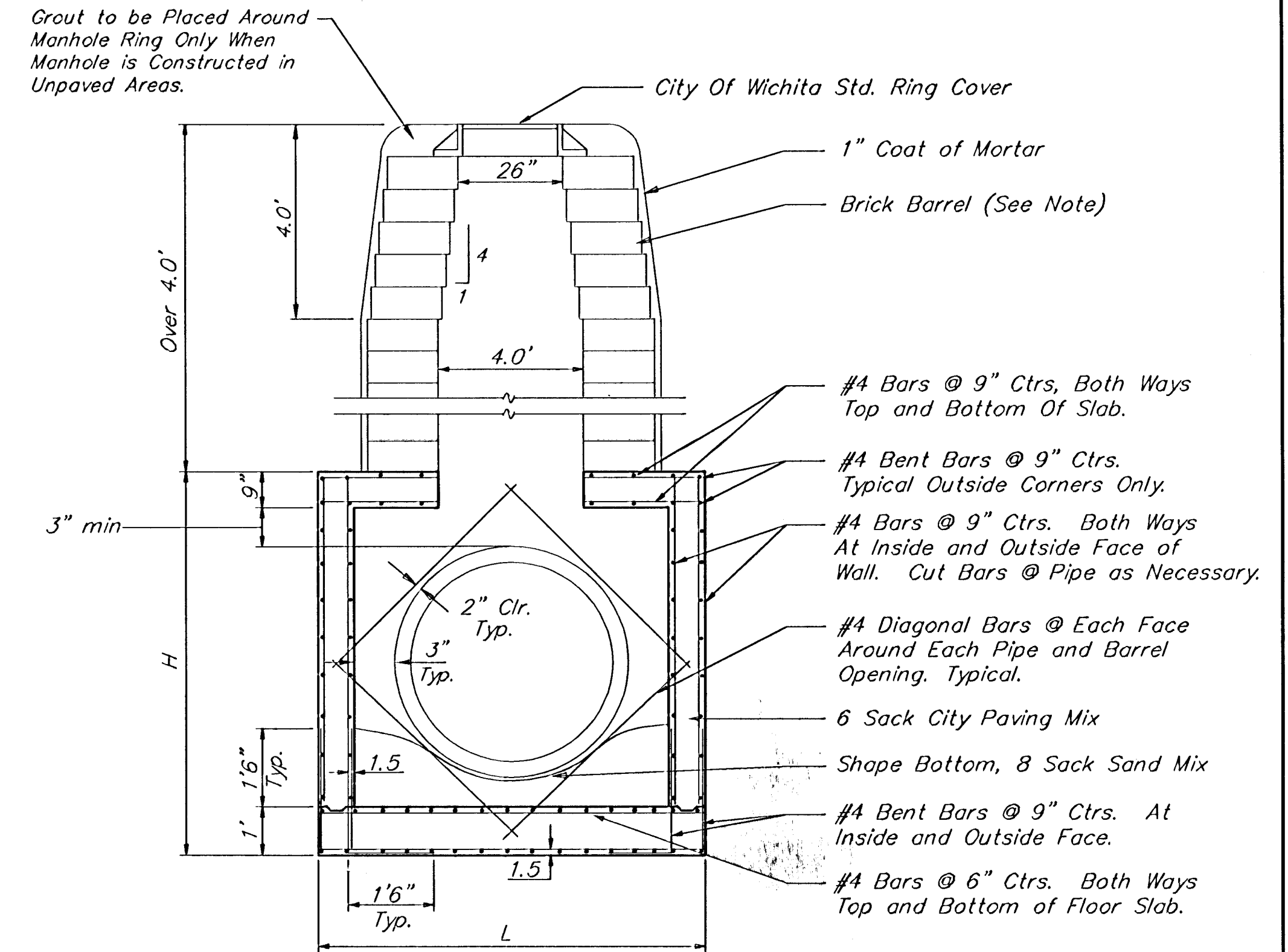

REINFORCED CONCRETE MANHOLE
DEPTH OF STACK: OVER 4.0'

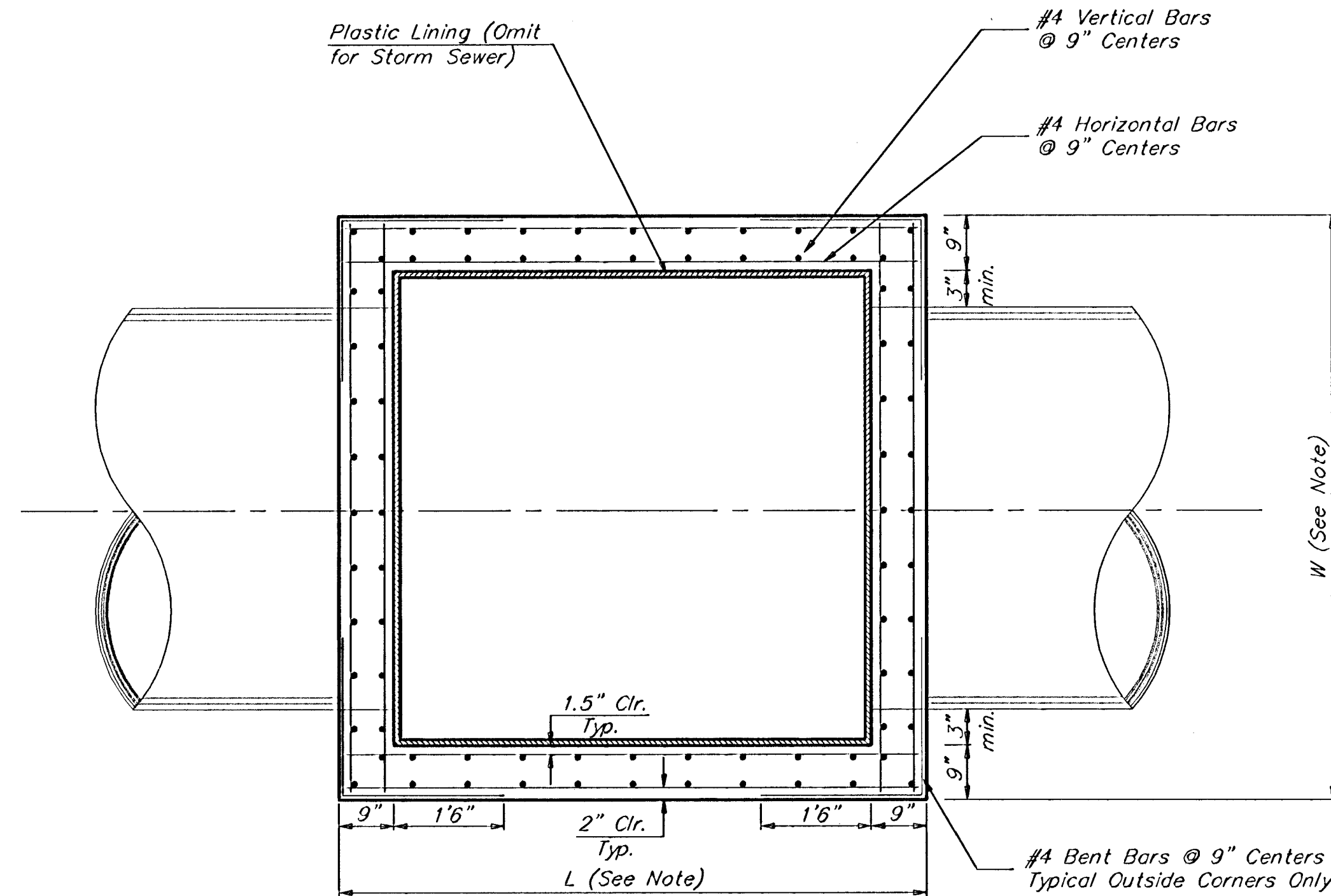

TOP VIEW

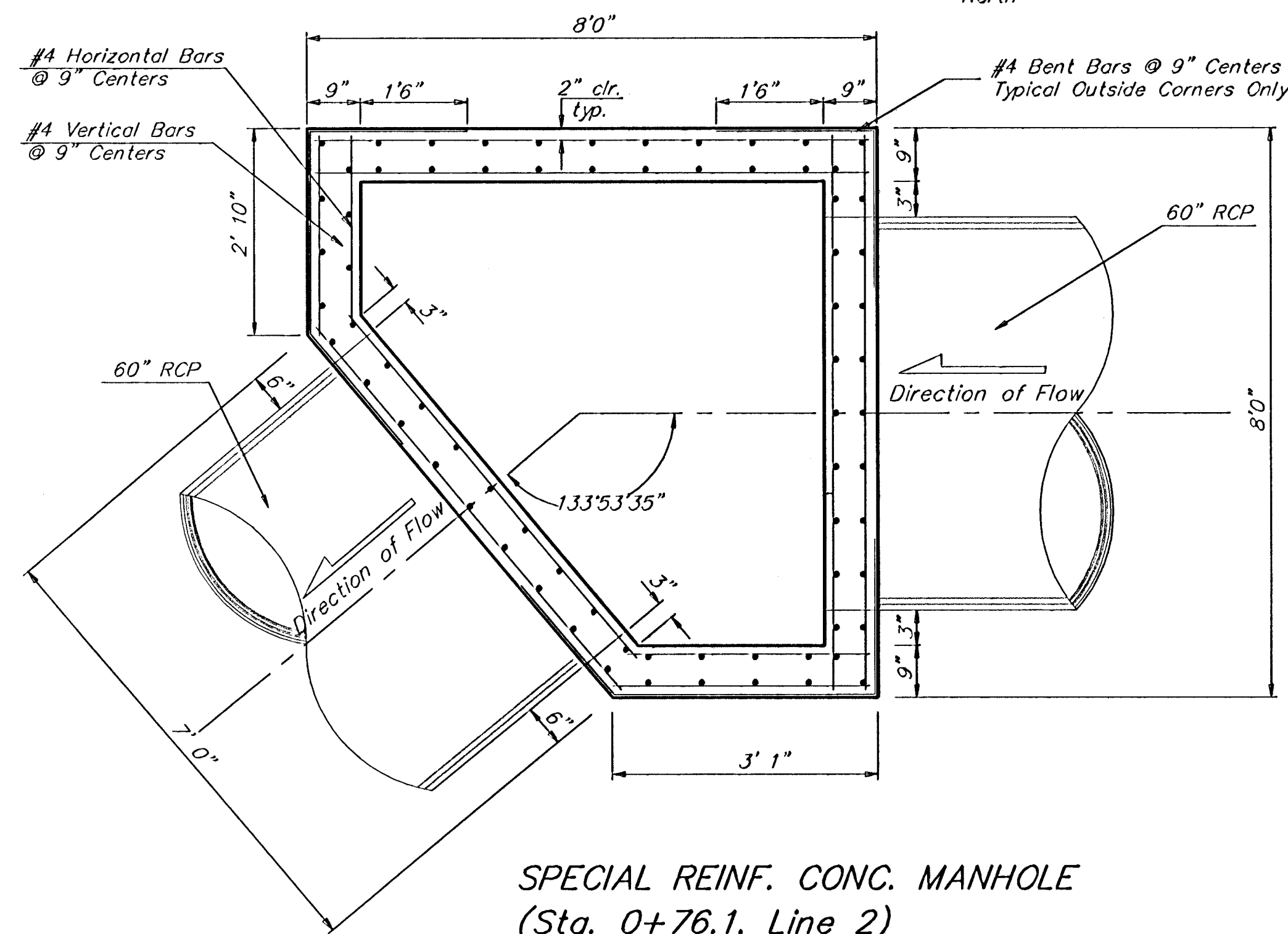

SPECIAL REINF. CONC. MANHOLE
(Sta. 0+76.1, Line 2)

Notes:

Brick barrels less than 16' deep shall have 8" walls except when located within public street or alley pavement; then the wall shall be 12". Brick barrels more than 16' deep shall have 12" walls. The "L" and "W" dimensions shall be a minimum of 5'6" for brick barrels with 8" walls and 6'2" for brick barrels with 12" walls when the brick barrels are over 4' in height. Completed manhole shall be without leaks and watertight.

Concrete wall thicknesses shown represents manhole type located within traffic bearing areas. Manhole wall, base, & top dimensions may be reduced when manholes are not subject to vehicle loads. Contractor shall be required to submit shop drawings to the Engineer for approval.

NOTE:
Bend Bars Not More Than 8"
to Clear Pipes, or Cut Bars
2" Clear of Pipe, as Necessary.

	City of Wichita Standard	
	Reinforced Concrete Manhole	
Storm Water Drain #269		
Baughman Company, P.A. 315 E 18th St. Wichita, KS 67211 P 316232711 F 316232749		
ENGINEERING SURVEYING PLANNING LANDSCAPE ARCHITECTURE		
PROJECT NUMBER 468-84024	DESIGN C.O.W.	DRAWN Staff
REVISIONS	APPROVED	DATE 5/30/06
	SCALE None	SHEET
	17 OF 25	
Eng \ Clifton Cove Add \ Remcity		