

INDUSTRIAL

AIR

CENTER

ADDITION

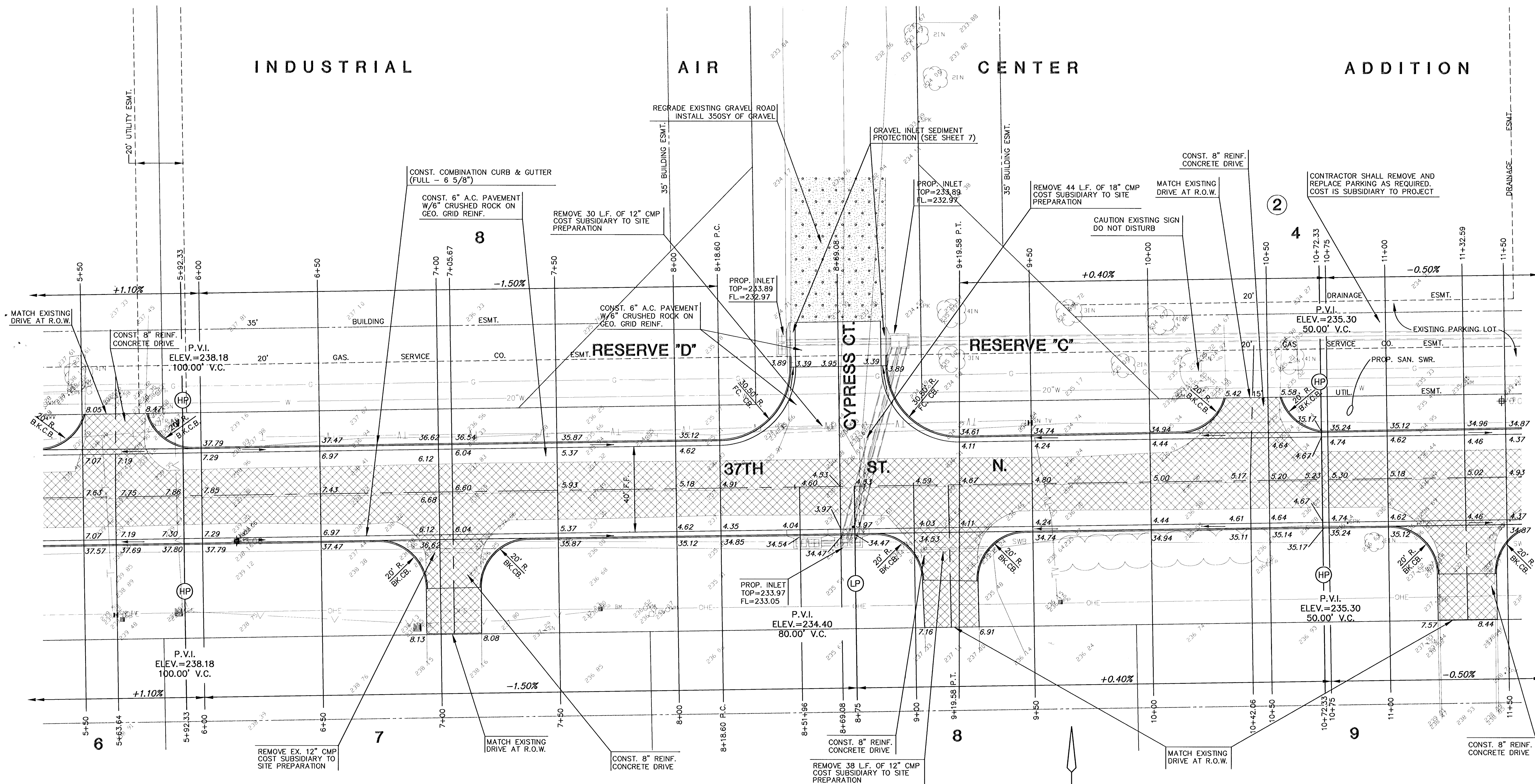

COMOTARA

INDUSTRIAL

PARK

4TH

ADDITION

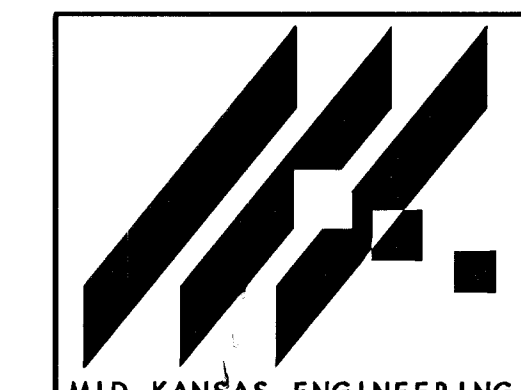
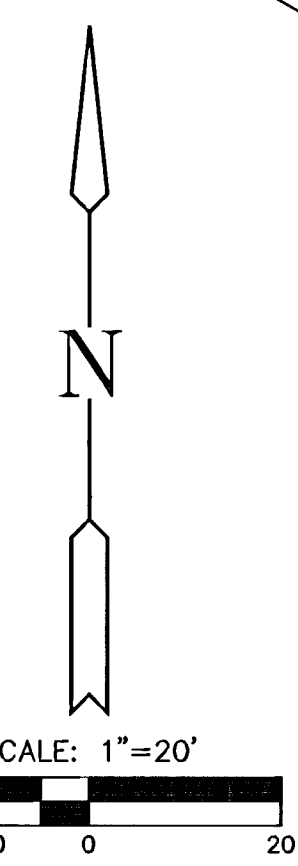

MID-KANSAS ENGINEERING
CONSULTANTS, INC.
411 N. WEBB ROAD
WICHITA, KS. 67206
316-684-9600

**COMOTARA INDUSTRIAL PARK
FOURTH ADDITION &
INDUSTRIAL AIR CENTER ADDITION**
PROJECT NAME

PAVING PLANS
SHEET TITLE

GJA/JPN DESIGN BY.	JPN/MLW/RDP DRAWN BY.	GJA/BDM CHECKED BY.
OCT. 1996 DATE	95114_E2 JOB NO.	9 / 21 SHEET/OF

H:\CIVIL\95114\PAVE\95114_E2 Mod Oct. 30 09:57:43 1996