

Scale: 1" = 60'

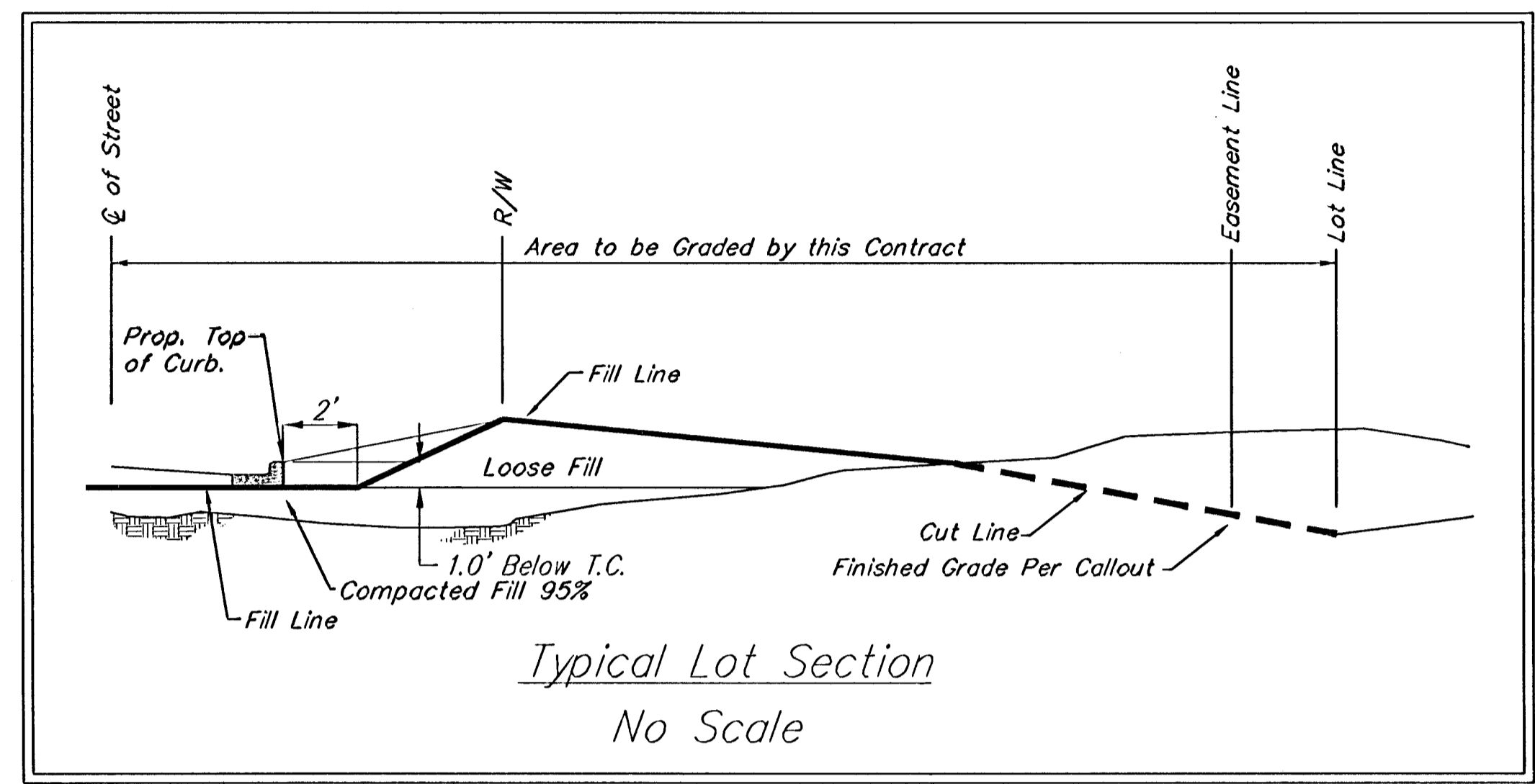

EROSION CONTROL PLAN LEGEND
(Installation Details Found in the SWP2 Plan)

- LIGHT STONE RIP-RAP
- DROP INLET PROTECTION
- CURB INLET PROTECTION
- STRAW BALE BARRIERS
- SILT FENCING
- EROSION CONTROL BERM

NO SCALE

EARTH WORK TOTALS

	C.Y. Cut	C.Y. Fill
Mass Grading	19,534	68,608
Pond Construction	4,388	890
Total Earthwork	63,422	69,498

Earthwork quantities are for reference only. All cost associated with mass grading shall be incidental to lump sum bid item "Mass Grading".

- Contractor to strip top 3" of soil within Res. "B" and street R/W before mass grading and stockpile. Top soil stockpile to be redistributed over Reserve "B" above water surface.
- Compaction of 95% shall be obtained in all street R/W's, 90% in all other areas.
- It shall be the Contractor's responsibility to protect the sanitary sewer and water distribution system during mass grading. Any damage done to these systems by Contractor or subcontractor shall be repaired at no additional cost to the project.
- Only trees within the street R/W or Res. "B" may be removed if necessary for grading. All other trees shall be protected from damage.
- All areas disturbed by construction (except within street R/W) shall be seeded as indicated on Pond Plan.

Remove trees **ONLY** as necessary for construction. Contractor shall contact engineer or developer prior to any tree removal. Cost of removal to be incidental to lump sum bid item "Site Clearing & Restoration".

NOTE: Contractor shall remove & replace existing erosion control measures as necessary for construction. Contractor shall be required to maintain all on-site erosion control items until final acceptance by the City of Wichita.

Baughman SOUTHERN RIDGE 3RD ADDITION
MASS GRADING PLAN
EROSION CONTROL PLAN
WICHITA, KANSAS

Baughman Company, P.A. 315 Ellis St. Wichita, KS 67211 P 316-262-7271 F 316-262-0149
ENGINEERING | SURVEYING | PLANNING | LANDSCAPE ARCHITECTURE

PROJECT NUMBER	DESIGN	DRAWN
REVISIONS	APPROVED	DATE
	SCALE	07-05
	Noted	
	SHEET	

26 OF 34

SouthernRidge3rdMass 0501E148