

J:\PROJECTS\2022\12\10\10427_PERFECTION_COURTYARDS AT MOORINGS\DWG 2\10427 CAD\SHS\105_CIVIL\PAVPH12\427-05-500-PH1_REV.DWG
 PLOTTED: Tuesday, July 30, 2024 @ 11:46AM

PAVING & INCIDENTAL DRAINAGE PLANS FOR
COURTYARDS AT THE MOORINGS
 PART C

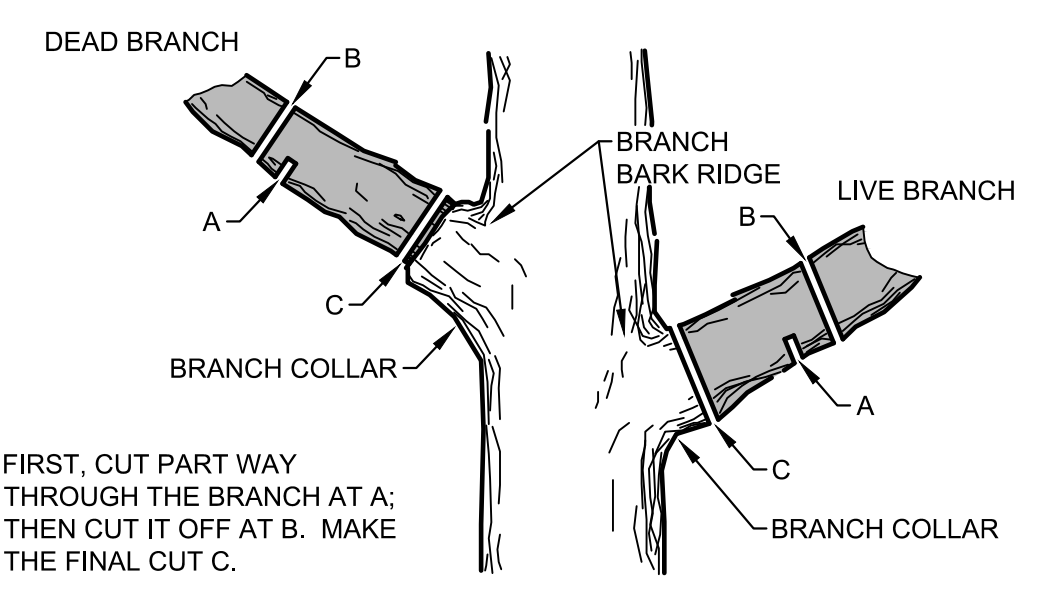
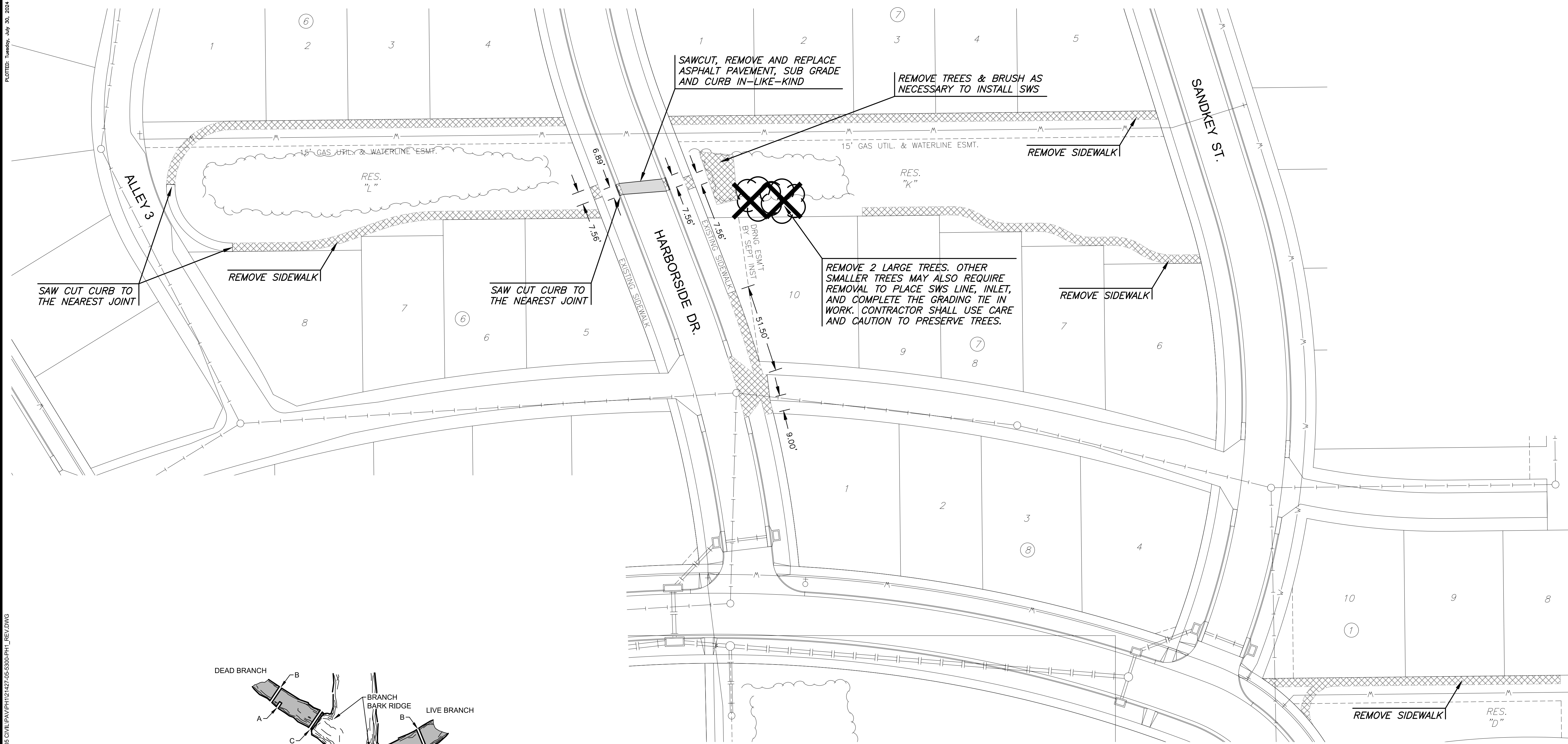

FIRST, CUT PART WAY THROUGH THE BRANCH AT A. THEN CUT IT OFF AT B. MAKE THE FINAL CUT C.

TREE TRIMMING NOTES:

1. NOTIFY MKEC PROJECT ENGINEER PRIOR TO COMMENCEMENT OF EASEMENT CLEARING & GRUBBING OPERATIONS. CONTRACTOR SHALL HAVE LIMITS OF REMOVAL DEFINED WITH FLAG & LATH. MKEC PROJECT ENGINEER WILL PROVIDE JUDGEMENT CALLS FOR TREES IN QUESTION. PROVIDE MKEC 24-HOUR NOTICE.
2. TREES MAY BE BURNED ON SITE. REGULATORY & PERMITTING APPROVALS SHALL BE SECURED BY CONTRACTOR.
3. TRIMMING OF BRANCHES SHALL NOT BE DONE WITH A BACKHOE!

TREE TRIMMING DETAIL

SCALE: NTS



CAUTION!
 THESE SMALL TREE GROUPINGS ARE AN IMPORTANT ASSET TO THE DEVELOPER. THE CONTRACTOR SHALL STAY OUT OF THE TREE ROOT ZONE WITH EQUIPMENT, ETC EXCEPT WHERE NOTED OTHERWISE.

©2024 MKEC Engineering All Rights Reserved www.mkec.com
 These drawings and their contents, including, but not limited to, all concepts, designs, & ideas are the exclusive property of MKEC Engineering (MKEC), and may not be used or reproduced in any way without the express consent of MKEC.

DEMOLITION PLAN

PROJECT NO.	472-2022-085820c	
DATE	JULY 2024	
SCALE	1" = 30'	
DESIGNED	DRAWN	CHECKED
DML	DML	SPE
0	ISSUED FOR CONSTRUCTION	07/30/24
NO.	REVISION	DATE

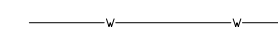
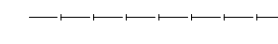
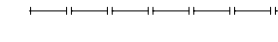
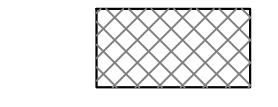
LEGEND

-  WATERLINE
-  SANITARY SEWER
-  STORMWATER SEWER
-  EXISTING CONC. DRIVE / SIDEWALK, & TREES TO BE REMOVED
-  TREE REMOVAL

