

J:\PROJECTS\2021\101010427_PERFECTION_COURTYARDS AT MOORINGS\DWG 210427 CAD\SHOTS\05 CIVIL\PAVPH1\2427-05-2500-PH1_REV.DWG
 PLOTTED: Tuesday, July 30, 2024 @ 11:50AM

PAVING & INCIDENTAL DRAINAGE PLANS FOR
COURTYARDS AT THE MOORINGS
 PART C

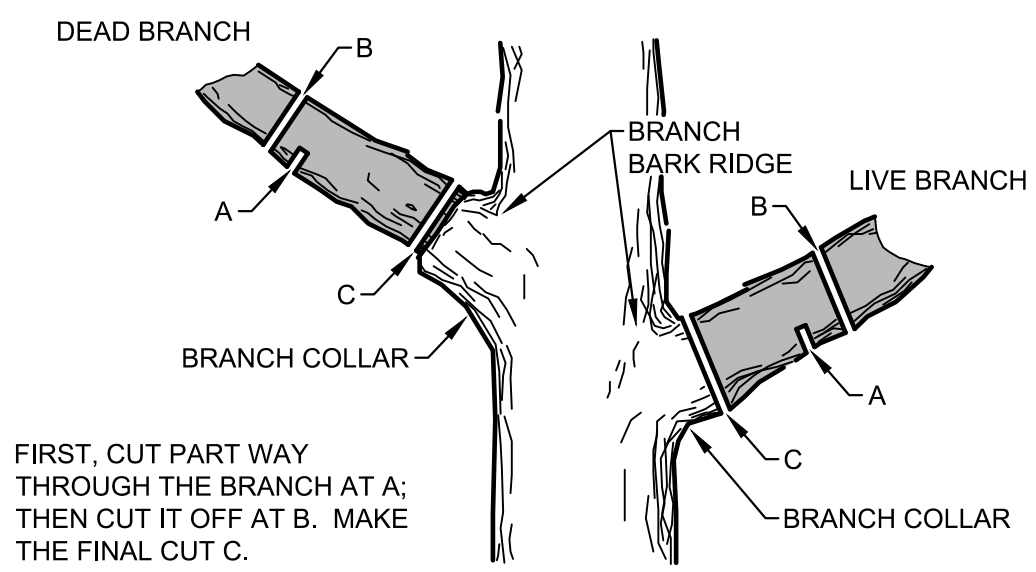
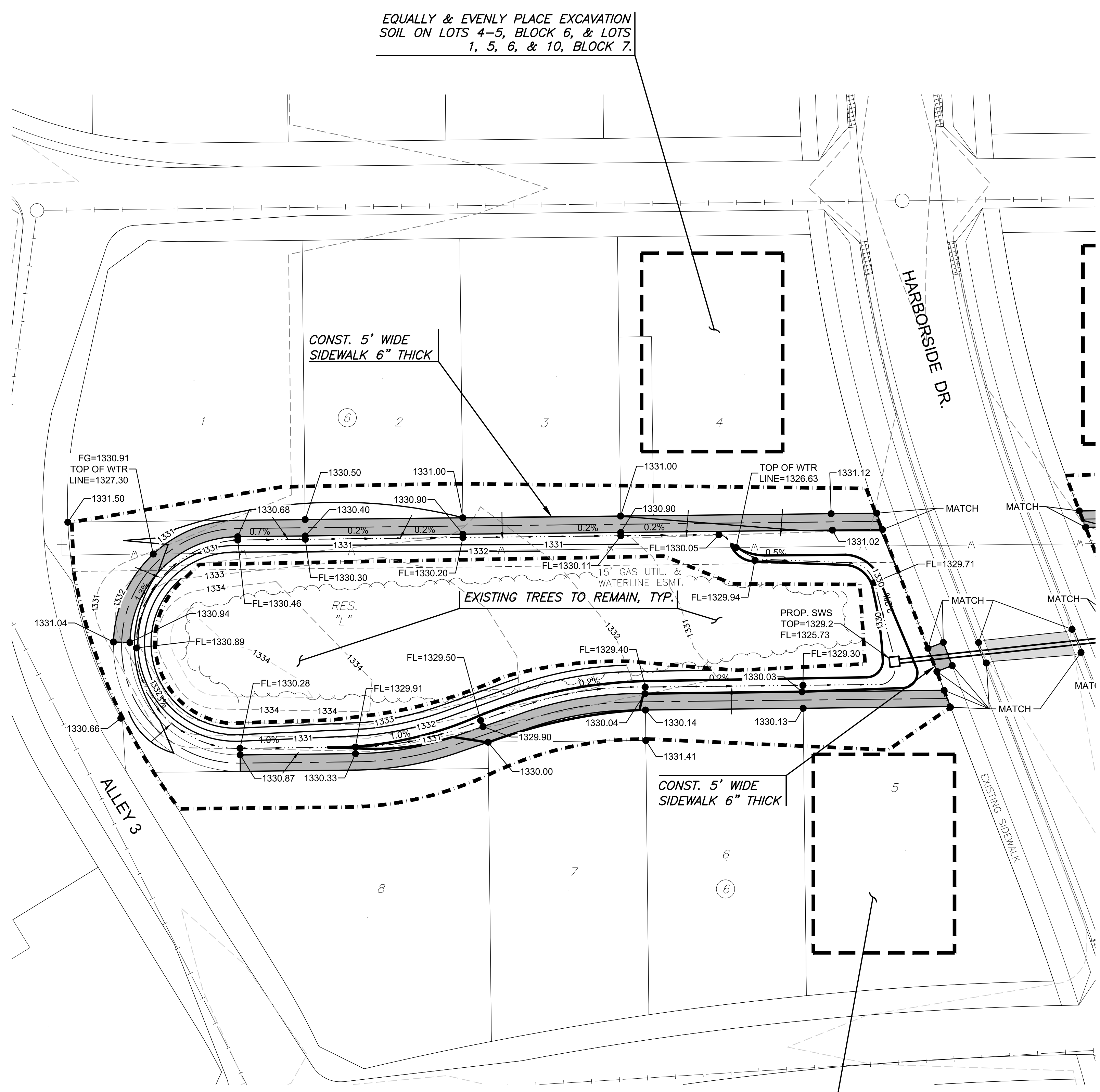

FIRST, CUT PART WAY THROUGH THE BRANCH AT A; THEN CUT IT OFF AT B. MAKE THE FINAL CUT C.

TREE TRIMMING NOTES:

1. NOTIFY MKEC PROJECT ENGINEER PRIOR TO COMMENCEMENT OF EASEMENT CLEARING & GRUBBING OPERATIONS. CONTRACTOR SHALL HAVE LIMITS OF REMOVAL DEFINED WITH FLAG & LATH. MKEC PROJECT ENGINEER WILL PROVIDE JUDGEMENT CALLS FOR TREES IN QUESTION. PROVIDE MKEC 24-HOUR NOTICE.
2. TREES MAY BE BURNED ON SITE. REGULATORY & PERMITTING APPROVALS SHALL BE SECURED BY CONTRACTOR.
3. TRIMMING OF BRANCHES SHALL NOT BE DONE WITH A BACKHOE!

TREE TRIMMING DETAIL

SCALE: NTS

CAUTION!
THESE SMALL TREE GROUPINGS ARE AN IMPORTANT ASSET TO THE DEVELOPER. THE CONTRACTOR SHALL STAY OUT OF THE TREE ROOT ZONE WITH EQUIPMENT, ETC EXCEPT WHERE NOTED OTHERWISE.

LEGEND

- 1250 --- EXISTING MAJOR CONTOUR
- 1250 --- EXISTING MINOR CONTOUR
- 1250 — PROPOSED MAJOR CONTOUR
- 1250 — PROPOSED MINOR CONTOUR
- W — EXISTING WATERLINE
- S — EXISTING SANITARY SEWER
- SW — EXISTING STORMWATER SEWER
- SW — PROPOSED STORMWATER SEWER
- — LIMITS OF GRADING
- — SWALE FLOWLINE
- 1329.86 SPOT ELEVATIONS
- FLOW ARROW

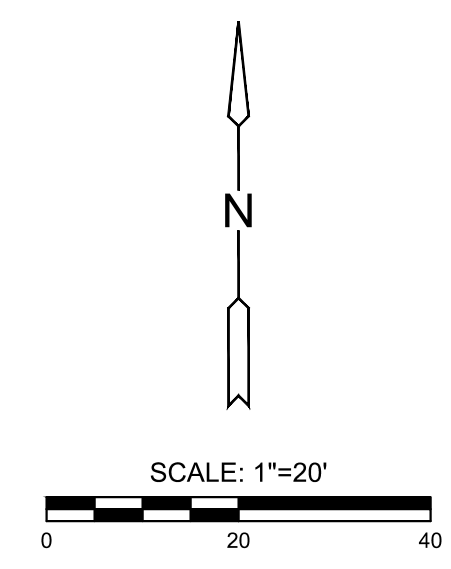

©2024 MKEC Engineering All Rights Reserved www.mkec.com
 These drawings and their contents, including, but not limited to, all concepts, designs, & ideas are the exclusive property of MKEC Engineering (MKEC), and may not be used or reproduced in any way without the express consent of MKEC.

GRADING PLAN 1

| | | |
|-------------|-------------------------|----------|
| PROJECT NO. | 472-2022-085820c | |
| DATE | JULY 2024 | |
| SCALE | 1" = 20' | |
| DESIGNED | DML | |
| DRAWN | DML | |
| CHECKED | SPE | |
| NO. | REVISION | DATE |
| 0 | ISSUED FOR CONSTRUCTION | 07/30/24 |