

J:\PROJECTS\2022\20101047_COW_135TH STREET FROM CENTRAL TO 13TH STREET\100 22047 CAD\SHOTS\05 CIVIL\SIGNALS\22047-05-5500.DWG
 J:\PROJECTS\2022\20101047_COW_135TH STREET FROM CENTRAL TO 13TH STREET\100 22047 CAD\SHOTS\05 CIVIL\SIGNALS\22047-05-5500.DWG
 PLOTTED: Tuesday, July 16, 2024 @ 02:39PM

PHASE DIAGRAM

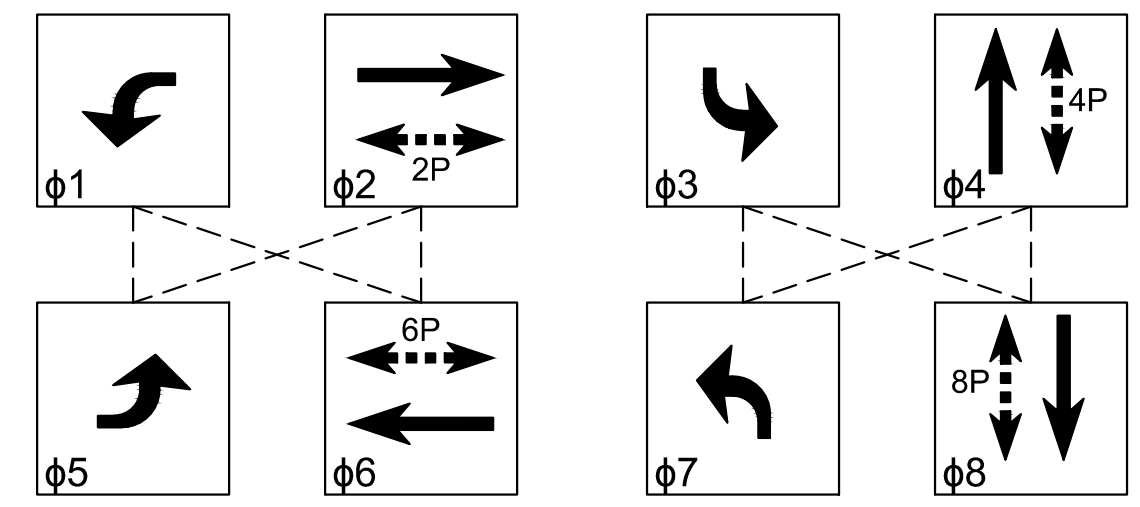

CENTRAL AVE. 135TH ST. WEST

NOTE: DOTTED LINES CONNECTING PHASES INDICATE PHASES THAT CAN OCCUR CONCURRENTLY. PEDESTRIAN PHASE TO ONLY OCCUR AFTER PUSH BUTTON ACTIVATION.

SIGNAL FACES

NOTE: ALL LENSES SHALL BE 12" L.E.D. PEDESTRIAN LENSES SHALL BE 16" AND BE COUNTDOWN SIGNALS.

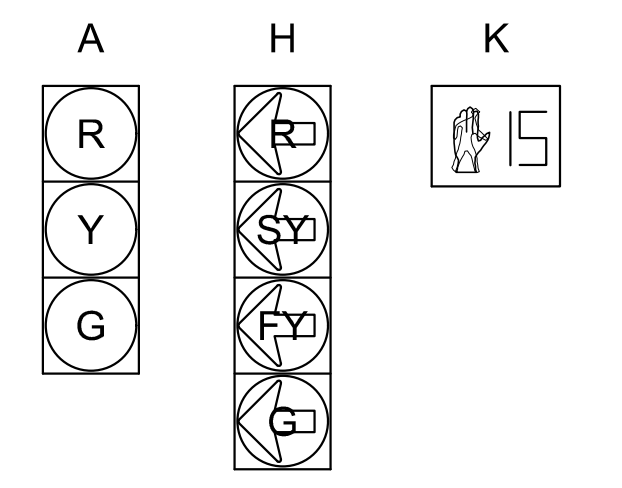

REMOVE 6.7 L.F. OF CURB & GUTTER AND REPLACE WITH FULL HEIGHT CURB. REMOVE AND REPLACE 15.7 S.F. OF CONCRETE SIDEWALK, 4" CONST. 6.7 L.F. OF "SIDEWALK THICKENING" SEE SH. 13

6" SIDEWALK PROTECTION CURB

CONST. 27.6 S.F. OF "CONCRETE SIDEWALK, 5" AND 16.0 L.F. "CONCRETE SIDEWALK PROTECTION CURB". SEE SH. NO. 13

CONST. COMPACTED FILL TO SUPPORT PROPOSED SIDEWALK AND SERVICE BOX. COMPACTED FILL IS SUBSIDIARY TO OTHER ITEMS OF WORK. SEE SH. NO. 13

STRUCTURE LOCATIONS

POLE NO.	* TYPE	STATION	OFFSET	NORTHING	EASTING	** ELEV.
1	POLE	23+73.7	64.4' LT.	1,687,924.338	1,602,174.751	1349.3
2	PB STA.	23+69.0	53.3' LT.	1,687,919.828	1,602,185.947	1349.6
3	POLE	22+69.6	62.7' LT.	1,687,820.582	1,602,178.072	1348.7
4	PED	23+71.0	61.0' RT.	1,687,923.940	1,602,300.178	1349.4
5	POLE	23+77.4	54.6' RT.	1,687,930.178	1,602,293.671	1348.0
6	POLE	22+69.1	53.3' RT.	1,687,821.665	1,602,294.087	1348.6
METER	-	22+48.2	63.0' LT.	1,687,799.249	1,602,178.035	
CONT.	-	22+63.7	83.6' LT.	1,687,814.449	1,602,157.317	1349.0

SERVICE BOX LOCATIONS

BOX NO.	STATION	OFFSET	NORTHING	EASTING	** ELEV.
1	23+70.1	73.7' RT.	1,687,923.252	1,602,312.977	1349.2

* STRUCTURE TYPES: POLE - TRAFFIC SIGNAL POLE; PED - TRAFFIC SIGNAL PEDESTAL; PB STA. - APS PUSH BUTTON STATION

** APPROXIMATE TOP OF FOUNDATION. SEE STANDARDS AND SPECS FOR ADDITIONAL INFORMATION. FOUNDATIONS SHALL NOT CREATE A "LOW AREA". CONTRACTOR TO VERIFY SIGNAL POLE HEIGHTS AND TOPS OF POLE FOOTING ELEVATIONS PRIOR TO CONSTRUCTION.

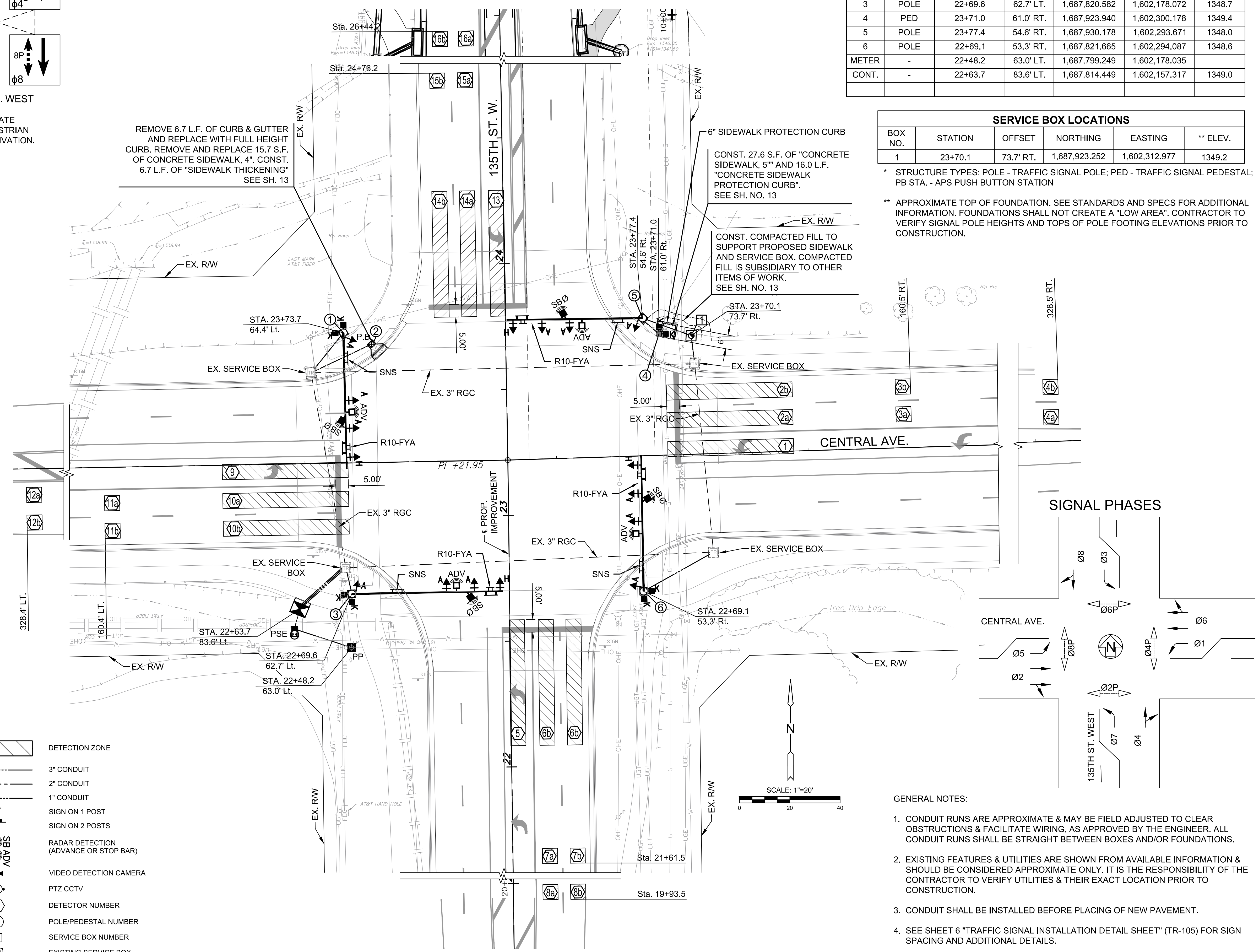

SIGNAL PHASES

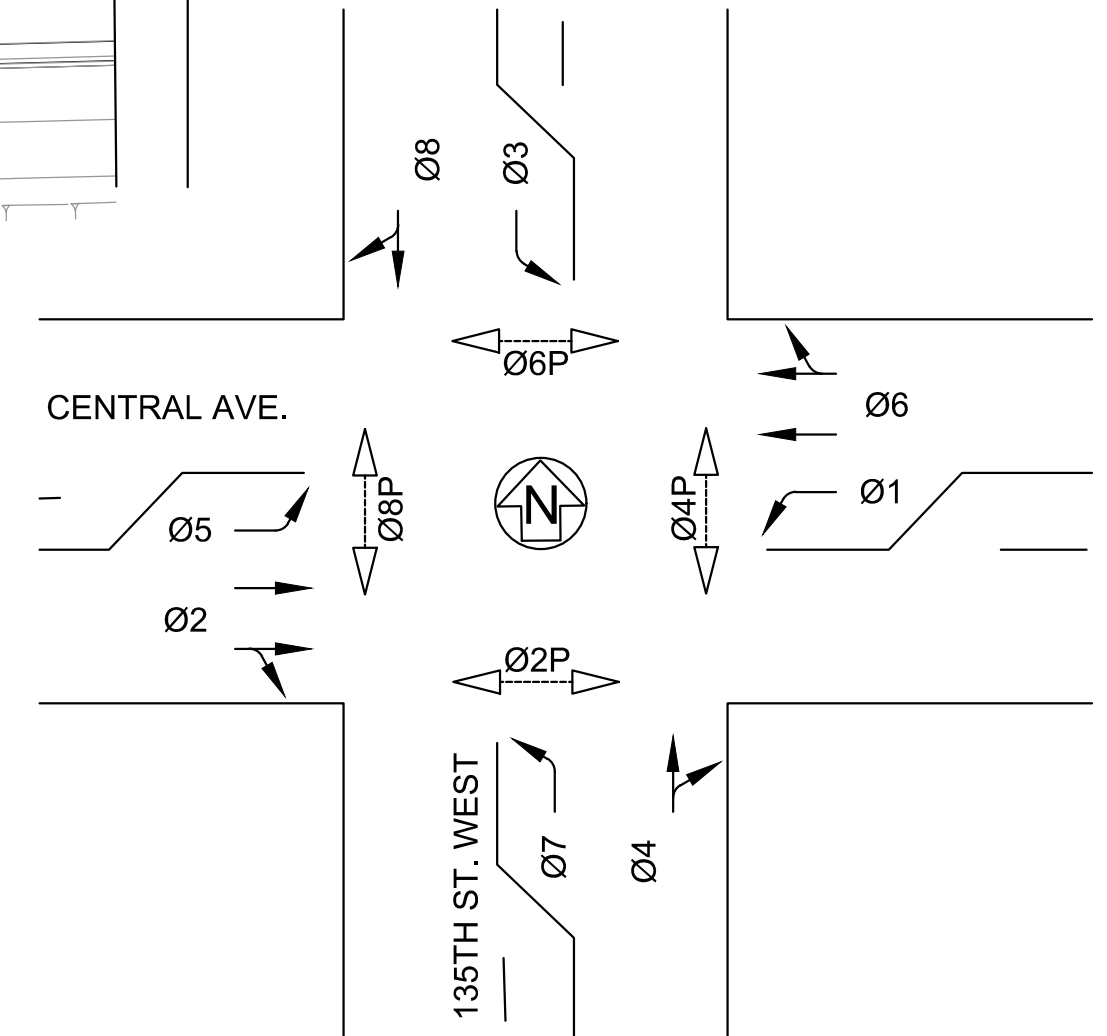

LEGEND

- | | | | |
|--|---|--|---------------------------------------|
| | LUMINAIRE | | DETECTION ZONE |
| | TRAFFIC SIGNAL POLE | | 3" CONDUIT |
| | TRAFFIC SIGNAL PEDESTAL | | 2" CONDUIT |
| | APS PUSHBUTTON STATION | | 1" CONDUIT |
| | TRAFFIC SIGNAL HEAD WITH TYPE DESIGNATION | | SIGN ON 1 POST |
| | TRAFFIC SIGNAL HEAD WITH TYPE DESIGNATION & BACKPLATE | | SIGN ON 2 POSTS |
| | PEDESTRIAN SIGNAL & PUSHBUTTON | | RADAR DETECTION (ADVANCE OR STOP BAR) |
| | POLE MOUNTED CONTROLLER | | VIDEO DETECTION CAMERA |
| | PAD MOUNTED CONTROLLER | | PTZ CCTV |
| | SERVICE BOX | | DETECTOR NUMBER |
| | SECONDARY SERVICE POINT | | POLE/PEDESTAL NUMBER |
| | PEDESTRIAN PUSHBUTTON | | SERVICE BOX NUMBER |
| | POWER POLE | | EXISTING SERVICE BOX |
| | METER BOX AND POWER DISCONNECT | | |
| | POWER SERVICE ENCLOSURE | | |

GENERAL NOTES:

- CONDUIT RUNS ARE APPROXIMATE & MAY BE FIELD ADJUSTED TO CLEAR OBSTRUCTIONS & FACILITATE WIRING, AS APPROVED BY THE ENGINEER. ALL CONDUIT RUNS SHALL BE STRAIGHT BETWEEN BOXES AND/OR FOUNDATIONS.
- EXISTING FEATURES & UTILITIES ARE SHOWN FROM AVAILABLE INFORMATION & SHOULD BE CONSIDERED APPROXIMATE ONLY. IT IS THE RESPONSIBILITY OF THE CONTRACTOR TO VERIFY UTILITIES & THEIR EXACT LOCATION PRIOR TO CONSTRUCTION.
- CONDUIT SHALL BE INSTALLED BEFORE PLACING OF NEW PAVEMENT.
- SEE SHEET 6 "TRAFFIC SIGNAL INSTALLATION DETAIL SHEET" (TR-105) FOR SIGN SPACING AND ADDITIONAL DETAILS.



TRAFFIC SIGNAL PLANS FOR
135TH STREET WEST AND CENTRAL AVE
 WICHITA, KS

©2024 MKEC Engineering All Rights Reserved
 www.mkec.com
 These drawings and their contents, including, but not limited to, all concepts, designs, & ideas are the exclusive property of MKEC Engineering (MKEC), and may not be used or reproduced in any way without the express consent of MKEC.

TRAFFIC SIGNAL PLAN 135TH AND CENTRAL

PROJECT NO.	472-2024-086048	
DATE	7/16/2024	
SCALE	1"=20'	
DESIGNED	JRA	
DRAWN	WNJ	
CHECKED	JRA	
NO.	REVISION	DATE
SHEET NO.		
4 OF 15		