

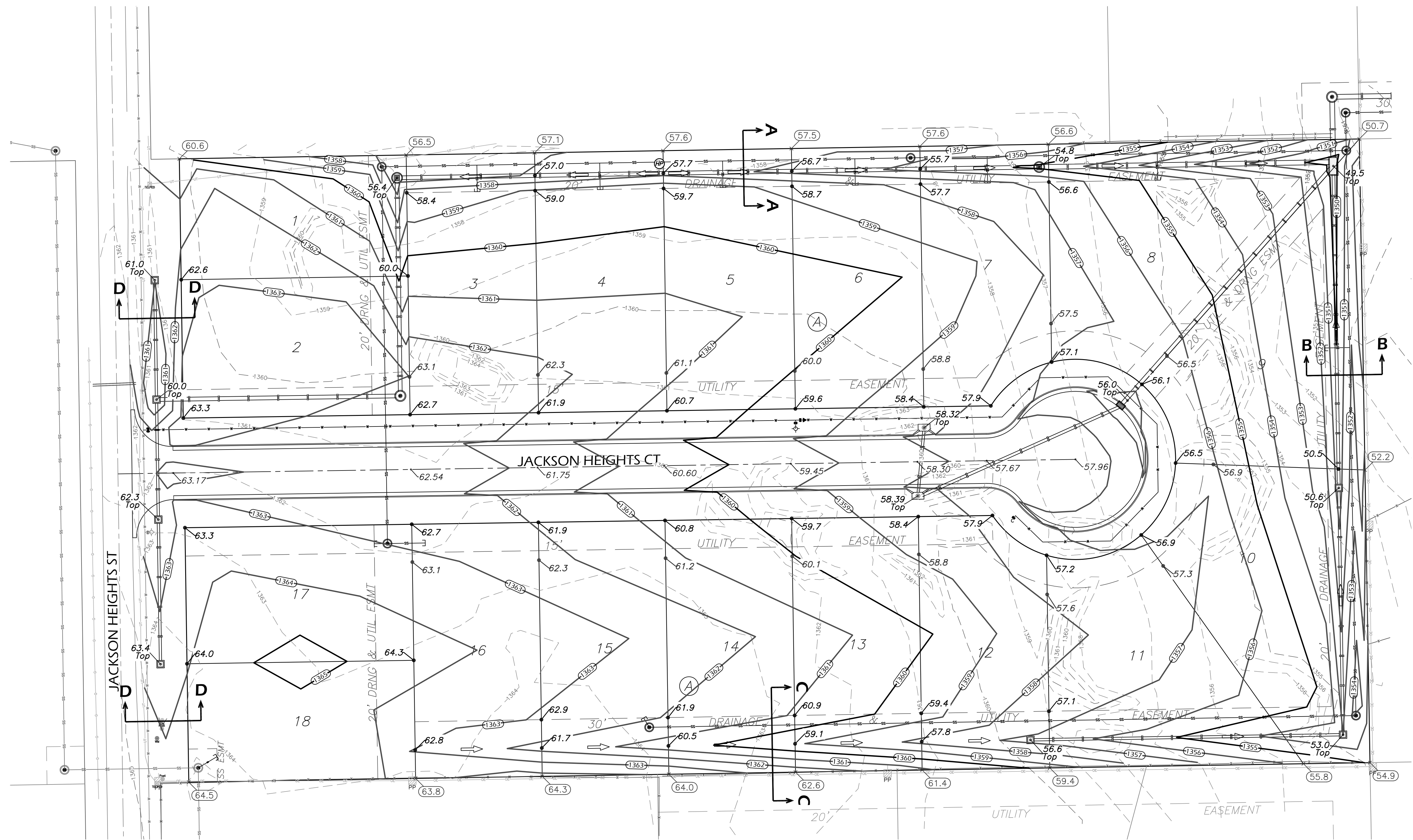

PAVING IMPROVEMENTS
JACKSON HEIGHTS TOWNHOMES
2ND ADDITION
WICHITA, KANSAS



LEGEND

CONTOURS
EXIST. - - - - -
PROP. - - - - -

SPOT GRADES
PROPOSED XX.X

MATCH EXISTING (XX.X)

GRADING LIMITS [Dashed Box]

EARTHWORK TOTALS:
(For Information Only)
(Unadjusted for Shrink & Swell)

Excavation: 4,850 C.Y.
Compaction (90%): 3,840 C.Y.
Compaction (95%): 370 C.Y.

- NOTES:**
- Top 3" of soil shall be stripped and stockpiled on site. Following grading operations, a minimum of 3" of topsoil shall be placed in all areas outside of street right-of-way.
 - Remove Existing Trees as Necessary for Construction. All Associated Costs are Subsidiary to Lump Sum Bid Item "Site Clearing".
 - Compaction of 95% Standard Proctor Density shall be obtained in all areas. Fill shall be placed with moisture content of optimum to 4% at the time of placement. Compaction testing for all lots shall be the responsibility of the contractor. One test per lot per one foot of fill shall be required. All cost associated with this testing shall included in the lump sum bid "Contractor Testing".
 - Street elevations shown on this sheet are to top of pavement.
 - Contractor to spread excess material evenly across all lots.

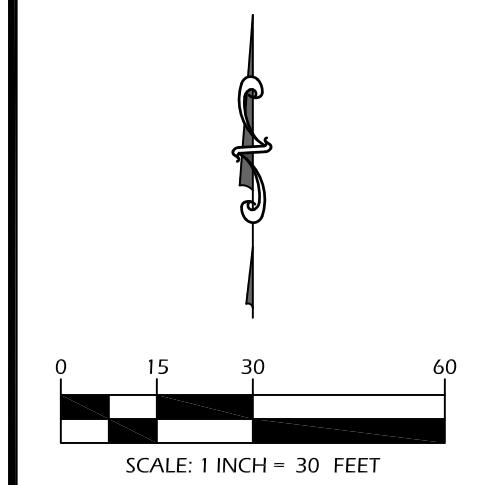
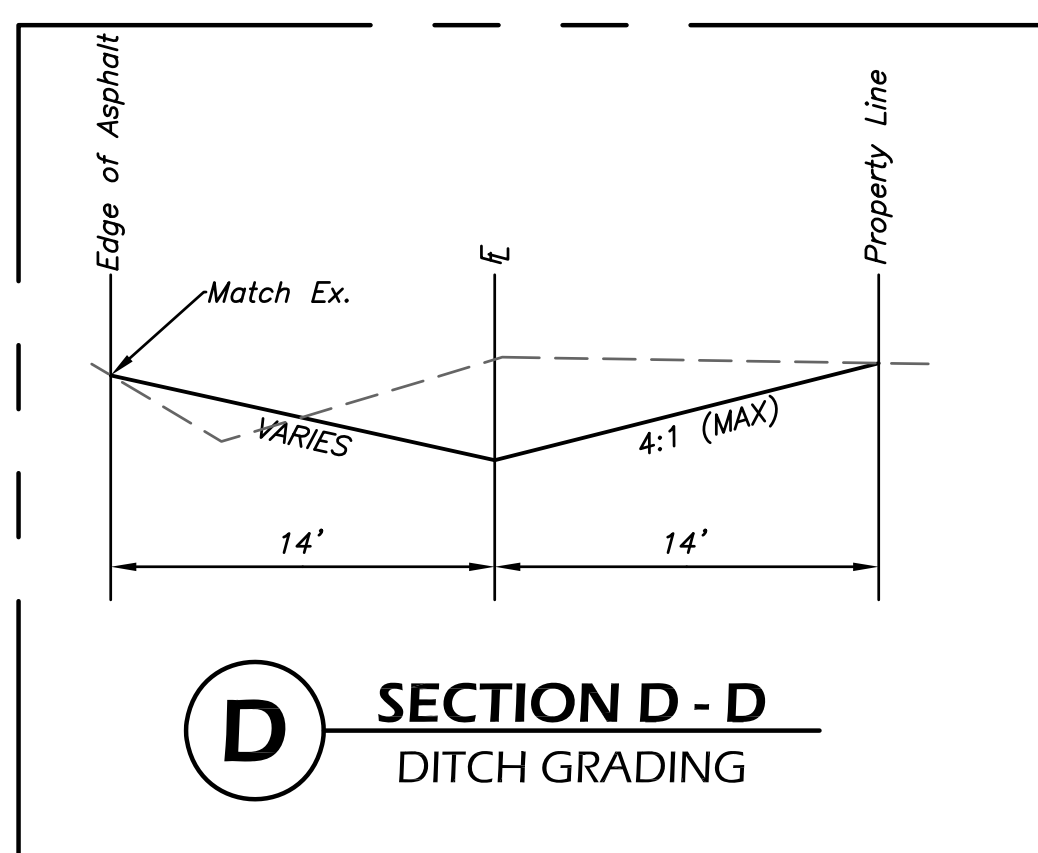
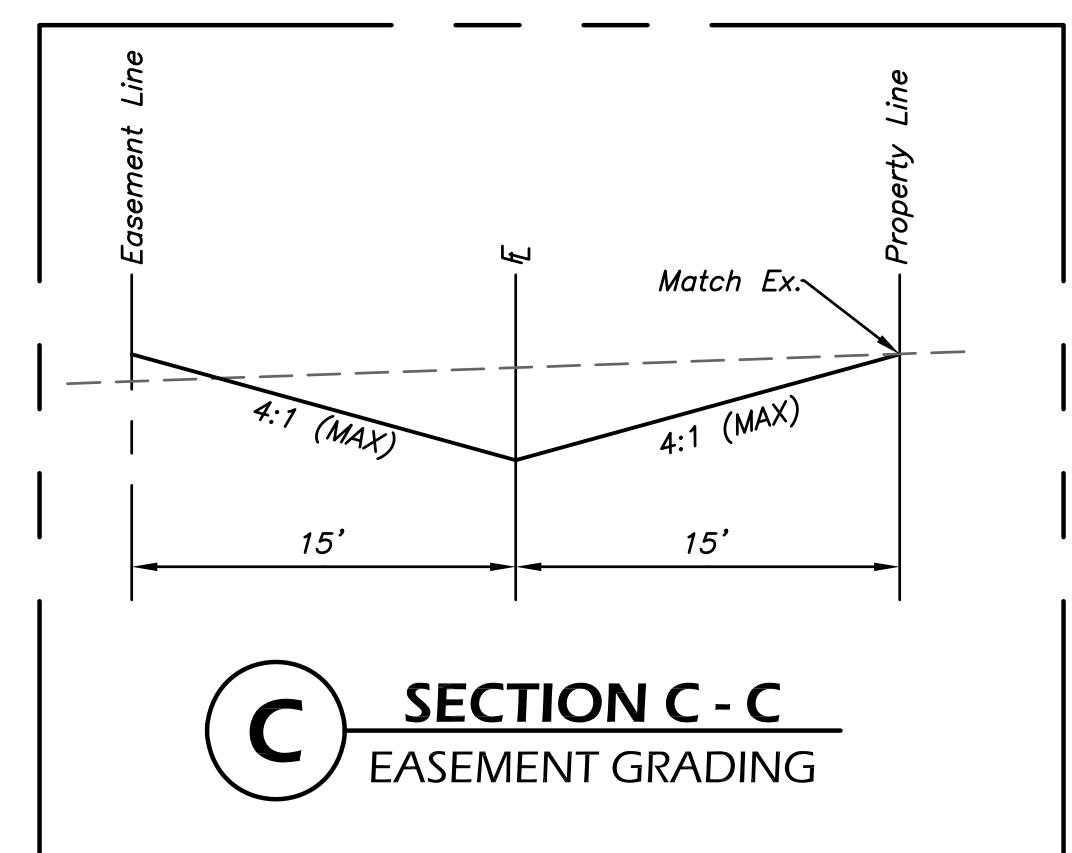
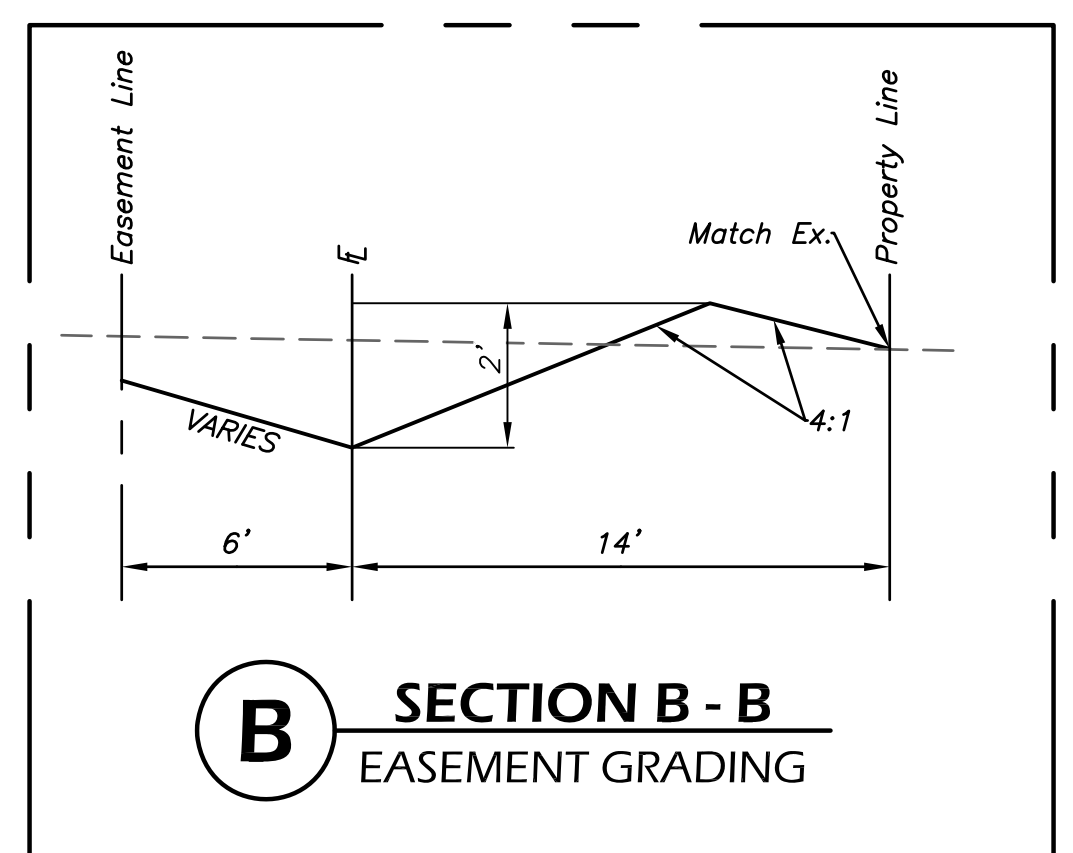
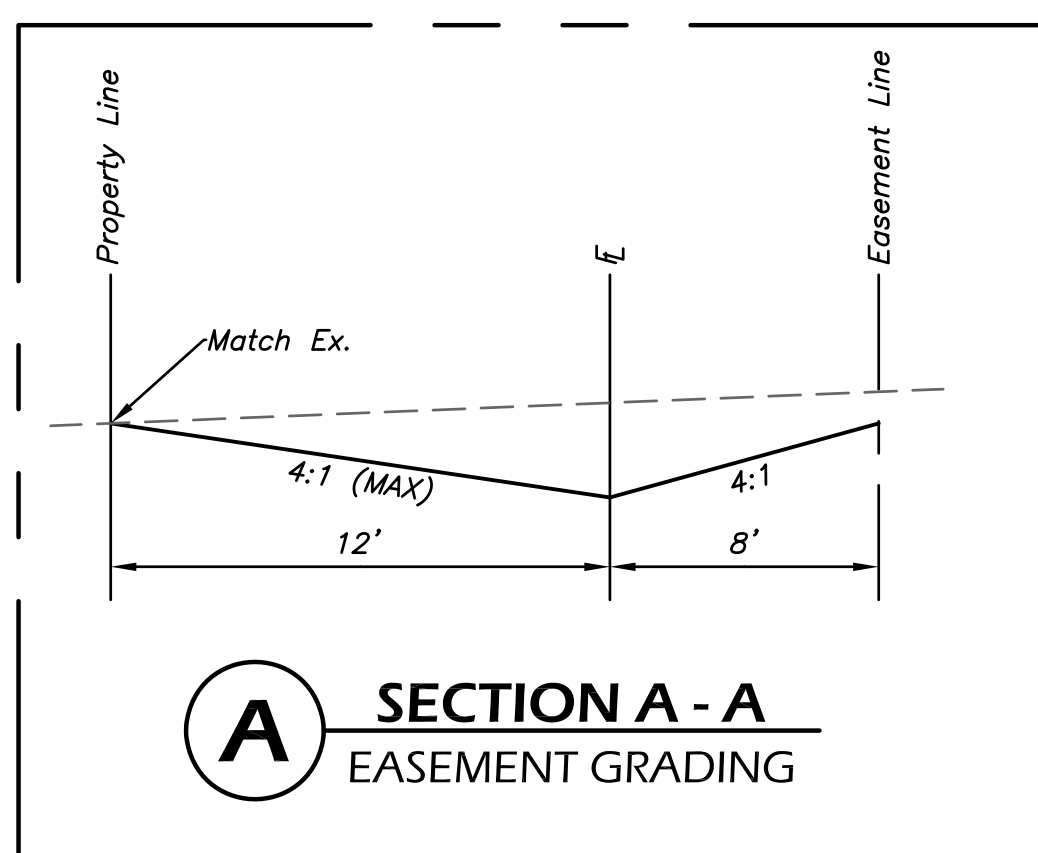

REVISIONS

KEM PROJ. 23044	DATE 08.2024
DESIGNED KEM	DRAWN ZJS

Mass Grading Plan