

File: L:\2023\F02-2301675 - Wichita Downtown Park Restrooms\Drawings\CAD_BIM_Sheets\Nafziger Park\WDRN_CS101-SITE PLAN.dwg Last Save: 3/19/2024 4:08 PM Last saved by: C:\Wyant
 Last plotted by: Wyant, Charles J. (C.) Plot Date: 5/20/2024 2:41 PM Plotter used: AutoCAD PDF (General Documentation).pc3

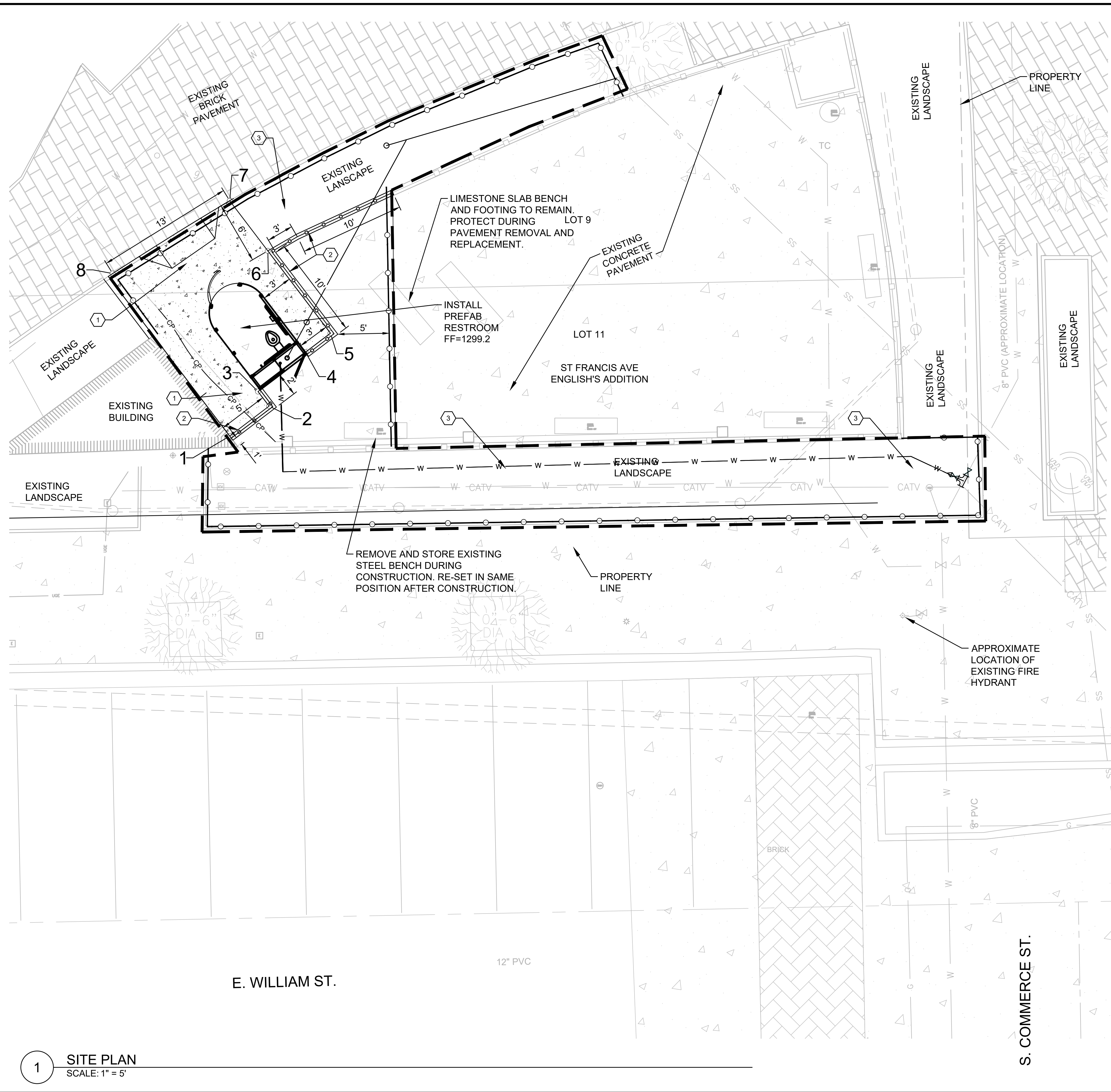

LEGAL DESCRIPTION

LOTS 7-9, VACANT ALLEY & ADJACENT LOTS ON THE EAST EXCEPT THE POINT DESCRIBED AS BEGINNING AT SOUTHWEST CORNER OF 12 THEN WEST 1.65 FEET NORTH, 75 FEET M/L, 1.78 FEET TO THE NORTHWEST CORNER OF LOT 8, THEN SOUTH 75 FEET TO THE BEGINNING 4TH, NOW ST FRANCIS AVE ENGLISH'S ADDITION. EXEMPT NO. 1998-6592-TX

SITE INFORMATION

TOTAL AREA:	+913.6 sq. ft. (0.02 acres)
DISTURBED AREA:	+913.56 sq. ft. (0.02 acres)
BUILDING AREA (EXISTING AND PROPOSED):	+52.6 sq. ft. (0.001 acres)
IMPERVIOUS AREA, PRE-CONST.:	+283.7 sq. ft. (0.007 acres)
IMPERVIOUS AREA, POST-CONST.:	+294.7 sq. ft. (0.007 acres)

BENCHMARKS

BENCHMARK: CHISELED SQUARE ON THE TOP OF CURB ON THE SOUTH CURB RETURN AT THE SOUTHEAST CORNER OF ST. FRANCIS AND WILLIAMS ST.,
 ELEVATION = 1297.49 (NAVD88, G12B)

KEYNOTES

- 1 INSTALL 4" CONCRETE SIDEWALK
- 2 INSTALL DOG PARK FENCING TO MATCH EXISTING IN KIND
- 3 INSTALL PROPOSED LANDSCAPING. SEE LANDSCAPING PLAN, SHEET L-101

GRADING NOTES

TOP SURFACE OF VALVE BOXES AND MANHOLES SHALL BE FLUSH WITH ADJACENT TURF SURFACE

LEGEND

	PROVIDE CONCRETE SIDEWALK PAVEMENT
	EXISTING BUILDING FOOTPRINT
	LIMITS OF CONSTRUCTION
	DECORATIVE DOG PARK FENCE
	TEMPORARY CONSTRUCTION FENCE

CONTROL POINTS

POINT NUMBER	NORTHING	EASTING	DESCRIPTION
1	1,685,488.77	1,650,717.05	WALL
2	1,685,491.63	1,650,720.82	WALL
3	1,685,493.03	1,650,719.76	WALL
4	1,685,496.80	1,650,724.31	WALL
5	1,685,498.61	1,650,726.69	WALL
6	1,685,506.50	1,650,720.70	WALL
7	1,685,511.29	1,650,717.06	SIDEWALK
8	1,685,504.32	1,650,705.85	SIDEWALK

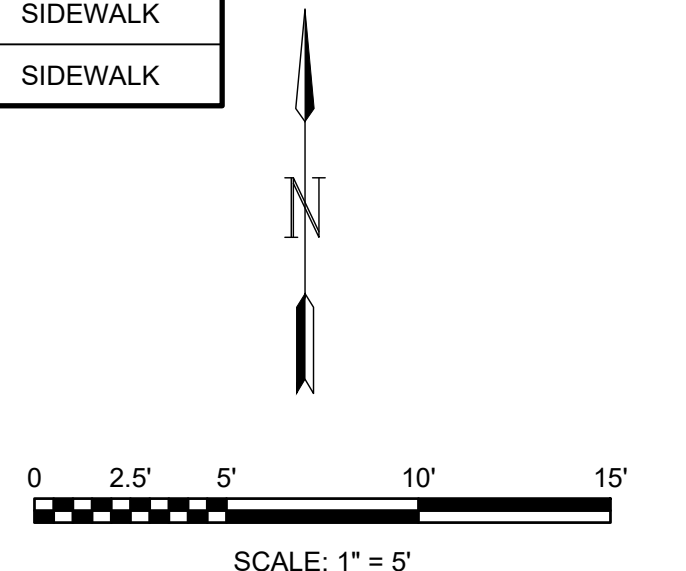

1 SITE PLAN
 SCALE: 1" = 5'



© 2023 GARVER, LLC
 THIS DOCUMENT, ALONG WITH THE IDEAS AND DESIGNS CONVEYED HEREIN, SHALL BE CONSIDERED INSTRUMENTS OF PROFESSIONAL SERVICE AND ARE PROPERTY OF GARVER, LLC. ANY USE, REPRODUCTION, OR DISTRIBUTION OF THIS DOCUMENT, ALONG WITH THE IDEAS AND DESIGN CONTAINED HEREIN, IS PROHIBITED UNLESS AUTHORIZED IN WRITING BY GARVER, LLC OR EXPLICITLY ALLOWED IN THE GOVERNING PROFESSIONAL SERVICES AGREEMENT FOR THIS WORK.

1995 Midfield Road
 Wichita, KS 67209
 (316) 264-8008



REV.	DATE	DESCRIPTION	BY

CITY OF WICHITA
 WICHITA, KS 67202
 2024 PARK FACILITY ENHANCEMENTS- NAFZIGER PARK RESTROOMS PROJECT

SITE PLAN

JOB NO.: F02-2301675
 DATE: MAR. 2024
 DESIGNED BY: SRS
 DRAWN BY: JSB

BAR IS ONE INCH ON ORIGINAL DRAWING
 IF NOT ONE INCH ON THIS SHEET, ADJUST SCALES ACCORDINGLY.

DRAWING NUMBER
CS101

SHEET NUMBER
5