

File: I:\2023\102-2301675 - wichita downtown park restrooms\CAD\_BIML\_Sheets\A\_Price Woodard\WDRA\_VF101-EXIST CONDITIONS.dwg Last Saved: 5/20/2024 2:59 PM Last saved by: CJWyant  
Last plotted by: Wyant, Charles J. (CJ) Plot Style: --- Plot Scale: 1:1 Plot Date: 5/20/2024 3:04 PM Plotter used: AutoCAD PDF (General Documentation).pc3

Wichita-Sedgwick County  
Metropolitan Area Building  
and Construction Department  
**REVIEWED FOR CODE COMPLIANCE**  
CORRECTIONS OR COMMENTS MADE ON THESE DRAWINGS AND THIS DOCUMENT DURING THIS REVIEW DO NOT RELIEVE CONTRACTOR FROM COMPLIANCE WITH ALL REQUIREMENTS OF THE CODE OF THE MARCD, THE CITY OF WICHITA OR ANY OTHER APPLICABLE CODES. CONTRACTOR IS RESPONSIBLE FOR VERIFYING AND CORRELATING ALL INFORMATION TO PROVISIONS OF SECTION 107.4 OF THE 2012 INTERNATIONAL BUILDING CODE.  
DATE: 07/29/24 BY: William Jerauld Jr



© 2023 GARVER, LLC  
THIS DOCUMENT, ALONG WITH THE IDEAS AND DESIGNS CONVEYED HEREIN, SHALL BE CONSIDERED INSTRUMENTS OF PROFESSIONAL SERVICE AND ARE PROPERTY OF GARVER, LLC. ANY USE, REPRODUCTION, OR DISTRIBUTION OF THIS DOCUMENT, ALONG WITH THE IDEAS AND DESIGN CONTAINED HEREIN, IS PROHIBITED UNLESS AUTHORIZED IN WRITING BY GARVER, LLC OR EXPLICITLY ALLOWED IN THE GOVERNING PROFESSIONAL SERVICES AGREEMENT FOR THIS WORK.  
1995 Midfield Road  
Wichita, KS 67209  
(316) 264-8008

**KANSAS ONE CALL**

CONTRACTOR SHALL BE REQUIRED TO PROVIDE NOTICE TO KANSAS ONE CALL AT 287-2470 A MINIMUM OF THREE (3) WORKING DAYS PRIOR TO ANY EXCAVATION OR WORK ADJACENT TO UTILITIES.  
KANSAS ONE CALL 1-800-DIG-SAFE

**UTILITY CONTACTS**

THE CONTRACTOR MUST NOTIFY THE FOLLOWING IN CASE OF AN EMERGENCY:

KANSAS GAS SERVICE (GAS).....	1-888-482-4950
BLACK HILLS ENERGY (GAS).....	1-800-303-0357
EVERGY (ELECTRIC).....	383-8650
COX COMMUNICATIONS (TELECOMMUNICATIONS).....	262-4270
AT&T (TELECOMMUNICATIONS).....	268-2759
CITY OF WICHITA WATER DEPT. (WATER).....	268-4563
	OR 268-4908
CITY OF WICHITA SEWER MAINT. (SAN. SEWER).....	268-4024
	OR 262-6000
CITY OF WICHITA STORM SEWER MAINT. (STORM SEWER).....	268-4090
CITY OF WICHITA TRAFFIC MAINT. (TRAF. CONTROL).....	268-4034
	OR 268-4203
CONOCO PIPELINE CO. (PETROLEUM).....	1-800-231-2551
WILLIAMS PIPELINE CO. (PETROLEUM).....	529-6600
	OR 1-800-324-9696
PHILLIPS PIPELINE CO. (PETROLEUM).....	1-800-766-8230

**LEGAL DESCRIPTION**

Lot 1, Block 1 East Bank Development Addition

**SITE INFORMATION**

TOTAL AREA:	+4742.5 sq. ft. (0.11 acres)
DISTURBED AREA:	+4742.5 sq. ft. (0.11 acres)
BUILDING AREA (EXISTING AND PROPOSED):	+52.6 sq. ft (0.001 acres)
IMPERVIOUS AREA, PRE-CONST.:	+972.6 sq. ft. (0.02 acres)
IMPERVIOUS AREA, POST-CONST.:	+1145.3 sq. ft. (0.03 acres)

**BENCHMARKS**

**SURVEY CONTROL**  
PROJECT SCALE FACTOR: NONE  
STATE PLANE COORDINATES:

#100  
CHISELED SQUARE WITH "+" CUT ON WEST OF CONCRETE APRON AROUND INLET  
ELEVATION = 1299.79 (NAVD88, G12B)  
N 1685454.84  
E 1647545.07

#101  
CHISELED "+" ON TOP OF CURB ON SOUTH SIDE OF DOUGLAS  
ELEVATION = 1301.04 (NAVD88, G12B)  
N 1685435.59  
E 1647304.42

#102  
CHISELED "+" ON CONCRETE APPROACH TO LOWER ENTRANCE INTO CENTURY II  
ELEVATION = 1300.07 (NAVD88, G12B)  
N 1685216.53  
E 1647450.52

#100000  
1/2" REBAR IN THIMBLE, CENTER OF CIVIC CENTER PLACE, NORTH OF DOUGLAS AVENUE  
N 1685632.15  
E 1647633.04

#100001  
CHISELED + CUT ON WEST SIDE OF CENTURY II STREET, NORTH OF DOUGLAS AVENUE  
N 1685640.86  
E 1648104.98

#100002  
CHISELED + CUT ON EAST SIDE OF WACO AVENUE, NORTH OF DOUGLAS AVENUE  
N 1685628.85  
E 1647455.26

#100003  
5/8" Rebar ON WEST SIDE OF CENTURY II STREET  
N 1685384.26  
E 1648141.59

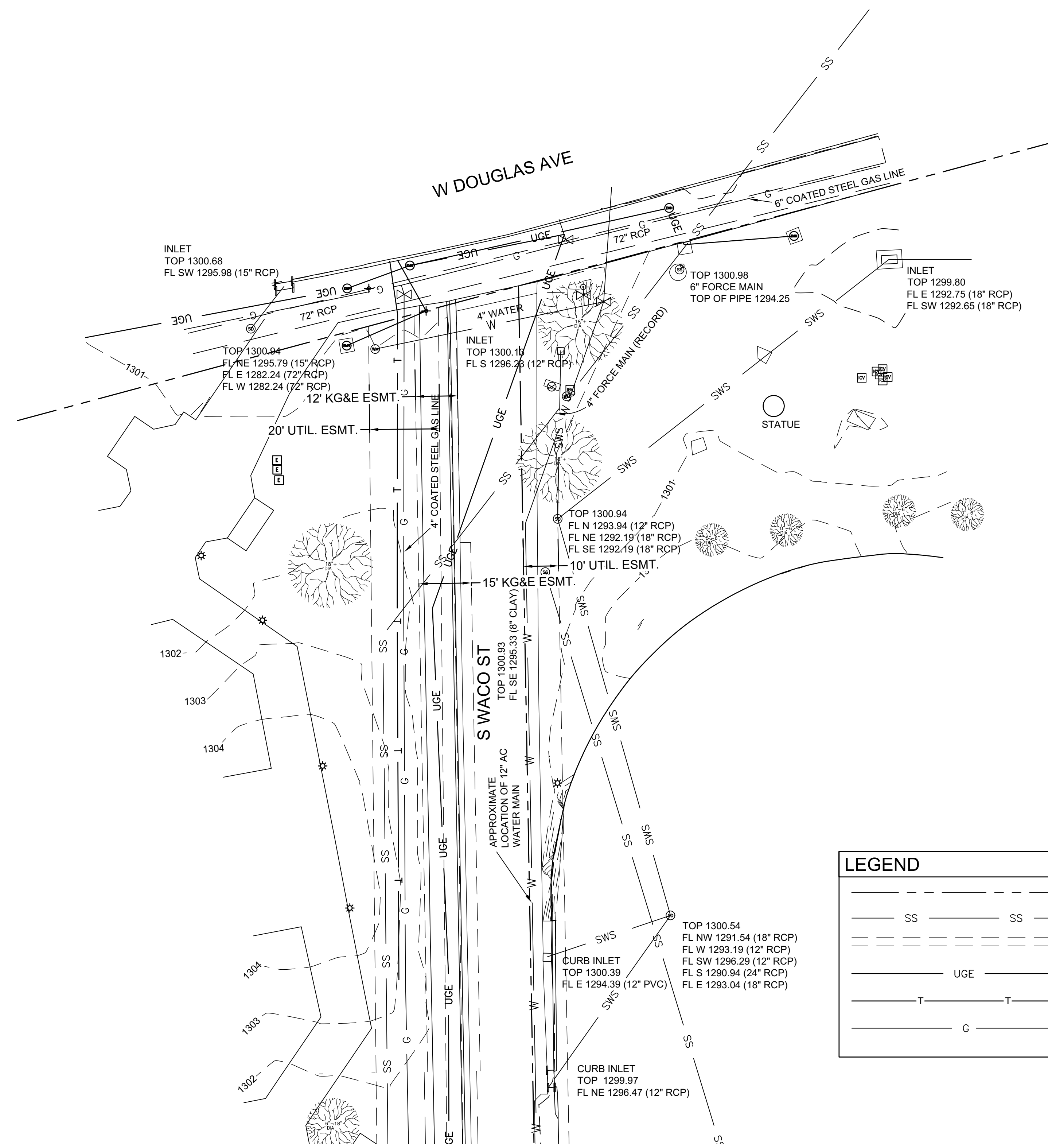

**LEGEND**

- ◆ ..... FIRE HYDRANT
- ⊗ ..... WATER VALVE BOX
- ⊙ ..... WATER METER
- ⊠ ..... IRRIGATION CONTROL VALVE
- \* ..... GROUND LIGHT
- ⊞ ..... ELECTRIC BOX
- ⊛ ..... LIGHT POLE
- ⊕ ..... ELECTRIC MANHOLE
- ⊖ ..... STORMWATER MANHOLE
- ⊞ ..... STORMWATER SEWER CATCH BASIN
- ⊞ ..... BUSH
- ⊞ ..... DECIDUOUS TREE 18" AND ABOVE
- ⊞ ..... DECIDUOUS TREE 6-18" DIA
- ⊞ ..... DECIDUOUS TREE 0-6" DIA
- ⊙ ..... BENCHMARK
- ⊗ ..... UNKNOWN VALVE BOX

**LEGEND**

- PROPERTY LINE
- SS ..... SANITARY SEWER (CITY OF WICHITA)
- STORMWATER DRAIN (CITY OF WICHITA)
- UGE ..... UNDERGROUND ELECTRIC (EVERGY)
- T ..... UNDERGROUND TELEPHONE (AT&T)
- G ..... NATURAL GAS LINE (BLACK HILLS)

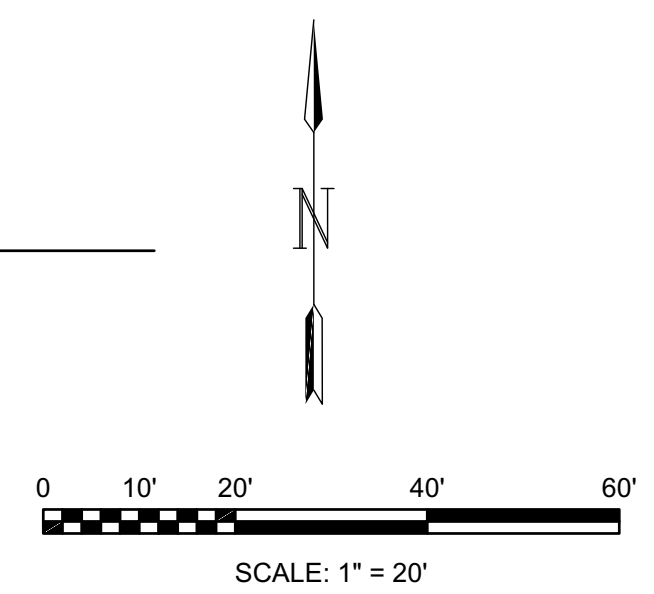

**1 EXISTING CONDITIONS**  
SCALE: 1" = 20'

REV.	DATE	DESCRIPTION	BY

CITY OF WICHITA  
DEPT. OF PARKS AND RECREATION  
WICHITA, KS 67202

2024 PARK FACILITY  
ENHANCEMENTS-  
A. PRICE WOODARD  
RESTROOMS PROJECT

**EXISTING CONDITIONS**

JOB NO.: F02-2301675  
DATE: FEB. 2024  
DESIGNED BY: SRS  
DRAWN BY: CJW

BAR IS ONE INCH ON ORIGINAL DRAWING  
IF NOT ONE INCH ON THIS SHEET, ADJUST SCALES ACCORDINGLY.

DRAWING NUMBER  
**VF101**

SHEET NUMBER  
**3**