

SAVED 9/30/2024 3:10:03 PM BY LUKE.PETER
 PLOTTED 10/10/2024 1:55:30 PM BY LUKE.PETER
 U:\WICHITA-CIVIL\2024\1210254\001\PEC\DRAWINGS\210254-001-CT552 TRAFFIC CONTROL CHANNELIZING DEVICES-TE702.DWG

Drawn By : mushock
 File : te702.dgn
 Plotted : 29-MAR-2018 12:40
 Traffic

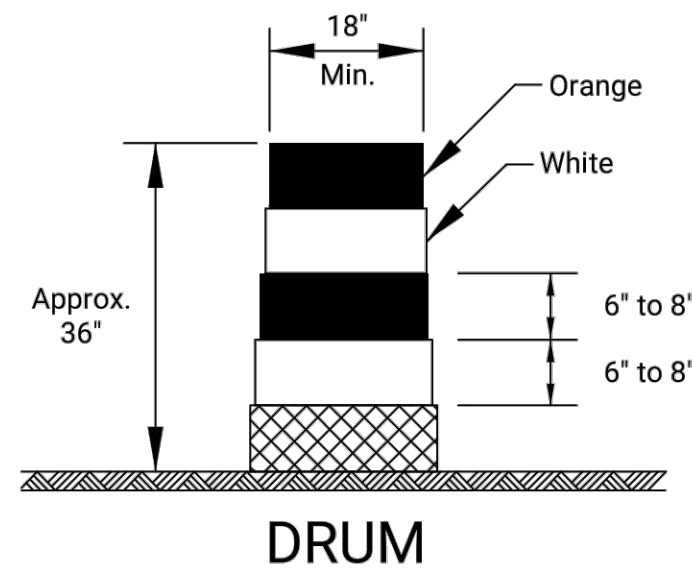

DRUM

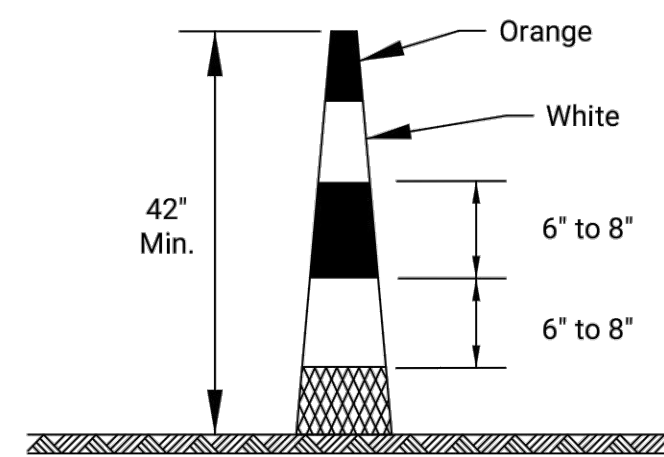

CONICAL DELINEATOR

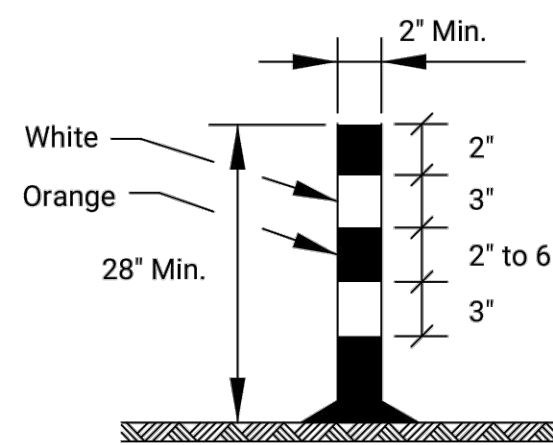

TUBULAR MARKER
Striping as shown for up to 42".

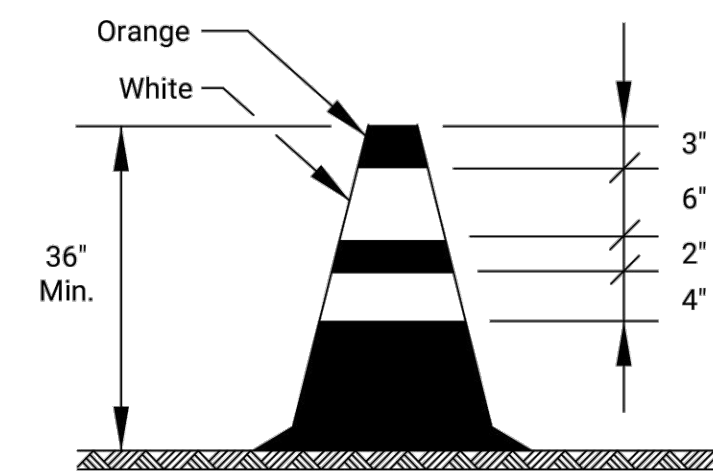

TRAFFIC CONE

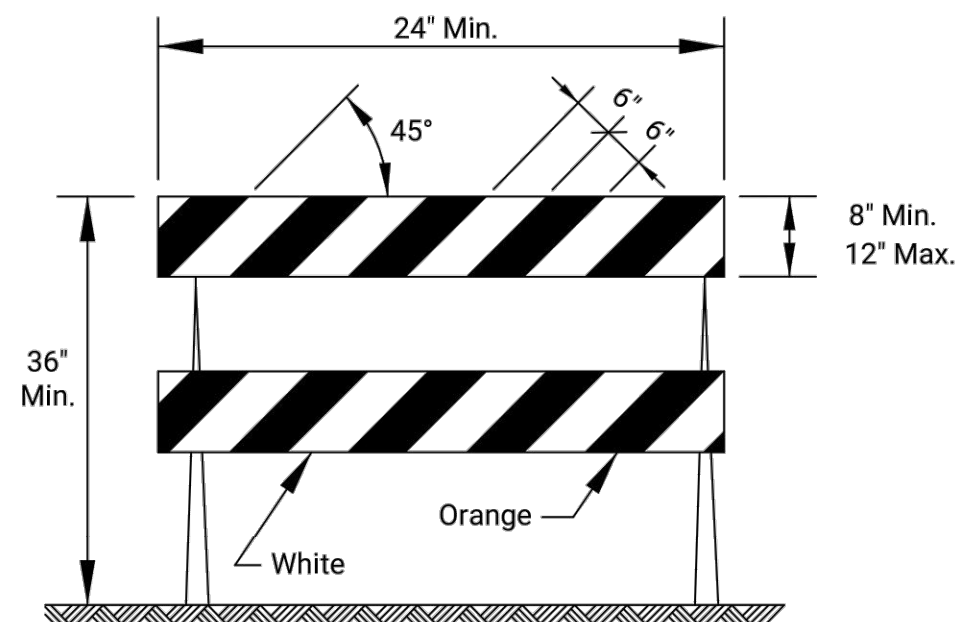

TYPE 2 BARRICADE

For rails less than 36" long, 4" wide stripes may be used. All stripes shall slope downward to the traffic side for channelization.

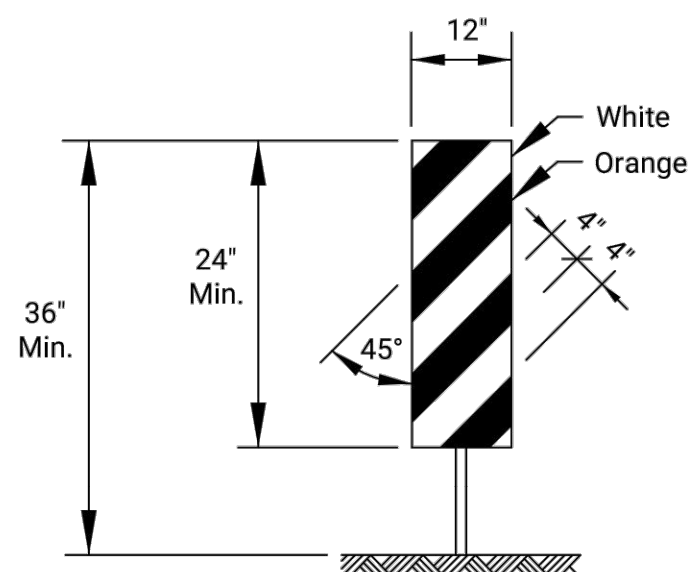

VERTICAL PANEL

The stripes shall slope downward to the traffic side for channelization.

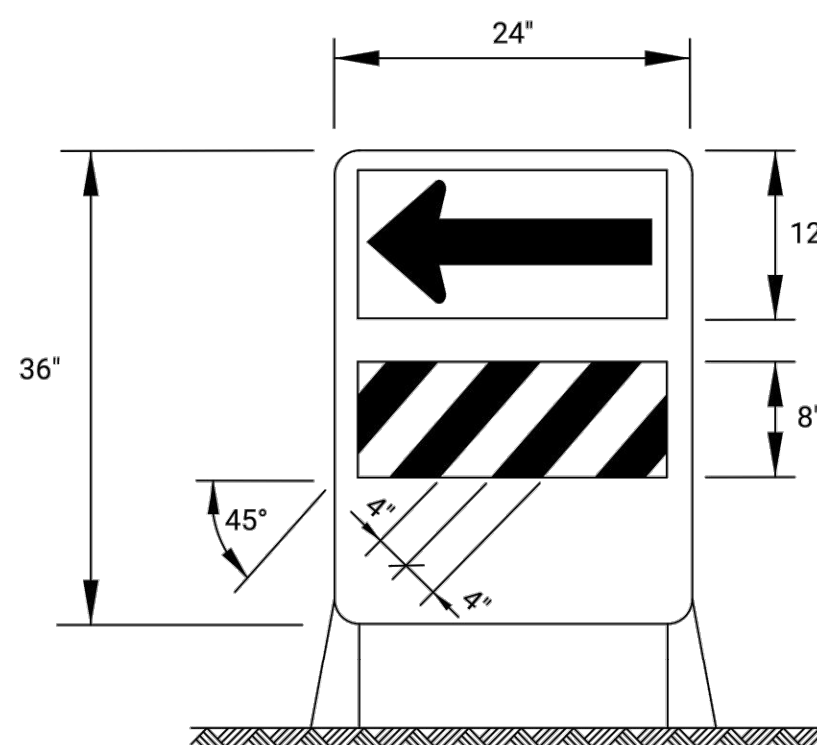

DIRECTION INDICATOR BARRICADE

The stripes shall slope downward in the direction traffic is to pass. The direction indicator barricade shall be used in series to direct the motorist into the intended lane of travel.

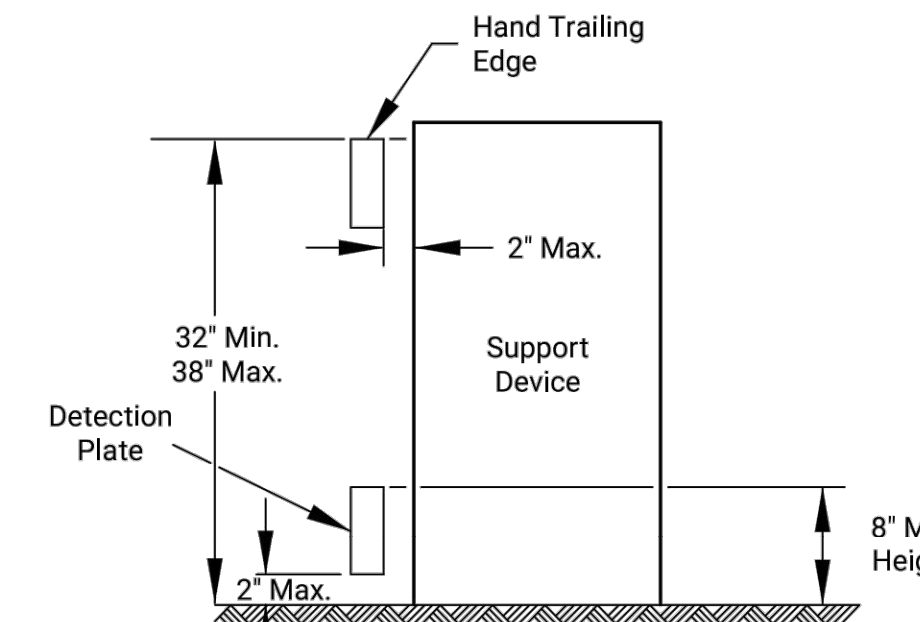

PEDESTRIAN CHANNELIZER

1. Support device shall not project beyond the detection plate into the pathway.
2. Hand trailing edges and detection plates are optional for continuous walls.
3. Interconnect pedestrian channelizers to prevent displacement and to provide continuous guidance through or around work.
4. Alternate pathways shall be firm, stable, and slip resistant.
5. Treat height differentials > 1/2" in the surfaces of alternate paths with a firm, stable, and slip resistant temporary ramp having a slope of 12:1 or flatter and having a width equal to the alternate path.
6. Use alternating orange/white on interconnected devices.

STATE	PROJECT NO.	YEAR	SHEET NO.	TOTAL SHEETS
KANSAS	XX-XX XX-XXXX-XX	XXXX	XXX	XXX

Item	Location	Location									
		Cross-overs	Shoofly Diversions	Tangents	Tapers	Ramps	Head to Head	Object Identifier	Lead-in Devices	Gores	
Portable	Drums	Yes	Yes	Yes	Yes	Yes	(1)	Yes	Yes	Yes	Yes
	Conical Delineators	Yes	Yes	Yes	Yes	Yes	(1)	Yes	Yes	Yes	Yes
	Vertical Panels	(2)	(2)	(2)	(2)	(2)	(1,2)	Yes	(2)	(2)	
	Direction Indicator Barricade	No	No	No	Yes	No	No	No	No	No	No
	Type 2 Barricade	(2)	(2)	(2)	(2)	No	No	Yes	No	No	No
Fixed	Tubular Markers	(3)	(3)	(3)	No	(3)	Yes	No	Yes	Yes	
	Vertical Panels	(3)	(3)	(3)	(3)	(3)	(3)	Yes	(2,3)	(2)	

- (1) Not allowed on centerline delineation along freeways or expressways.
- (2) The stripes shall slope downward to the traffic side for channelization.
- (3) May be used upon the approval of the engineer.
- (4) Daytime operations only.

NO.	DATE	REVISIONS	BY	APPD
3				
2				
1				

KANSAS DEPARTMENT OF TRANSPORTATION

TRAFFIC CONTROL CHANNELIZING DEVICES

TE702

DESIGNED	L.R.	DATE	06/01/15	APPD	Kristina Erickson
DESIGN CK.		DETAIL CK.		QUAN. CK.	

KDOT Graphics Certified 03-29-2018 Sh. No. XXX

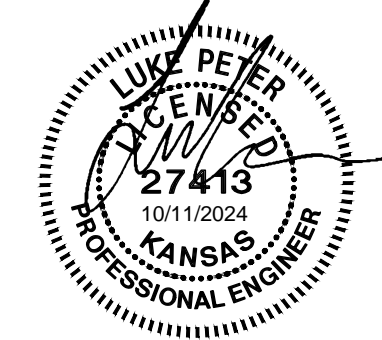

WEST STREET IMPROVEMENTS
 FROM MACARTHUR ROAD TO
 47TH ST. SOUTH
 CITY OF WICHITA

Issue:	
JOB NO.	210254-001
DATE	OCTOBER 2024
PM	TPA
DESIGNED BY	LGP
DRAWN BY	CP
CHECKED BY	KMS
TRAFFIC CONTROL CHANNELIZING DEVICES-TE702	