

LEGEND	
	WHEELCHAIR RAMP WITH DETECTABLE WARNING (10' WIDE)
	WHEELCHAIR RAMP WITH DETECTABLE WARNING (6' WIDE)

**NOTE:** ALL JOINTS WITHIN THE 9" REINFORCED CONCRETE PAVEMENT INTERSECTION SHALL BE TIED WITH #4 BARS 2' LONG SPACED ON 30" CENTERS IN ALL DIRECTIONS WITH 6" X 12" -W4 X W4 WELDED WIRE MESH

ALL SIDEWALK AT THE INTERSECTION OF 47TH STREET SHALL BE THICKENED TO 5"

CONCRETE PAVEMENT 9" (NRDJ)      CONCRETE PAVEMENT 9" (REINFORCED)      CONCRETE PAVEMENT 9" (NRDJ)

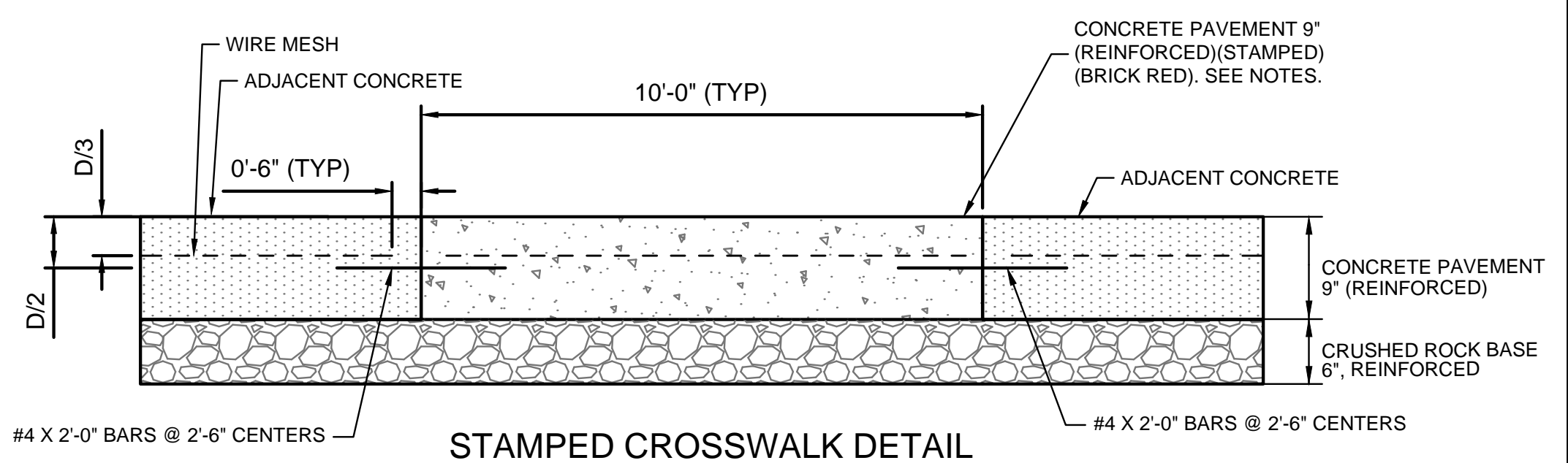
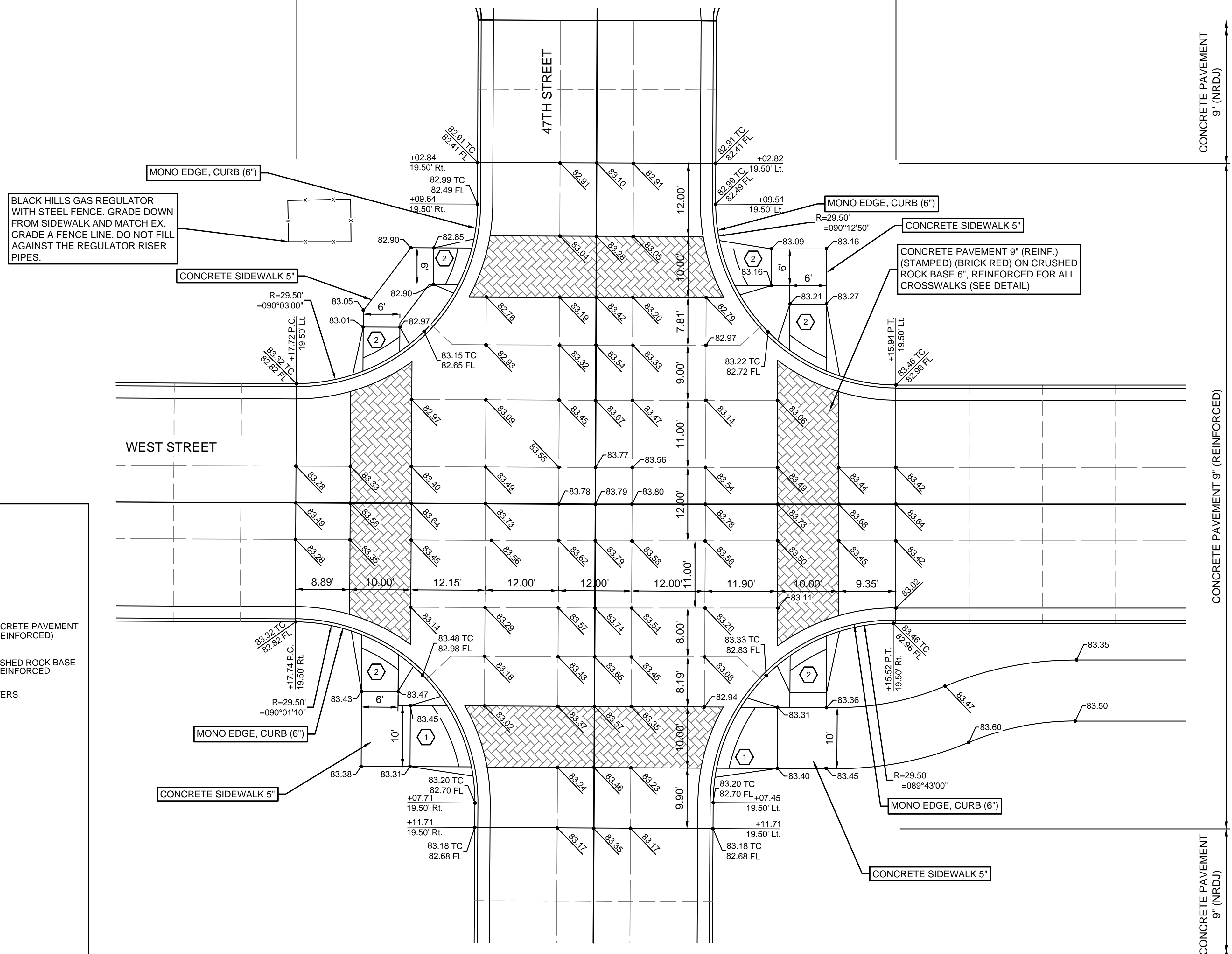

**NOTES:** CONCRETE PAVEMENT 9" (REINFORCED) (STAMPED) (BRICK RED)

PROVIDE POWDERED INTEGRAL COLOR BY DAVIS COLORS, PHONE 323.265.8323, WWW.DAVISCOLORS.COM. INTEGRAL COLOR SHALL MEET ASTM C 979. COLORS SHALL BE BRICK RED.

COLOR MIX RECIPE FOR BRICK RED:  
4 LBS. PIGMENT 160 (BRICK RED) PER 94 LBS. GREY CEMENT

PROVIDE COLOR RELEASE AND SEALER AS RECOMMENDED BY THE MANUFACTURER. SEALER SHALL HAVE A SEMI-GLOSS FINISH AND BE UV RESISTANT.

PROVIDE TEXTURING SEAMLESS SKIN BY BRICKFORM, PHONE 800.624.0261, WWW.SOLOMONCOLORS.COM/BRICKFORM. TEXTURE SHALL BE UNTEXTURED HERRINGBONE BRICK WITH 1/2" V-JOINTS, FM-5090.

THE ENGINEER WILL CONSIDER AN "EQUIVALENT" OF THE PRODUCTS SPECIFIED ABOVE. PROVIDE THE ENGINEER WITH A COMPLETE DESCRIPTION, LITERATURE, TEST REPORTS, ETC. ON THE PROPOSED "EQUIVALENT".

THE ENGINEER WILL ACCEPT THE MATERIALS ON THE BASIS OF NAME BRAND, AND VISUAL INSPECTION OF THE COMPLETED WORK.

**CONSTRUCTION REQUIREMENTS:**

PROVIDE THE ENGINEER WITH COPIES OF THE MANUFACTURER'S MATERIAL SAFETY AND TECHNICAL DATA SHEETS. THE TECHNICAL DATA MUST INCLUDE DETAILED APPLICATION INSTRUCTIONS.

COLOR AND TEXTURE CONCRETE AS RECOMMENDED BY THE MANUFACTURER.

PRIOR TO STARTING THE COLORED STAMPED CONCRETE PAVEMENT AT ANY PLAN LOCATIONS, THE CONTRACTOR SHALL PREPARE A TEST PANEL THAT EXHIBITS THE TEXTURE, COLOR AND UNIFORMITY OF THE FINISH. THE CONTRACTOR MAY BE REQUIRED TO PROVIDE MORE THAN ONE TEST PANEL IN ORDER TO REFINE THE WORK, COLOR AND PATTERN UNTIL IT IS APPROVED BY THE ENGINEER AND A REPRESENTATIVE FROM THE CITY OF WICHITA.

ALL MATERIALS, TOOLS, EQUIPMENT, LABOR, AND ANY INCIDENTALS NECESSARY TO COMPLETE THE COLORING AND STAMPING OF CONCRETE SHALL BE SUBSIDIARY TO THE RESPECTIVE BID ITEMS.



WEST STREET IMPROVEMENTS  
FROM MACARTHUR ROAD TO  
47TH ST. SOUTH  
CITY OF WICHITA

Issue:	
JOB NO.	210254-001
DATE	OCTOBER 2024
PM	TPA
DESIGNED BY	LGP
DRAWN BY	CP
CHECKED BY	KMS

INTERSECTION PLAN  
**CP401**  
44 OF 206

SAVED 10/8/2024 1:12:53 PM BY LUKE.PETER  
 PLOTTED 10/10/2024 1:36:59 PM BY LUKE.PETER  
 U:\WICHITA-CIVIL\2024\1\210254\001\PEC\DRAWINGS\32-210254-001-CP401 INTERSECTION PLAN.DWG