

GENERAL NOTES:

- The Contractor shall comply with all applicable safety regulations. All construction shall be completed following current City Standard Specifications and Special Provisions.
- Contractor will be required to provide notice to utility companies a minimum of seventy-two (72) hours prior to any excavation, as follows:
Kansas One-Call 687-2470
The Contractor must notify the following in case of an emergency:
AT&T 1-800-246-8464
Black Hills Energy 1-800-694-8989
City of Wichita Water & Sewer 1-316-219-8921
City of Wichita Stormwater 1-316-268-4090
City of Wichita Traffic 1-316-268-4034
Cox Communications 1-888-249-3530
Kansas Gas Service 1-888-482-4950
Energy 1-800-544-4857
- Utility service lines, poles, etc. are to be adjusted as necessary by others prior to construction unless the plans specifically call for their adjustment by the Contractor or unless the plans specifically identify a utility to be adjusted by its owner during construction. Existing utilities and their location, as shown on the plans, represent the best information obtainable for design. The Contractor will be required to work around existing utilities within the right-of-way which do not conflict with proposed construction.
- Rubble from the removal of miscellaneous structures and excess excavation which is to be wasted shall be disposed of on sites to be provided by the Contractor. These sites shall be approved by the Engineer as to suitability, appearance and site location. Locations, in the opinion of the Engineer, that will leave an unsightly appearance will not be approved. All disposal sites must be approved by the Kansas Department of Health and Environment. Material either stockpiled or disposed of in a flood plain will require a Kansas State Board of Agriculture permit. Any material dumped in waters of the United States or wetlands is subject to U.S. Corps of Engineers permitting regulations. Any material buried or stockpiled beyond approved construction limits will require additional archaeological investigations unless buried in a previously approved borrow location.
- Trees and shrubs in public right-of-way which are in direct conflict with proposed new construction shall be removed by the Contractor with the City Engineer's approval. Trees and shrubs which are not in direct conflict with proposed new construction shall be saved and protected from damage.
- The Contractor shall give all property owners and/or tenants of developed property abutting the construction of this project a minimum of ten (10) days notice prior to start of construction.
- The Contractor shall be responsible for preserving property irons. The Contractor will be required to re-establish any property irons which are damaged or destroyed by his construction operations. Such irons shall be re-established by a licensed land surveyor in accordance with state laws.
- The Engineering Division shall field locate water valve one time during construction when requested by the Contractor. It shall be the Contractor's responsibility to preserve such field locations during the construction process. Water valves, valve boxes or fire hydrants damaged during construction shall be repaired by Contractor at his own expense. Valve boxes and water meters within the project limits shall be adjusted to match field grades by the contractor.
- The Contractor shall notify the consultant engineer and Dawnita Reinhardt at 316-650-0740 with the City of Wichita with the anticipated construction start date and notify them of project completion. Staking and inspection for this project will be the responsibility of the Contractor.
- If traffic will be impacted by construction, a traffic control plan must be submitted and approved by the City Traffic Engineer at traffic@wichita.gov before construction can begin. The Contractor shall be responsible for all traffic control measures to facilitate construction. All construction zone markings and signage shall conform to the latest version of Manual on Uniform Traffic Control Devices (MUTCD) as published by the US Dept. of Transportation, Federal Highway Administration. All costs associated with construction markings and signage shall be the Contractors responsibility.
- All elevations shown are NAVD88.
- All areas disturbed during construction that will not be under proposed pavement shall be restored to match existing conditions per City specifications.
- A portion of excess excavated material shall be mounded around manholes which extend more than one (1) foot above the existing ground. Such mound shall be constructed with new development a six (6) foot diameter flat top with 4 to 1 side slopes down to the original ground. The elevation of the flat top of the mound shall be 0.4 foot below the top to the manhole.
- Contractor shall limit the extent of trench openings overnight and weekends to less than 50 feet.
- The inspecting firm shall submit to the City Stormwater Maintenance Division a digital copy of the CCTV inspection of the conduits and structures following construction. The digital file formation shall be compatible with the City input template. A copy of the template is available upon request at 316-268-4090.
- The Contractor shall protect from damage and support existing utilities through construction as approved by the utility owner and the Engineer at the contractor's expense.
- All existing and proposed erosion control measures including silt fencing, erosion control mat, straw bales, inlet barriers, and const. entrance shall be maintained throughout construction by the contractor and until project is accepted by the City of Wichita. The on-site engineer shall complete weekly reports on the status of erosion control measures. The contractor shall be required to comply with maintenance and/or replacement of erosion control measures as determined by the on-site engineer until project is accepted by City of Wichita. Maintenance and/or replacement of erosion control measures to be paid by L.S. bid item "Maintain Existing BMPs".
- All areas disturbed during construction are to be seeded as follows:
Seed -- Rye grass; 5 lbs./1000 Sq. Ft.
All costs associated with seeding including mobilization, preparation of ground, seeding, fertilizing, mulching, etc. shall be included in the L.S. bid item "Seeding".
- The Contractor shall not begin work on the project until the Project Inspector is assigned and on site. Any work completed without inspection will be required to be uncovered for inspection at the Contractor's expense.

STORM SEWER IMPROVEMENTS to serve **USD 259 ROBINSON MIDDLE SCHOOL**

328 N. OLIVER
CITY OF WICHITA, KANSAS
Paul Gunzelman, P.E. Interim City Engineer

2023-000829PPD
56030970

AS BUILTS

Contractor: Apex 10/06/2023	Project Inspector: Larry Gann KEMILLER ENGINEERING PA 117 E. Lewis, Wichita, KS 67202 (316)264-0242
--	--

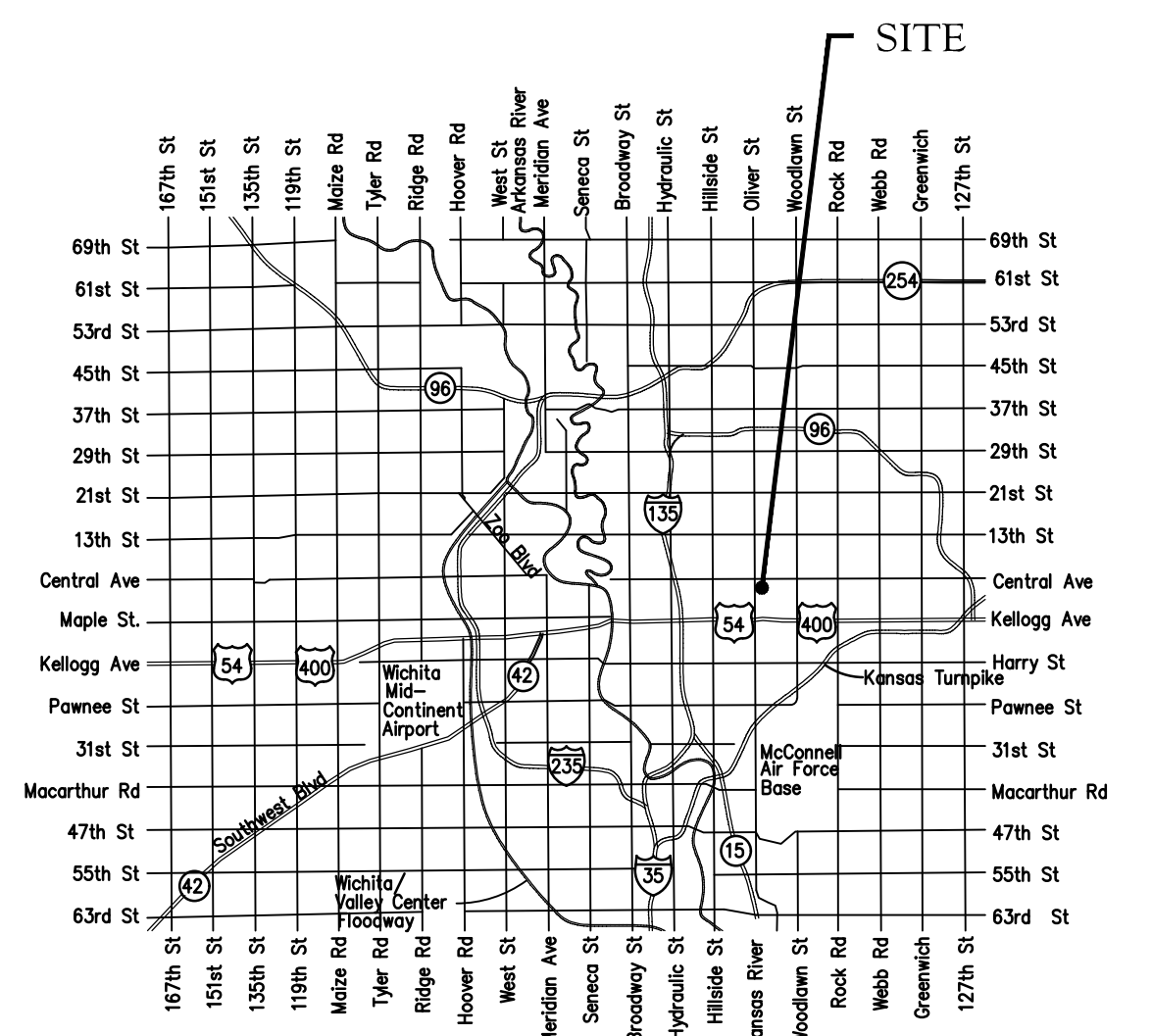
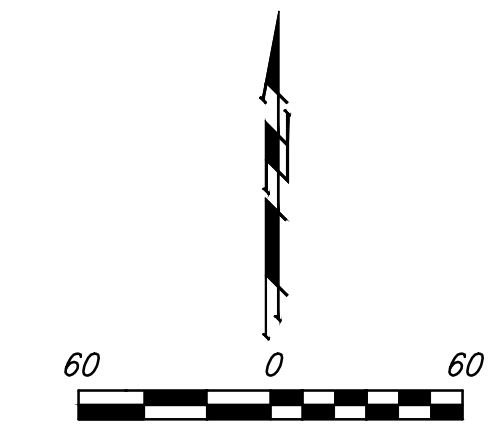

Vicinity Map

Stormwater Certification:
New Development or Redevelopment (Circle One)
Stormwater Permit # SW2015-0058
NOI Permit # NA - 0.35 Acre Disturbed

These construction plans were prepared in accordance with the current Stormwater management Regulations as set forth in the City of Wichita's Stormwater Management Ordinance 16.32 and the policies/guidelines presented in the Wichita/Sedgwick County Stormwater Manual.

Site Area (Acres) = 174,476 sq. ft. 4.01 acres
Disturbed Area (Acres) = 15,128 sq. ft., 0.35 Acre
Water Quality Treatment: Sump and Spout in Area Inlet
Downstream Channel Protection: NA
Detention: NA
The BMP used for this development is Silt Fence

Sheet Index

Title Sheet	1
Line 1	2
Erosion Control/Grading Plan	3
Erosion Control BMP Details	4-8
Copy of Plat	9

Benchmarks

- BM #1: "□" chiseled on top of curb, north side of 2nd Street between Oliver & Glendale. Elevation = 1357.12 (NAVD 88)
- BM #2: "□" chiseled on top of curb, north side of 2nd Street between Glendale and Bleckley. Elevation = 1354.99 (NAVD 88)
- BM #3: "□" chiseled on top of south end of wall, near southeast corner of entry to dumpster area. Elevation = 1358.52 (NAVD 88)

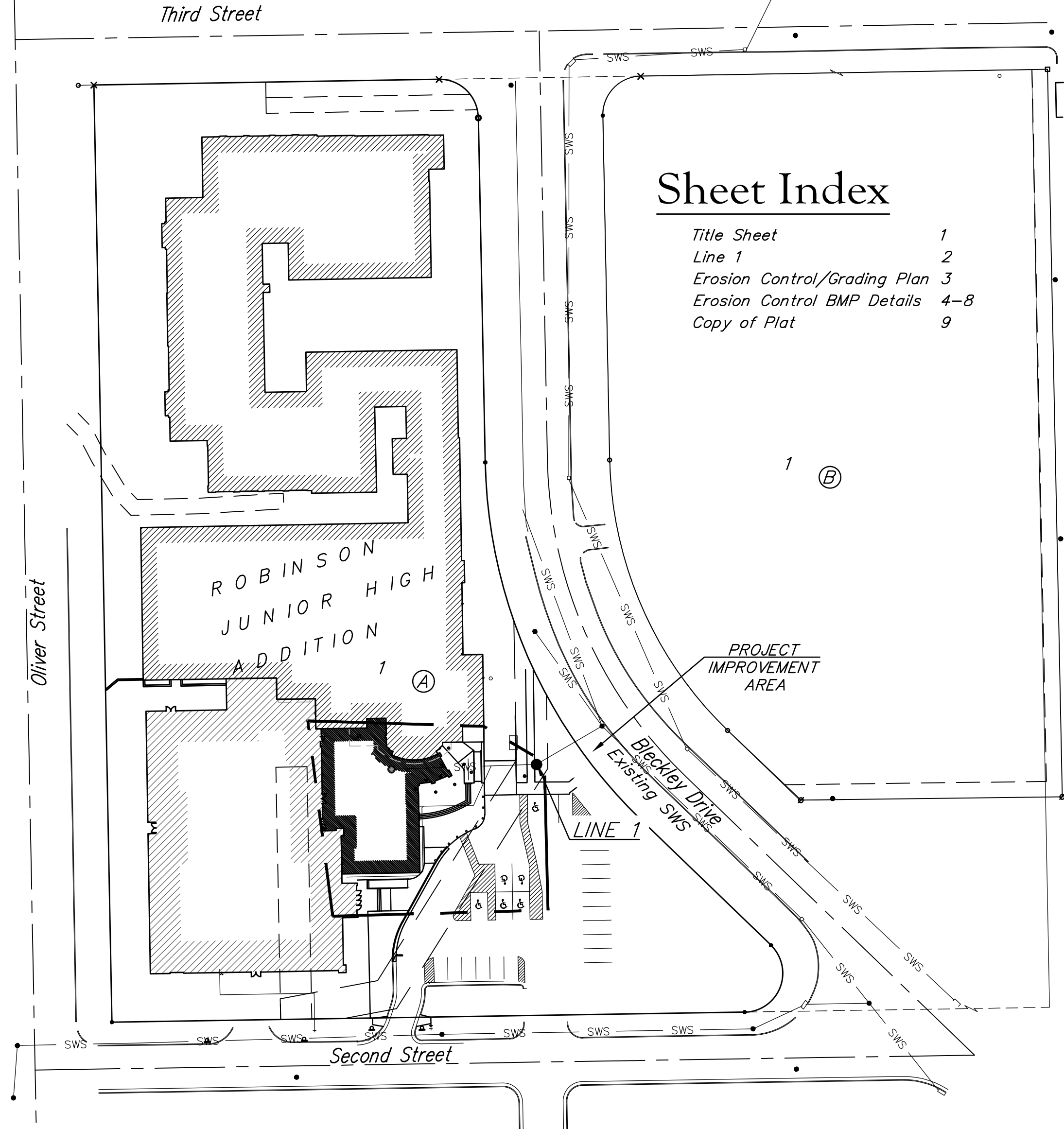

APPROVED AS NOTED
BY WICHITA PUBLIC WORKS ENGINEERING AND STORMWATER DIVISION

Engineering approved by Shawn Mellies PE on 08-14-2023

Stormwater approved by Joe Hickle PE on 08-14-2023

NOTE TO CONTRACTORS
Inspection and testing for this project is to be provided by a Licensed Consulting Engineering Firm under contract with the Owner/Developer. Said Inspection to be in accordance with the City of Wichita standard construction engineering practices and certified by a Licensed Professional Engineer in the state of Kansas. No work shall be performed by the Contractor without such inspection nor shall any work be commenced without written authorization by City Engineering. All Construction and Materials shall comply with the current City of Wichita Specifications and Standards and Special Provisions (on file and available at Wichita.gov).
An approved copy of these plans signed by City staff are required on-site.



August 14, 2023
BAUGHMAN COMPANY
315 Ellis St. Wichita, KS 67211 316-262-7271
BaughmanCo.com

E:\Projects\USD 259 Robinson Middle School Addition (22-12-E-07)\Engineering\Phase 1\PPD\PPD.dwg

BENCHMARKS:

BM #1: "□" chiseled on top of curb, north side of 2nd Street between Oliver & Glendale. Elevation = 1357.12 (NAVD 88)

BM #2: "□" chiseled on top of curb, north side of 2nd Street between Glendale and Bleckley. Elevation = 1354.99 (NAVD 88)

BM #3: "□" chiseled on top of south end of wall, near southeast corner of entry to dumpster area. Elevation = 1358.52 (NAVD 88)

AS BUILTS



KEMILLER
ENGINEERING PA

117 E. Lewis,
Wichita, KS 67202 (316)264-0242

saw manhole and RCP pipe removed and put in 12" sdr-35 pipe grouted new pipe in existing manhole. Used Northern Products pipe to stub out.

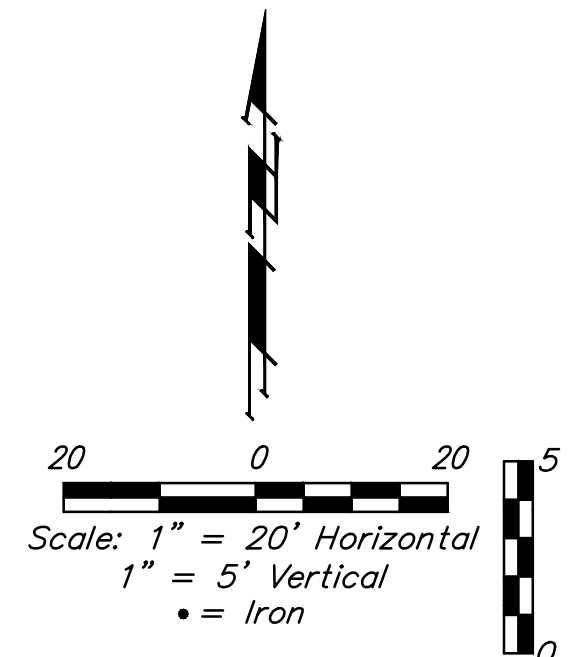
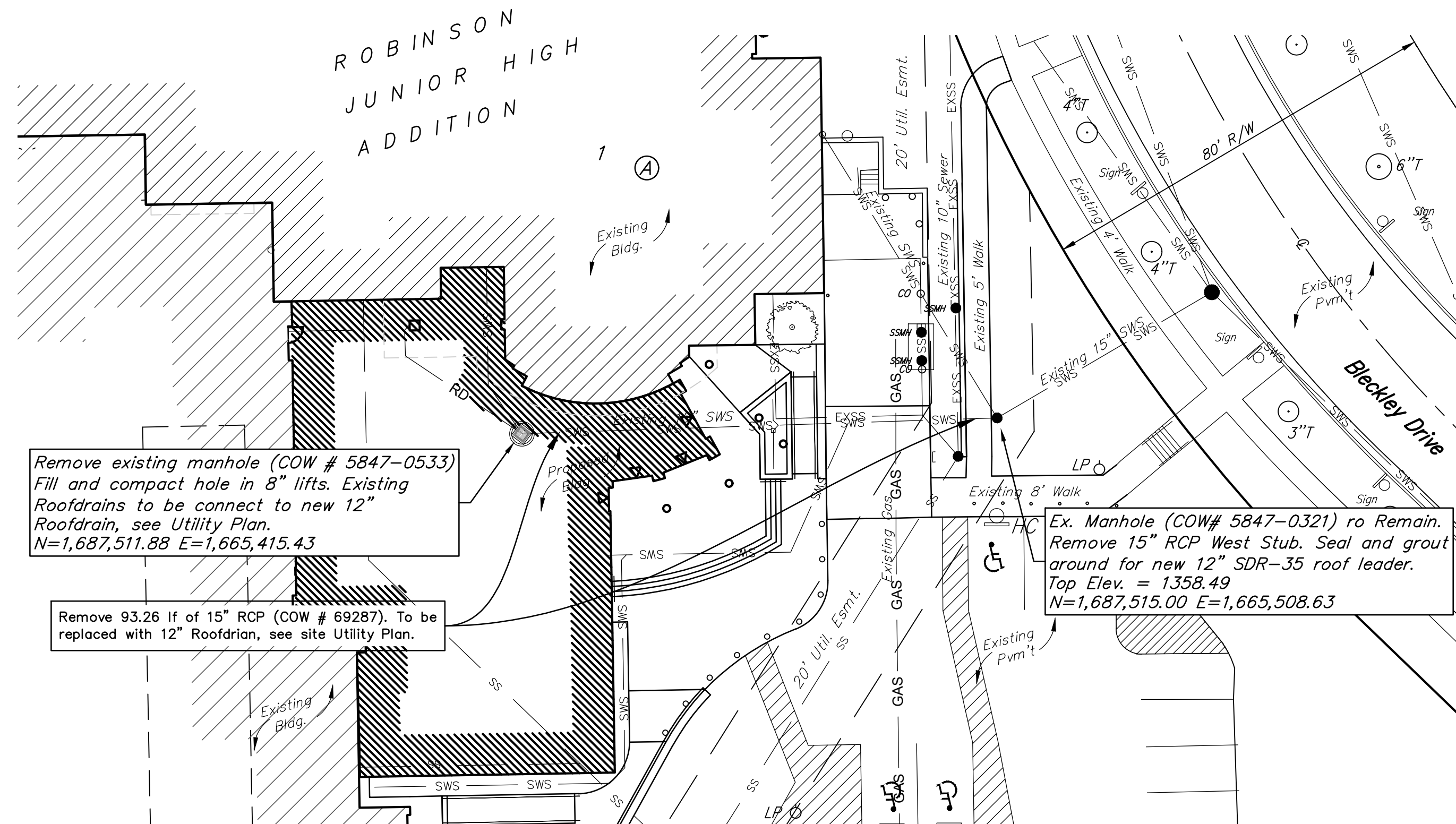

Contractor to verify depth and location of existing utilities. Contractor to relocate any existing utilities as necessary for construction.

Saw cut, remove and replace existing pavement/sidewalk on private property with permanent replacement as necessary for SWS construction.

Contact utility companies 3 weeks prior to construction to coordinate temporary removal/replacement.
Heide Bryan, Evergy, (316) 261-6354
Shannon Brinkmeyer, AT&T (316) 268-2931
Travis Taylor, Cox Comm., Travis.taylor@cox.com

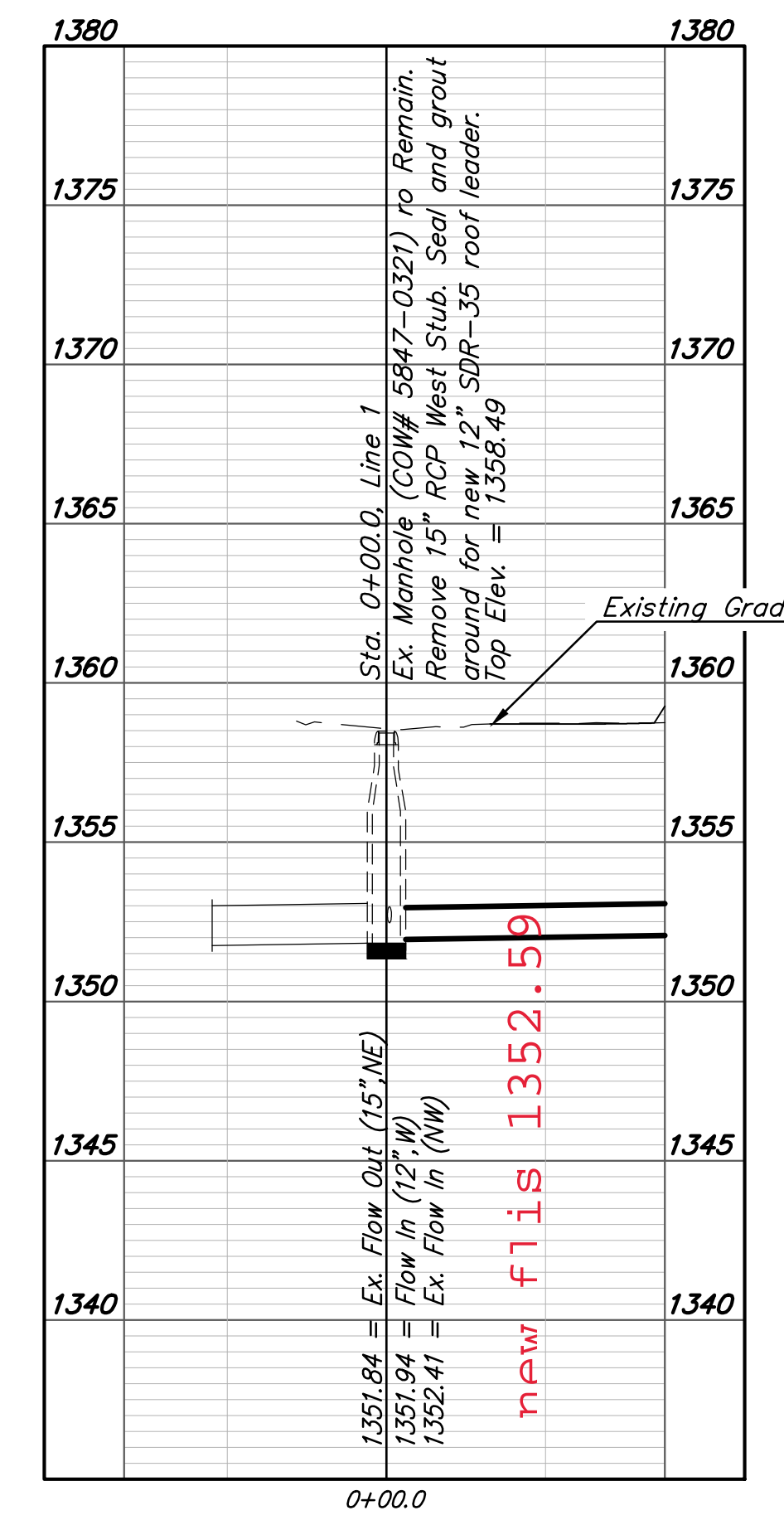



BAUGHMAN COMPANY

315 Ellis St.
Wichita, KS 67211
316-262-7271
BaughmanCo.com

USD 259 ROBINSON MIDDLE SCHOOL

LINE 1

STORM WATER SEWER IMPROVEMENTS

PROJECT NUMBER:
22-12-E407

DESIGN: AH DRAWN: TMS

DATE: August 7, 2023

SHEET **2** OF **9**

ROBINSON JUNIOR HIGH ADDITION TO WICHITA, SEDGWICK COUNTY, KANSAS

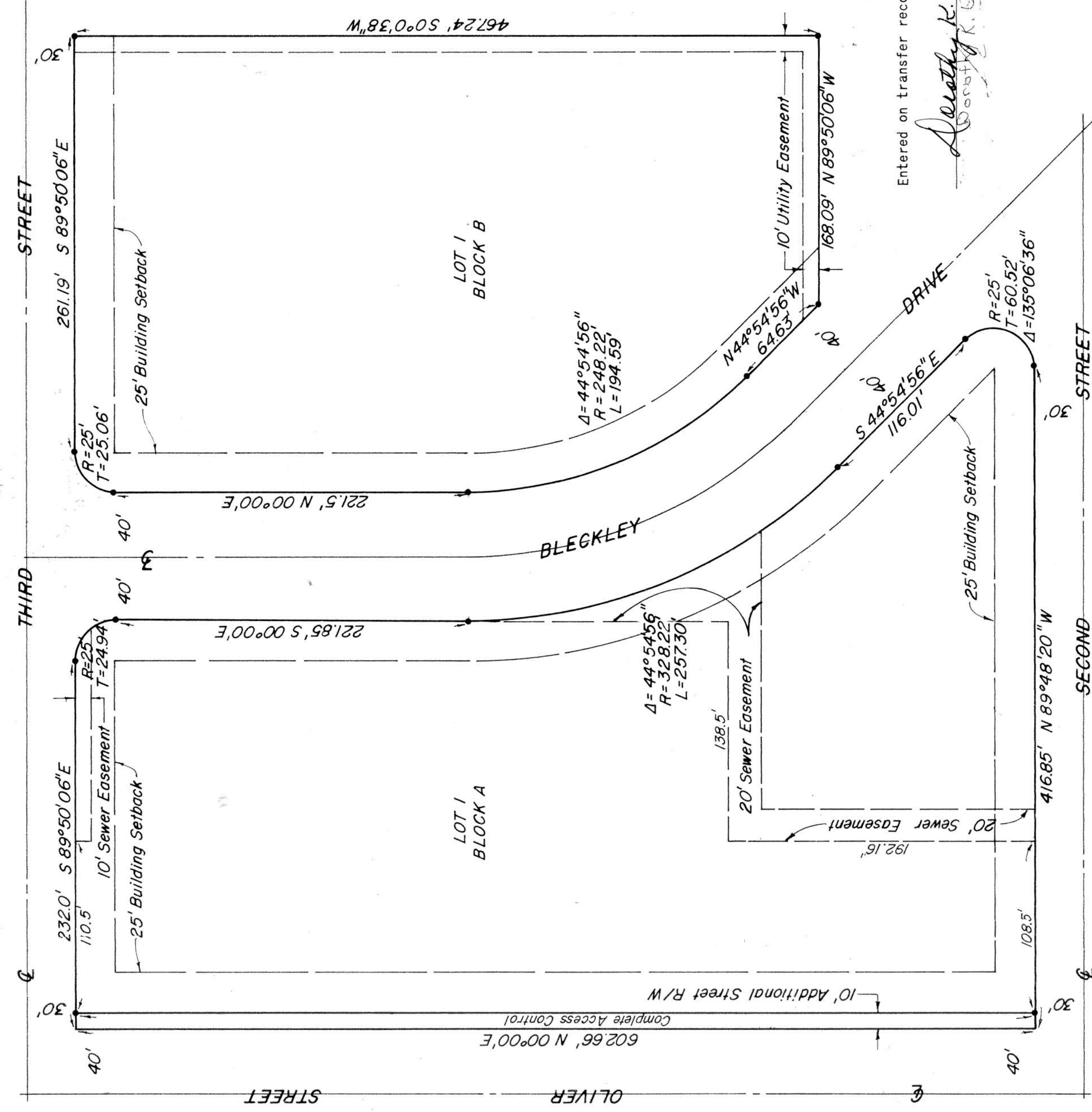

F 2-24

N
1"=60'
•=Iron

Minimum Building Flood Elevation
174.00 (City of Wichita Datum)

STATE OF KANSAS, COUNTY OF SEDGWICK, SS:

I, Don C. Moehring II, a Civil Engineer in said State and County, do hereby certify that I have surveyed and platted "ROBINSON JUNIOR HIGH ADDITION" to Wichita, Sedgwick County, Kansas, into Lots, Blocks, and a Street, the same being accurately set forth on the accompanying plat and described as follows: A Replat of Lots 1-4, Block 5, and Blocks 3, 4, and 10, East Boulevard Addition to Wichita, Kansas; and Reinhardt Place and that part of Glendale Boulevard lying North of Second Street and South of Linden Place (now Bleckley Drive), as platted in said East Boulevard Addition; said part of Glendale Boulevard and Reinhardt Place are hereby vacated by virtue of KSA 1970 Supp. 12-512(b).

Don C. Moehring II
Consulting Engineer

Know all men by these presents that we the undersigned, property owners of the land as above set forth in the undersigned, property owners have caused the same to be surveyed and platted into Lots, Blocks, and a Street, the same to be known as "ROBINSON JUNIOR HIGH ADDITION" to Wichita, Sedgwick County, Kansas. Easements for the construction and maintenance of public utilities, as indicated on the accompanying plat, are hereby granted. The Street is hereby dedicated to and for the use of the public. All abutter's rights of access to and from Oliver Street, over and across the West line of Block A, are hereby granted to the City of Wichita.

Unified School District No. 259 (Wichita), Sedgwick County, Kansas.

Daniel R. Glickman, President
Martin Hartley, Clerk



STATE OF KANSAS, COUNTY OF SEDGWICK, SS:

Be it remembered that on this 8th day of June, 1976, before me, a Notary Public in and for said State and County, came Unified School District No. 259 (Wichita), Sedgwick County, Kansas, by Daniel R. Glickman, President, and Martin Hartley, Clerk, to me personally known to be the same persons who executed the foregoing instrument of writing and duly acknowledged the execution of the same. In testimony whereof I have hereunto set my hand and affixed my notarial seal the day and year above written.

Charlotte Buskmaster
Charlotte Buskmaster
Notary Public
My Commission expires April 16, 1977

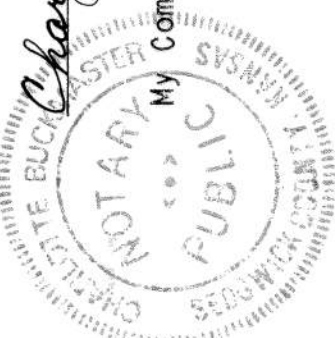

20.00

Entered on transfer record this 13 day of April, 1976.

Deborah K. White
County Clerk

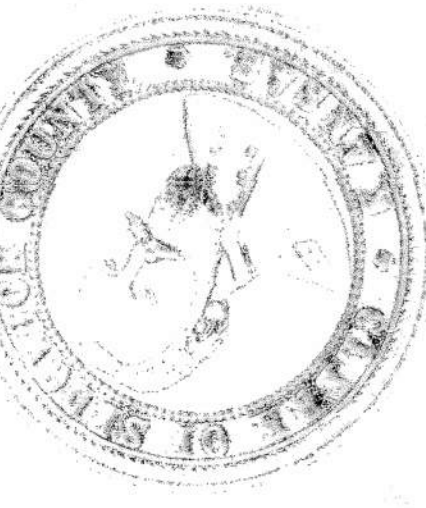

This plat of "ROBINSON JUNIOR HIGH ADDITION" has been submitted to and approved by the Wichita-Sedgwick County Metropolitan Area Planning Commission dated this 8th day of January, 1976.

Wichita-Sedgwick County Metropolitan Area Planning Commission
David Bayouth, Chairman
Robert A. Lakin, Secretary

This plat has been approved and all dedications shown hereon, if any, accepted by the Board of County Commissioners of Sedgwick County, Kansas, this 15th day of April, 1978.

Tony Cosado, Mayor
Donald C. Gisick, City Clerk

This plat has been approved and all dedications shown hereon, if any, accepted by the Board of County Commissioners of Sedgwick County, Kansas, this 15th day of April, 1978.

Everett Patrick, Chairman
Tom Scott, Commissioner
John Hale, Commissioner

Attest: Deborah K. White
County Clerk

STATE OF KANSAS, COUNTY OF SEDGWICK, SS:

This is to certify that this instrument was filed for record in the Register of Deeds Office at 2:00 PM on the 14th day of April, 1978.

Bette F. McCort, Register of Deeds
Pat Kettler, Deputy

#379546

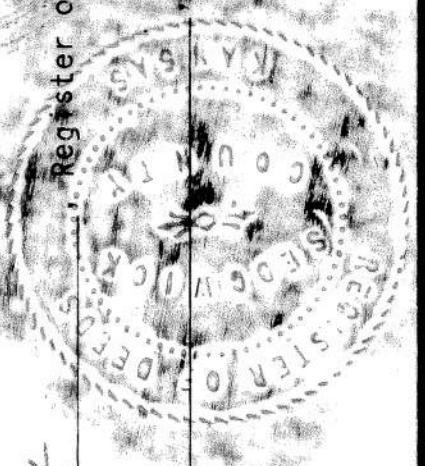
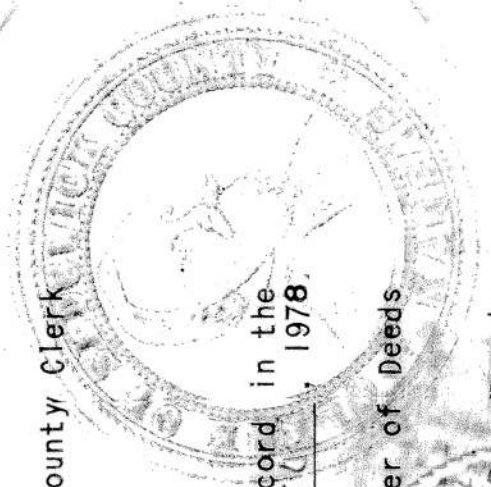



BAUGHMAN COMPANY

315 Ellis St.
Wichita, KS 67211
316-262-7271
BaughmanCo.com

COPY OF PLAT

STORM WATER SEWER IMPROVEMENTS

PROJECT NUMBER:
22-12-E407

DESIGN: DRAWN:
DATE: August 7, 2023

SHEET 9 OF 9