

Note: For Detour Signage See Detour Detail This Sheet

Note: For Detour Signage See Detour Detail Next Sheet

Note: No more than 2 Adjacent Side roads on the south side of Douglas are to be closed at the same time.

The Contractor May Temporarily Pave Portions of the Project to Carry Traffic Across the RCBC Trench at Side Streets Along Douglas and at the Intersections of Douglas & Hydraulic and Douglas & Wabash. The pavement shall be 5" Hot Mix A.C. Pavement. See Table on this Sheet for Quantities.

LEGEND

- Work Area
- Reflectorized Drum (40' Spacing)
- Tubular Marker (60' Spacing)
- Type III Barricade
- Traffic Flow Pattern

| 5" TEMPORARY A.C. PAVEMENT INTERSECTION | AREA |
|---|------------------|
| Douglas & Minneapolis | 115 S.Y. |
| Douglas & Hydraulic | 285 S.Y. |
| Douglas & Ellis | 95 S.Y. |
| Douglas & Pattie | 80 S.Y. |
| Douglas & Laura | 80 S.Y. |
| Douglas & Wabash | 265 S.Y. |
| 1st & Wabash | 335 S.Y. |
| 1st & Washington | 110 S.Y. |
| 1st & Mosley | 180 S.Y. |
| 1st & Rock Island | 180 S.Y. |
| 1st & Mead | 80 S.Y. |
| TOTAL | 1805 S.Y. |

Cost to be *INCIDENTAL* to the Measured Quantity Bid Item "Hot Mix Temporary A.C. Pavement (5")"

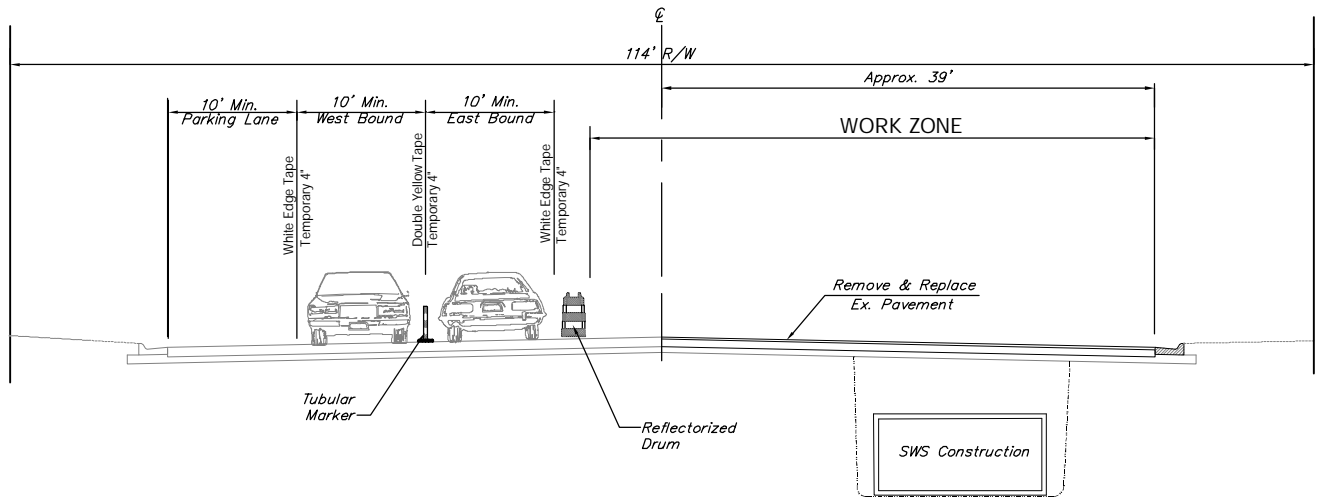

LANE LAYOUT (Looking East)

Install SWS & Reconstruct Roadway – South Side Douglas, Wabash Ave. to Hydraulic Ave.

Traffic Control is to move with Construction. Traffic Control is to extend beyond actual Construction as Required, but at least 1/2 block each way. Tapers are to move along with Construction. Close side roads and supply necessary signs as the Construction moves.

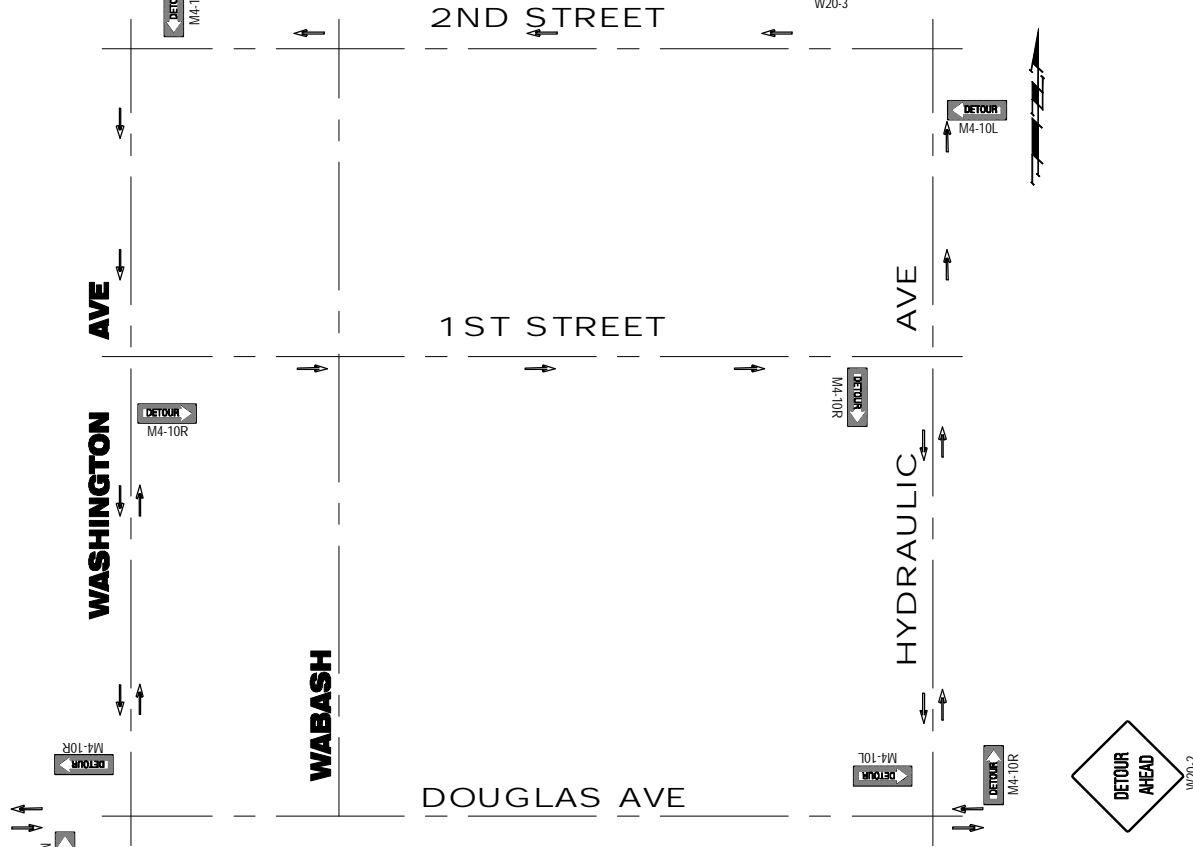

Douglas Ave. @ Wabash Detour

While Installing SWS Across Douglas Ave. at Wabash and Replacing the Pavement at this location, the Traffic on Douglas is to Detour as follows: East Bound Traffic is to Detour North on Washington Ave. to 1st Street, East on 1st Street to Hydraulic Ave., and South on Hydraulic Ave., West Bound Traffic is to Detour North on Hydraulic Ave. to 2nd Street, West on 2nd Street to Washington Ave., and South on Washington Ave..

Drawing File: E:\en\Old Town Drainage\Traffic\Con Seq 02.dwg
 Design: KK
 Date: TCA
 Approvers: TPV
 Scale: NONE

Project No. 05-05-E258 CITY OF WICHITA, KANSAS
CONSTRUCTION SEQUENCING & TRAFFIC CONTROL PLAN
 DOUGLAS AVENUE DRAINAGE OUTFALL PROJECT

Baughman Company, P.A.
 315 Ellis St. Wichita, KS 67211 P 316-262-7271 F 316-262-0149
 ENGINEERING | SURVEYING | PLANNING | LANDSCAPE ARCHITECTURE