

PLAN	CHECKED	CHECKED
BY		
DATE		

PROFILE	CHECKED	CHECKED
BY		
DATE		

DSNR: OPER: TLB SCALE: 1=20.00  
 C:\2003\03085\001\Final\PPS\SWSupp03 07-01-2005 04:53:39 pm

N-1,697,246.9721, E-1,661,812.9682  
 SWSL 3, Sta. 0+39.7  
 Const. SWS MH 3  
 Standard MH

CAUTION !!!  
 Buried Electric

N-1,697,267.1049, E-1,661,798.7314  
 SWSL 3, Sta. 0+64.4  
 Const. Area Inlet  
 See sheet no. 10 for details

CAUTION !!!  
 Existing 1 1/4" Waterline

CAUTION !!!  
 High Pressure Steam\*\*  
 Condensate Return\*\*  
 Chilled Water Return\*\*  
 Chilled Water Supply\*\*

N-1,697,296.2527, E-1,661,791.6317  
 SWSL 3, Sta. 0+94.4  
 Const. Area Inlet  
 See sheet no. 10 for details

N-1,697,296.2527, E-1,661,770.6317  
 SWSL 3, Sta. 1+15.4  
 Const. Area Inlet  
 See sheet no. 10 for details

N-1,697,246.9897, E-1,661,852.6917  
 SWSL 3, Sta. 0+00.0\*  
 Core existing concrete wall and  
 Install New 12" Pipe. Seal new 12"  
 Pipe with an approved waterstop  
 gasket and non-shrink grout.  
 Construct a minimum of  
 3' Reinforced Concrete Encasement  
 from wall. Reshape floor to provide  
 smooth flow. This work shall be  
 considered subsidiary to the price  
 bid for pipe in place.  
 Remove & Replace Existing Storm  
 Water Sewer MH top in accordance  
 with City of Wichita Requirements.  
 Existing Top Elev. = 213.04  
 Proposed Top Elev. = 214.18  
 Total Adjustment required = 1.14'  
 See details sheet 7 & 8  
 (Sheet C3.0 & C3.1 Arch. Plans)

\* PRIOR TO BEGINNING CONSTRUCTION, THE CONTRACTOR SHALL EXCAVATE THE EXISTING 12" PIPE AT STORM WATER SEWER STATION 0+00.0 TO VERIFY ITS HORIZONTAL AND VERTICAL LOCATION. THE PIPE LOCATION SHALL BE REPORTED TO THE ENGINEER SO THAT ANY NECESSARY PLAN MODIFICATIONS CAN BE MADE. ANY ADDITIONAL LABOR OR MATERIALS NECESSARY TO COMPLETE THE CONNECTION SHALL BE CONSIDERED SUBSIDIARY TO THE PROJECT.

\*\* PRIOR TO BEGINNING CONSTRUCTION OF STORM WATER SEWER LINE NO. 3, THE CONTRACTOR SHALL EXCAVATE THE EXISTING UTILITIES TO VERIFY HORIZONTAL AND VERTICAL LOCATION. THE CONTRACTOR SHALL REPORT HIS FINDINGS TO THE ENGINEER SO THAT ANY NECESSARY PLAN MODIFICATIONS MAY BE MADE. ANY ADDITIONAL LABOR OR MATERIALS NECESSARY TO COMPLETE THE CONNECTION SHALL BE CONSIDERED SUBSIDIARY TO THE PROJECT.

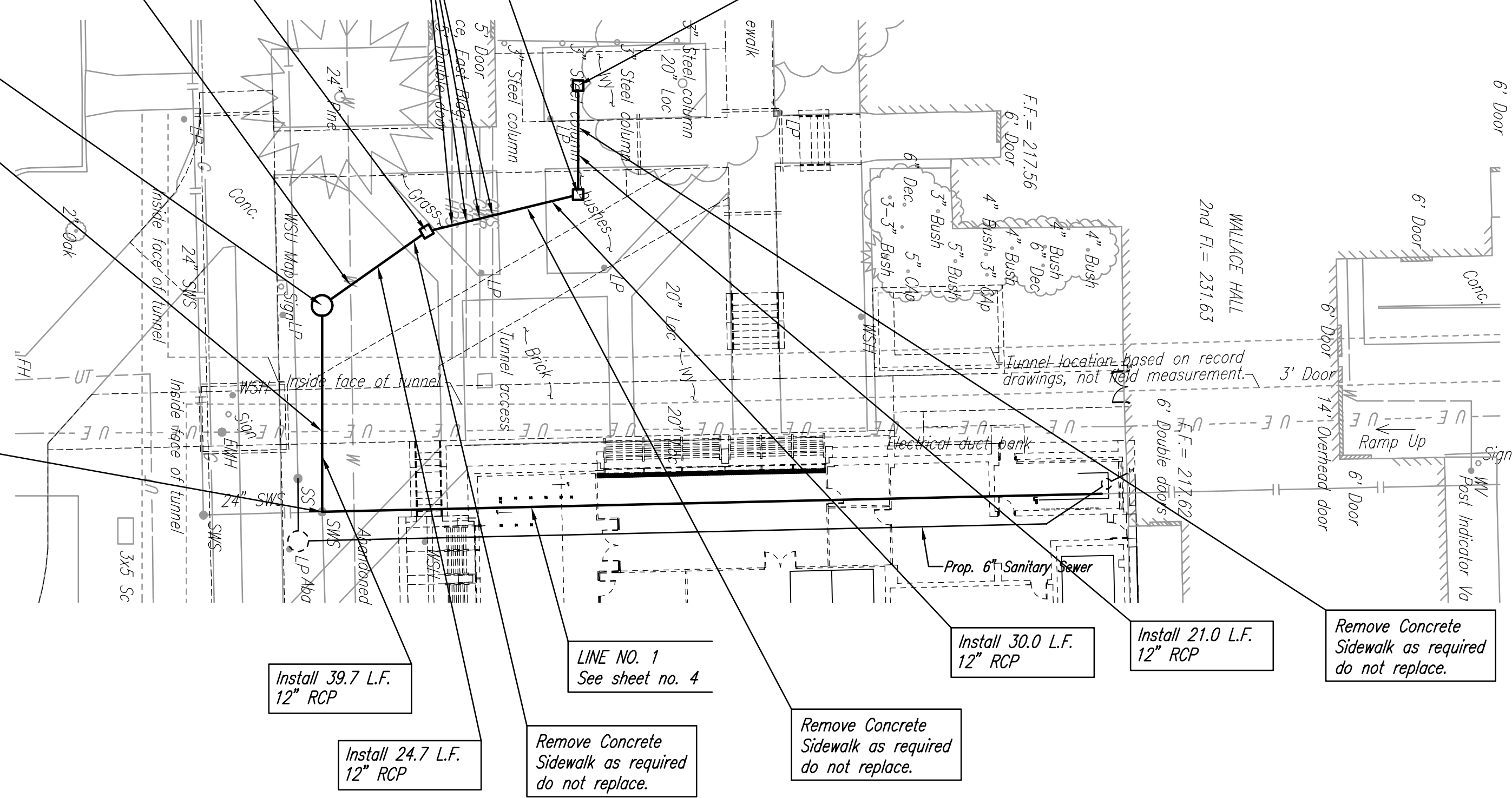

Install 39.7 L.F. 12" RCP

LINE NO. 1  
 See sheet no. 4

Install 30.0 L.F. 12" RCP

Install 21.0 L.F. 12" RCP

Remove Concrete Sidewalk as required do not replace.

Install 24.7 L.F. 12" RCP

Remove Concrete Sidewalk as required do not replace.

Remove Concrete Sidewalk as required do not replace.

STORM WATER SEWER LINE NO. 3

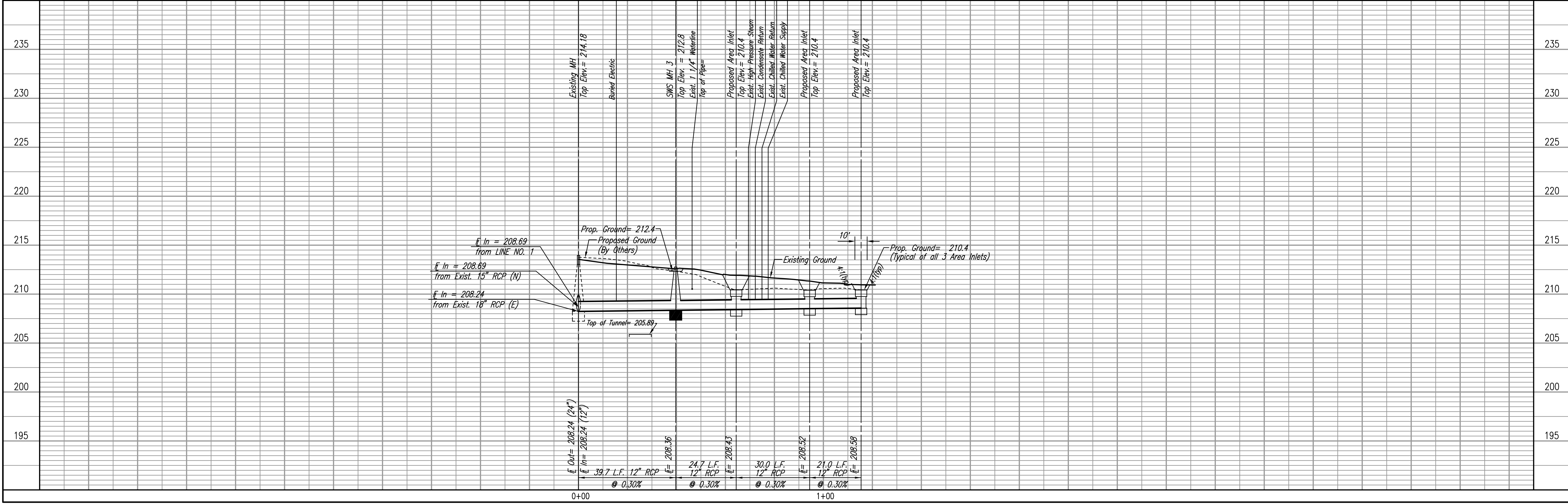

Existing MH  
 Top Elev. = 214.18

Buried Electric

SWS MH 3  
 Top Elev. = 212.8

Proposed Area Inlet  
 Top Elev. = 210.4

Prop. High Pressure Steam  
 Exist. Condensate Return  
 Exist. Chilled Water Return  
 Exist. Chilled Water Supply

Proposed Area Inlet  
 Top Elev. = 210.4

Proposed Area Inlet  
 Top Elev. = 210.4

f In = 208.69  
 from Exist. 15" RCP (N)

f In = 208.24  
 from Exist. 18" RCP (E)

Prop. Ground = 212.4  
 Proposed Ground (By Others)

Existing Ground

Prop. Ground = 210.4  
 (Typical of all 3 Area Inlets)

f In = 208.24 (24")  
 f In = 208.24 (12")

39.7 L.F. 12" RCP @ 0.30%

24.7 L.F. 12" RCP @ 0.30%

30.0 L.F. 12" RCP @ 0.30%

21.0 L.F. 12" RCP @ 0.30%

0+00

1+00

WICHITA STATE UNIVERSITY - ENGINEERING COMPLEX  
**STORM WATER SEWER LINE NO. 3**  
 JAMES L. ARMOUR, P.E. - CITY ENGINEER  
 CITY OF WICHITA PRIVATE PROJECT NO. 1520 PPS (607861)

Professional Engineering Consultants, P.A.  
 803 S. TOPICKA AVENUE, WICHITA, KANSAS 67202  
 316-262-2691 • FAX 316-262-3008  
 Job No. 35-03085-001-2474  
 Date December 2004  
 Designed By RRY/MLA  
 Drawn By JCA